

The Ohio Public Service Co.
700 6-428-4

Ohio Edison Co.
13.898 A

700

40
275
141.75
60
AVE.

60 WILER AVE. 60'

40	135	26 (19467)	135	27 (19468)	40	128	87 (19499)
		25 (19466)		28 (19469)			86 (19498)
		24 (19465)		29 (19470)		253	85 (19497)
		23 (19464)		30 (19471)			84 (19496)
		22 (19463)		31 (19472)		88	83 (19495)
		21 (19462)		32 (19473)		126	82 (19494)
		20 (19461)		33 (19474)			81 (19493)
		19 (19460)		34 (19475)			80 (19492)
		18 (19459)		35 (19476)			79 (19491)
		17 (19458)		36 (19477)			78 (19490)
		16 (19457)		37 (19478)			77 (19489)
		15 (19456)		38 (19479)			76 (19488)
		14 (19455)		39 (19480)			75 (19487)
		13 (19454)		40 (19481)			74 (19486)
		12 (19453)		41 (19482)			73 (19485)
		11 (19452)		42 (19483)			72 (19484)
40	90	45	135		40	128	100 (19512)

50 ST.

50 AVE.

600.23

R. Stander
E. G. Lowery

11.674 A
map 28

ORD 917/309

40	254	(19522)	125
	154	(19518)	
	153	(19517)	
	152	(19516)	
	151	(19515)	
	150	(19514)	
	149	(19513)	

40	255	(19523)	125
	155	(19519)	
	156	(19520)	

VINE ST. 60'

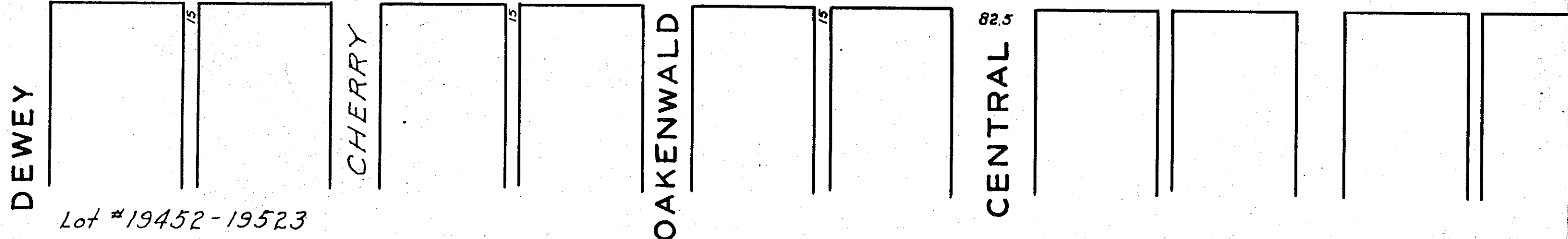

This part of Bell Heights taken into City
Vol. 16 Page 1

BELL HEIGHTS
SE 1/4 Sec. 15, Madison Twp.
Vol. 7, P. 31

MADISON
ALLOTMENTS

BOOK 5