

Pt. 7
State of Ohio

CITY OF MANSFIELD

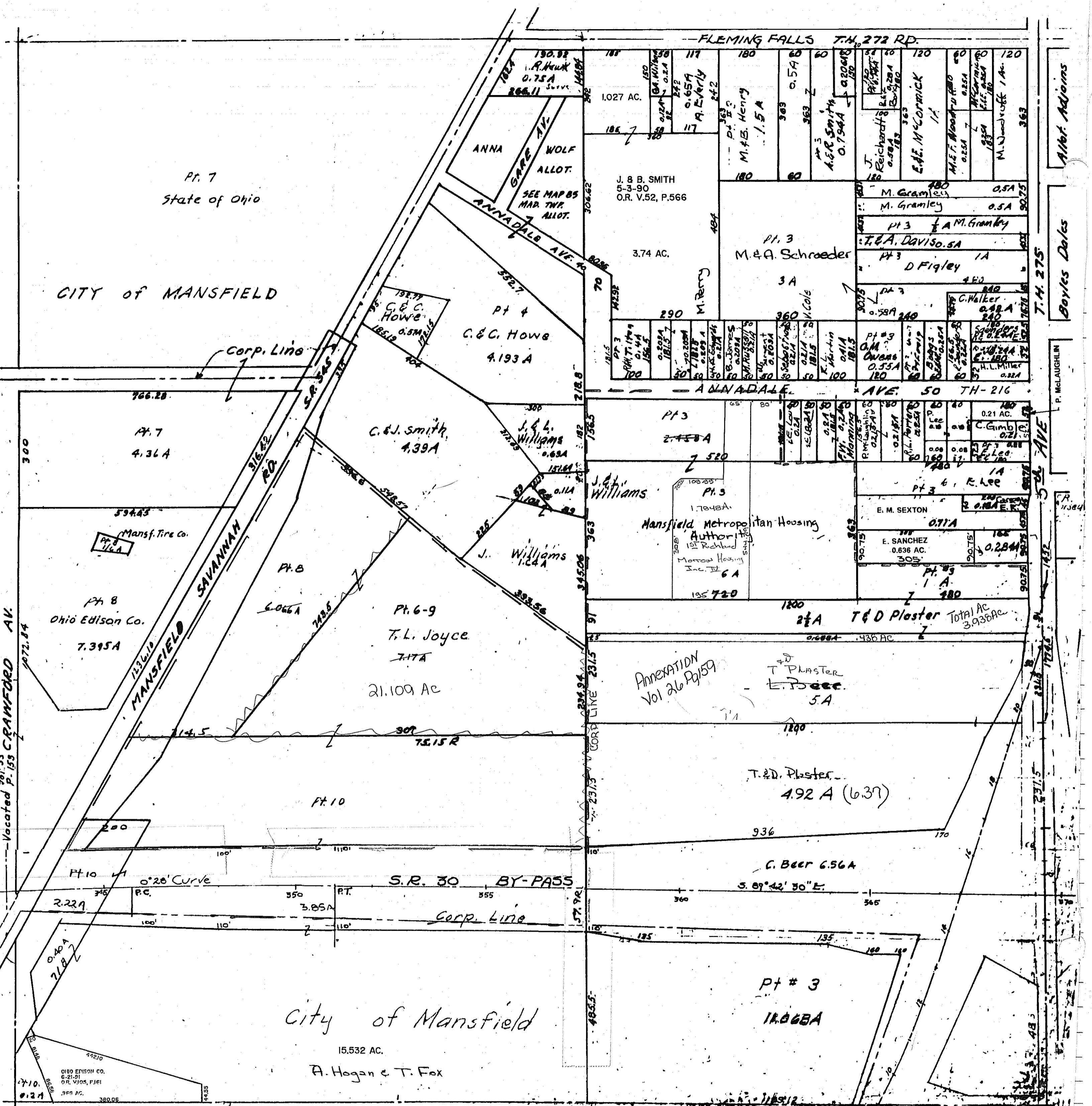

Alford Adams

Boyles Dales

P. McLaughlin

T.H. 275

5th AVE

1st St

2nd St

3rd St

4th St

5th St

6th St

Scale 1" = 330' = 165' TWP 21, R. 18 Corp. Line

5/88

MADISON TWP
C.N. 14 SEC. 15

573-90