

PART OF THE NORTHEAST
 QUARTER, SECTION 13,
 T-22 N., R-18 W.,
 WELLER TOWNSHIP, RICHLAND
 COUNTY, OHIO

Approved Weller
 Township
Edmund J. Weller
 10 Aug 08

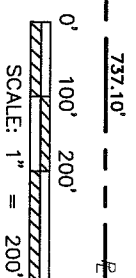

NEW SPLIT
 RICHLAND COUNTY
 TAX MAP OFFICE
 INITIAL: MB DATE: 8-12-08

NEW SURVEY
 OF EXISTING PARCEL
 RICHLAND COUNTY
 TAX MAP OFFICE
 INITIAL: MB DATE: 8-12-08

- LEGEND**
- ☒ STONE FOUND
 - △ RAILROAD SPIKE FOUND
 - IRON PIN FOUND
 - 5/8" REBAR SET WITH I.D. CAP MARKED "S.L. INC"



Distances shown hereon are expressed in feet and decimal parts thereof.
 Bearings are to an assumed meridian and are used to express angles only.

CERTIFICATION: I hereby certify that the foregoing survey was prepared from actual field measurements, in accordance with Chapter 4733-37, Ohio Administration Code.

By: Roger L. Stevens 8-6-08
 Roger L. Stevens, P.S. #7052 Date

SHAFER, JOHNSTON, LICHTENWALTER & ASSOCIATES, INC.
 Consulting Engineers & Surveyors
 909 South Main Street • P.O. Box 3598
 Mansfield, Ohio 44907
 TEL (419) 756-7202 FAX (419) 756-0867 EMAIL sj@sj-hc.com

SURVEY MADE AT THE REQUEST OF:

RUDYS CUSTOM BUTCHERING
 4630 MANSFIELD ADARIO RD.
 MANSFIELD, OH 44903

SM-1903

**SHAFFER, JOHNSTON, LICHTENWALTER
& ASSOCIATES, INC.
ENGINEERS & SURVEYORS**

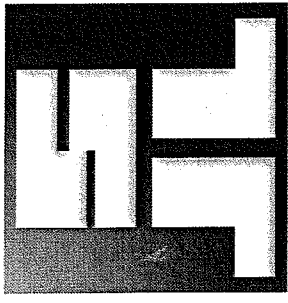

August 4, 2008

**SURVEYOR'S DESCRIPTION FOR
RUDYS CUSTOM BUTCHERING**

LOT 1

Situated in the Township of Weller, County of Richland, State of Ohio and being a part of the Northeast Quarter of section 13, Township 22 North, Range 18 West, and being more particularly described as follows:

Beginning at a railroad spike found in the intersection of the south line of said Northeast Quarter and the centerline of Mansfield Adario Road (Township Highway 242);

Thence with the following **FOUR** courses:

1. **N 00° 14' 05" W, 200.00 feet** along said centerline of Mansfield Adario Road to a point;
2. **N 89° 53' 55" E, 600.00 feet** to an iron pin set and passing through an iron pin set at 30.00 feet;
3. **S 00° 14' 05" E, 200.00 feet** to an iron pin set in the south line of said Northeast Quarter;
4. **S 89° 53' 55" W, 600.00 feet** along said south line of said Northeast Quarter to the **place of beginning**, passing through an iron pin set at 570.00 feet and containing **2.755 acres**, more or less, and subject to all legal highways and easements of record.

Bearings are to an assumed meridian and are used to express angles only.

According to a survey made in August 2008 by Roger L. Stevens, Ohio Registered Surveyor No. 7052.

All iron pins set are 5/8" diameter rod with plastic cap stamped "SJL, INC".



Roger L. Stevens
Registered Surveyor No. 7052
SM-1903

NEW SPLIT
RICHLAND COUNTY
TAX MAP OFFICE



LOT 2

Situated in the Township of Weller, County of Richland, Sate of Ohio and being a part of the Northeast Quarter of section 13, Township 22 North, Range 18 West, and being more particularly described as follows:

Commencing at a railroad spike found in the intersection of the south line of said Northeast Quarter and the centerline of Mansfield Adario Road (Township Highway 242);

Thence N 00° 14' 05" W, 200.00 feet along said centerline of Mansfield Adario Road to a point, said point being referenced by an iron pin set N 89° 53' 55" E, 30.00 feet from said point and being the **true place of beginning**;

Thence with the following **FOUR** courses:

1. **N 00° 14' 05" W, 200.00 feet** and continuing along said centerline of Mansfield Adario Road to a point;
2. **N 89° 53' 55" E, 600.00 feet** to an iron pin set and passing through an iron pin set at 30.00 feet;
3. **S 00° 14' 05" E, 200.00 feet** to an iron pin set;
4. **S 89° 53' 55" W, 600.00 feet to the true place of beginning** and containing **2.755 acres**, more or less, and subject to all legal highways and easements of record.

Bearings are to an assumed meridian and are used to express angles only.

According to a survey made in August 2008 by Roger L. Stevens, Ohio Registered Surveyor No. 7052.

All iron pins set are 5/8" diameter rod with plastic cap stamped "SJL, INC".

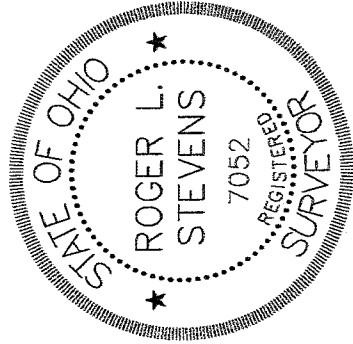

Roger L. Stevens
Roger L. Stevens
Registered Surveyor No. 7052
SM-1903

NEW SPLIT
RICHLAND COUNTY
TAX MAP OFFICE

RLS
INITIAL DATA

LOT 3

Situated in the Township of Weller, County of Richland, State of Ohio and being a part of the Northeast Quarter of section 13, Township 22 North, Range 18 West, and being more particularly described as follows:

Beginning at a stone found in the southeast corner of said ^{North} _{east} Quarter;

Thence with the following **TEN** courses:

1. **S 89° 53' 55" W, 737.10 feet** along the south line of said Northeast Quarter to an iron pin set;
2. **N 00° 14' 05" W, 400.00 feet** to an iron pin set;
3. **S 89° 53' 55" W, 600.00 feet** to a point being in the centerline of Mansfield Adario Road (Township Highway 242) and passing through an iron pin set at 570.00 feet;
4. **N 00° 14' 05" W, 200.00 feet** along said centerline of Mansfield Adario Road to a point;
5. **N 89° 53' 55" E, 600.00 feet** to an iron pin set and passing through an iron pin set at 30.00 feet;
6. **N 00° 14' 05" W, 200.00 feet** to an iron pin set;
7. **S 89° 53' 55" W, 600.00 feet** to a point being in the centerline of Mansfield Adario Road (Township Highway 242) and passing through an iron pin set at 580.00 feet;
8. **N 00° 14' 05" W, 200.00 feet** along said centerline of Mansfield Adario Road to a point;
9. **N 89° 53' 55" E, 1,335.31 feet** to an iron pin set in the east line of said Northeast Quarter and passing through an iron pin set at 30.00 feet;
10. **S 00° 20' 15" E, 1,000.00 feet** along said east line of said Northeast Quarter to the **place of beginning**, and containing **22.410 acres**, more or less, and subject to all legal highways and easements of record.

Bearings are to an assumed meridian and are used to express angles only.

According to a survey made in August 2008 by Roger L. Stevens, Ohio Registered Surveyor No. 7052.

All iron pins set are 5/8" diameter rod with plastic cap stamped "SJL, INC".



Roger L. Stevens
Roger L. Stevens
Registered Surveyor No. 7052
SM-1903

NEW SPLIT
RICHLAND COUNTY
TAX MAP OFFICE
mlb 8/2/08
INITIAL DATE

LOT 4

Situated in the Township of Weller, County of Richland, Sate of Ohio and being a part of the Northeast Quarter of section 13, Township 22 North, Range 18 West, and being more particularly described as follows:

Commencing at a railroad spike found in the intersection of the south line of said Northeast Quarter and the centerline of Mansfield Adario Road (Township Highway 242);

Thence N 00° 14' 05" W, 600.00 feet along said centerline of Mansfield Adario Road to a point, said point being referenced by an iron pin set N 89° 53' 55" E, 30.00 feet from said point and being the **true place of beginning**;

Thence with the following **FOUR** courses:

1. **N 00° 14' 05" W, 200.00 feet** and continuing along said centerline of Mansfield Adario Road to a point;
2. **N 89° 53' 55" E, 600.00 feet** to an iron pin set and passing through an iron pin set at 20.00 feet;
3. **S 00° 14' 05" E, 200.00 feet** to an iron pin set;
4. **S 89° 53' 55" W, 600.00 feet to the true place of beginning** and containing **2.755 acres**, more or less, and subject to all legal highways and easements of record.

Bearings are to an assumed meridian and are used to express angles only.

According to a survey made in August 2008 by Roger L. Stevens, Ohio Registered Surveyor No. 7052.

All iron pins set are 5/8" diameter rod with plastic cap stamped "SJL, INC".



Roger L. Stevens
Roger L. Stevens
Registered Surveyor No. 7052
SM-1903

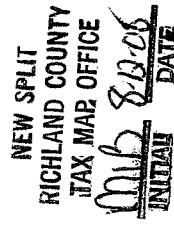

LOT 5

Situated in the Township of Weller, County of Richland, State of Ohio and being a part of the Northeast Quarter of section 13, Township 22 North, Range 18 West, and being more particularly described as follows:

Commencing at a railroad spike found in the intersection of the south line of said Northeast Quarter and the centerline of Mansfield Adario Road (Township Highway 242);

Thence N 00° 14' 05" W, 1,000.00 feet along said centerline of Mansfield Adario Road to a point, said point being referenced by an iron pin set N 89° 53' 55" E, 30.00 feet from said point and being the **true place of beginning**;

Thence with the following **FOUR** courses:

1. **N 00° 14' 05" W, 481.18 feet** and continuing along said centerline of Mansfield Adario Road to a point;
2. **N 89° 53' 55" E, 494.32 feet** to an iron pin set and passing through an iron pin set at 30.00 feet;
3. **S 00° 14' 05" E, 481.18 feet** to an iron pin set;
4. **S 89° 53' 55" W, 494.32 feet** to the **true place of beginning** and containing **5.460** acres, more or less, and subject to all legal highways and easements of record.

Bearings are to an assumed meridian and are used to express angles only.

According to a survey made in August 2008 by Roger L. Stevens, Ohio Registered Surveyor No. 7052.

All iron pins set are 5/8" diameter rod with plastic cap stamped "SJL, INC".



Roger L. Stevens

Roger L. Stevens
Registered Surveyor No. 7052
SM-1903

NEW SPLIT
RICHLAND COUNTY
TAX MAP OFFICE
MIB 8-12-08
INITIAL DATE

LOT 6

Situated in the Township of Weller, County of Richland, Sate of Ohio and being a part of the Northeast Quarter of section 13, Township 22 North, Range 18 West, and being more particularly described as follows:

Beginning at a railroad spike found in the northeast corner of said Northeast Quarter, said railroad spike also being in Mansfield Adario road (T.H. 242);

Thence with the following **SIX** courses:

1. **S 00° 20' 15" E, 1,749.34 feet** along the east line of said Northeast Quarter to an iron pin set and passing through an iron pin set at 50.00 feet;
2. **S 89° 53' 55" W, 840.99 feet** to an iron pin set;
3. **N 00° 14' 05" W, 481.18 feet** to an iron pin set;
4. **S 89° 53' 55" W, 494.32 feet** to a point being in the centerline of Mansfield Adario Road (Township Highway 242) and passing through an iron pin set at 464.32 feet;
5. **N 00° 14' 05" W, 1,238.91 feet** along said centerline of Mansfield Adario Road to an iron pin set in the north line of said Northeast Quarter;
6. **N 88° 38' 29" E, 1,332.43 feet** along said north line of said Northeast Quarter to the **place of beginning**, and containing **47.654 acres**, more or less, and subject to all legal highways and easements of record.

Bearings are to an assumed meridian and are used to express angles only.

According to a survey made in August 2008 by Roger L. Stevens, Ohio Registered Surveyor No. 7052.

All iron pins set are 5/8" diameter rod with plastic cap stamped "SJL, INC".



Roger L. Stevens
Roger L. Stevens
Registered Surveyor No. 7052
SM-1903

NEW SURVEY
OF EXISTING PARCEL
RICHLAND COUNTY
TAX MAP OFFICE
MJB 8-12-08
INITIAL DATE

P.O. Box 3598 909 South Main Street Mansfield, Ohio 44907
Ph. (419) 756-7302 Fax (419) 756-0867 Email: rstevens@sjl-inc.com

7-304