

SOUTHEAST QUARTER
SECTION 30, T-21, R-19
SPRINGFIELD TOWNSHIP
RICHLAND COUNTY, OHIO

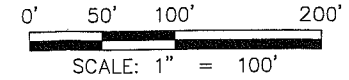
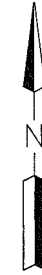

CL FLOWERS RD. (T.H. 158)
N. LINE SE. 1/4 SEC. 30

S 55°30'40" W
0.54' 40"

CL PINKNEY RD. (T.H. 428)
S 00°00'00" W 690.00'

FOREST F. & MARILYN E. FELGER
D.V.-897 P.-459

MICHAEL E. STROUP
O.R.V.-693 P.-598

JOSEPH & PHYLLIS COOPER
D.V.-865 P-511

DORIS A. DEEB
O.R.V.-154 P.-987

N 00°00'00" E
167.96'

S 88°00'17" E 1323.64'

5.100 ACRES

N 88°00'17" W
1323.34'

E. LINE SE. 1/4 SEC. 30

S 00°06'08" W
167.95'

1353.30'

FRANK MILTON & RUTH ANN WELCH
D.V.-861 P.-481

LEGEND

- IRON PIN FOUND
- 5/8" REBAR SET WITH I.D. CAP MARKED SJL INC
- △ SURVEY SPIKE FOUND
- RAILROAD SPIKE FOUND
- ⊗ MAG NAIL FOUND

Distances shown hereon are expressed in feet and decimal parts thereof.

Basis of Bearings: Survey N-333.

CERTIFICATION: I hereby certify that the foregoing survey was prepared from actual field measurements, in accordance with Chapter 4733-37, Ohio Administration Code.

By: *Roger L. Stevens*
Roger L. Stevens, P.S. #7052

NEW SPLIT
RICHLAND COUNTY
TAX MAP OFFICE

MWB 6-27-08
INITIAL DATE

William R. Scott
SPRINGFIELD TWP
ZONING

REVISION NO.	DATE



SHAFFER, JOHNSTON, LICHTENWALTER
& ASSOCIATES, INC.
Consulting Engineers & Surveyors
909 South Main Street • P.O. Box 3598
Mansfield, Ohio 44907
TEL (419) 756-7302 FAX (419) 756-0867 EMAIL sjl@sjl-inc.com

SURVEY FOR

FRANK & RUTH ANN WELCH
705 PINKNEY ROAD
MANSFIELD, OHIO 44906

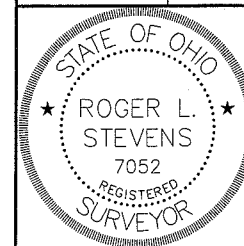

DRAWN	CHECKED	SCALE	DATE
RLS	RLS	1" = 100'	6/19/2008

DWG NO: SM-1906 JOB NO: SM-1906 SHEET 1 OF 1

2.256

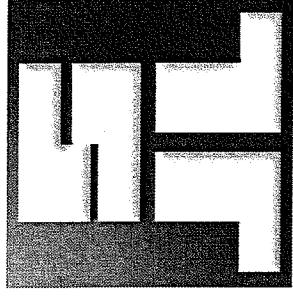

**SHAFFER, JOHNSTON, LICHTENWALTER
& ASSOCIATES, INC.
ENGINEERS & SURVEYORS**

June 19, 2008

**SURVEYOR'S DESCRIPTION FOR
FRANK & RUTH ANN WELCH**

5.100 Acres

Situated in the Township of Springfield, County of Richland, State of Ohio, being part of the Southeast Quarter of Section 30, Township 21, Range 19 and being more particularly described as follows:

Commencing at survey spike found in the intersection of the centerline of Flowers Road (T.H. 158) and the centerline of Pinkney Road (T.H. 428), said survey spike also being in the north line of said Southeast Quarter and being in the northwest corner of a parcel of land conveyed to Forest R. and Marilyn E. Felger by deed volume 897, page 459;

Thence S 00° 00' 00" W, 690.00 feet along said centerline of Pinkney Road also being along the west line of said land of Forest R. and Marilyn E. Felger to a point being the southwest corner of said land, said point being the **true place of beginning**;

Thence with the following **FOUR** courses:

1. **S 88° 00' 17" E, 1,323.64 feet** along the south line of said land of Forest R. and Marilyn E. Felger and along the south line of parcels conveyed to Michael E. Stroup by official records volume 693, page 598, Joseph and Phyllis Cooper by deed volume 865, page 511 and Doris A. Deeb by official records volume 154, page 987 to an iron pin set in the southeast corner of said land of Doris A. Deeb, said iron pin also being in the east line of said Southeast Quarter and passing through an iron pin set at 30.02 feet;
2. **S 00° 06' 08" W, 167.95 feet** along said east line of said Southeast Quarter to an iron pin set;
3. **N 88° 00' 17" W, 1,323.34 feet** to a point being in said centerline of Pinkney Road and passing through an iron pin set at 1,293.32 feet;
4. **N 00° 00' 00" E, 167.96 feet** along said centerline of Pinkney Road to the **true place of beginning** and containing **5.100 acres**, more or less, and subject to all legal highways and easements of record.

Basis of Bearings: Survey N-333.

According to a survey made in June 2008 by Roger L. Stevens, Ohio Registered Surveyor No. 7052.

All iron pins set are 5/8" diameter rod with plastic cap stamped "SJL, INC".



Roger L. Stevens
Roger L. Stevens
Registered Surveyor No. 7052
SM-1906

NEW SPLIT
RICHLAND COUNTY
TAX MAP OFFICE
MLB
INITIAL
6-27-08
DATE

Scott
Marilyn
Frank
Ruth
WELCH
2008

P.O. Box 3598 909 South Main Street Mansfield, Ohio 44907
Ph. (419) 756-7302 Fax (419) 756-0867 Email: rstevens@sjl-inc.com

7-256