

PLAT OF A SURVEY TO LOCATE AND DESCRIBE A PORTION OF A TRACT OF LAND CONVEYED TO JAMES E. & JUDITH M. BERNHARD BY DEED RECORDED IN OFFICIAL RECORDS VOLUME 0918, PAGE 0524.

N. LINE, NE 1/4, SECTION 17

IRON PIN FOUND REFERENCED BY A FENCE POST FOUND S 19°45'41" E, 0.39'

JAMES E. & JUDITH M. BERNHARD OR V-0918, P-0524

WILLIAM I. RAMSAY TRUST OR V-0848, P-0632

N 88°28'29" E  
900.00'

N 02°36'24" W 2684.97'

18.592 ACRES

S 02°36'24" E  
900.00'

SW CORNER, NE 1/4, SECTION 17

OFFSET 25.00'

OFFSET 25.00'

SE CORNER, NE 1/4, SECTION 17

S 88°28'29" W 2639.56'

S. LINE, NE 1/4, SECTION 17 & CENTER OF CRUM ROAD (CR 83)

900.00'

428.71'

CORNER TO PIN S 02°57'56" E, 25.41'

I HEREBY CERTIFY THIS PLAT TO BE A TRUE DELINEATION OF A FIELD SURVEY IN MARCH, 2008.

RONALD L. LAUGHERY REGISTERED SURVEYOR #6111



NEW SPLIT RICHLAND COUNTY TAX MAP OFFICE  
MLB 3-11-08  
INITIAL DATE



NORTH

KEY MAP

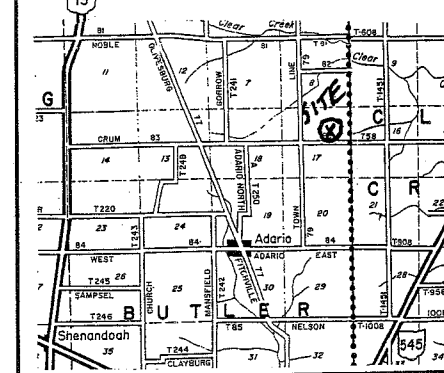

SYMBOLS

- △ = POST FOUND
  - = STONE FOUND
  - = RAILROAD SPIKE FOUND
  - = IRON PIN FOUND
  - = RAILROAD SPIKE SET
  - = 5/8" IRON PIN SET WITH CAP
  - (with stamp) = STAMPED LAUGHERY P.S. 6111
  - ⊗ = PK NAIL SET
  - = EXISTING PROPERTY LINE
  - — — = CENTER LINE
  - — — = PROPOSED OR SUBJECT LINE
  - X X X - = FENCE LINE
- T.M.P. = CURRENT TAX MAP PARCEL ID  
(R), (M), (C) = RECORD, MEASURED, CALCULATED
- BEARINGS ARE BASED ON AN ASSUMED MERIDIAN AND ARE FOR THE DETERMINATION OF ANGLES ONLY. DISTANCES ARE MEASURED UNLESS OTHERWISE STATED. ANGLES ARE IN DEG - MIN - SEC. DISTANCES ARE IN FEET



LAUGHERY, INC.  
ENGINEERING & SURVEYING  
967 US 42  
ASHLAND, OHIO 44805

NE 1/4, SECTION 17, T-25-N, R-17-W  
BUTLER TOWNSHIP  
RICHLAND COUNTY, OHIO

DRAWN BY RLL DATE 03/01/08 SCALE 1"=200'

**LAUGHERY, INC.  
ENGINEERING AND SURVEYING**

967 US 42

**ASHLAND, OHIO 44805**

NEW SPLIT  
RICHLAND COUNTY  
TAX MAP OFFICE

MLB 31.08  
INITIAL DATE

18.592 Acres

The following parcel of land Situated in the State of Ohio, the County of Richland, and the Township of Butler,

Being a portion of a parcel of land conveyed to James E. and Judith M. Bernhard by deed recorded in Official Records Volume 0918, Page 0524 and known as being a part of the northeast quarter of Section 17, T-25-North, R-17-West and being more fully described as follows:

Beginning for reference at a railroad spike found at the southeast corner of the northeast quarter of Section 17; Thence South 88°-28'-29" West, along the south line of the northeast quarter of Section 17 and the center of Crum Road (C.R. 83), a distance of 428.71 feet to a point, said point being referenced by an iron pin set North 02°-36'-24" West a distance of 25.00 feet, said point also being the true place of beginning for the parcel herein to be conveyed;

Thence South 88°-28'-29" West, along the south line of the northeast quarter of Section 17 and the center of Crum Road, a distance of 900.00 feet to a point at a southeast corner of a parcel of land conveyed to William I. Ramsay Trust by deed recorded in Official Records Volume 0848, Page 0632, said point being referenced by an iron pin set North 02°-36'-24" West a distance of 25.00 feet;

Thence North 02°-36'-24" West, along the east line of said Ramsay parcel, a distance of 900.00 feet to an iron pin set;

Thence North 88°-28'-29" East a distance of 900.00 feet an iron pin set;

Thence South 02°-36'-24" East a distance of 900.00 feet to the true place of beginning.

The tract of land as surveyed contains 18.592 acres of land subject to all legal highways and easements of record. All iron pins set are 5/8 inch rebar, 30 inches long with cap stamped "Laughery- P.S. 6111".

The above description was prepared by Ronald L. Laughery, Registered Surveyor No. 6111, from notes of a field survey performed February, 2008.