

E.C. LESS THAN 1:10,000

LAKE MARIA, LLC
ORV-1170, PG-260

N 78° 10' 12" E 138.92' (M)

SEE DETAIL 1

WEST LINE, SW 1/4 AND WEST LINE SECTION 21

N 00° 26' 58" W 454.73'

S 00° 24' 36" E 419.23' (M)

K. GRIFFETH
ORV-73, PG-223

TOTAL AREA
1.3730 AC.

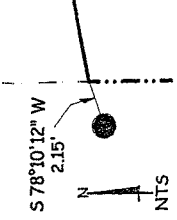

DETAIL 1

JC Consulting, LLC
P.O. Box 8601
747 South Home Road
Mansfield, Ohio 44906
(419) 529-9747

REVISED 9/26/06

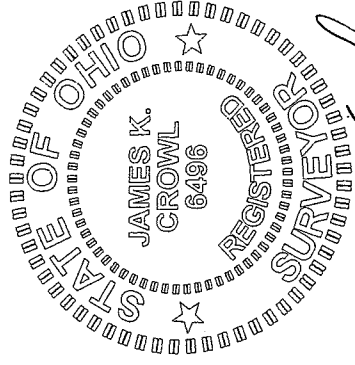

James K. Crowl

James K. Crowl
P.S. #6496



NEW SURVEY
OF EXISTING PARCEL
OF RICHLAND COUNTY
TAX MAP OFFICE
MIB INITIAL
9.27.06 DATE



NOTE - ALL BEARINGS ASSUMED FOR
PURPOSES OF THIS SURVEY.

30.00' RR SPK FND

E VANDERBILT RD. (TH-328)

30.00' RR SPK FND

SEE CURVE DATA

LEGEND

- - IRON PIN FOUND
- - IRON PIN SET W/ PLASTIC CAP "J CROWL 6496"
- ⊗ - PK NAIL FOUND
- ⊗ - PK NAIL SET

NOTE - ALL PINS MARKED SET
ARE 3/4" REBAR X 30"

CURVE DATA

DELTA = 11° 14' 58"
 RADIUS = 763.94'
 ARC = 149.99'
 CHD = 149.75'
 CHD BRG = S 64° 42' 42" W

Plat of survey
for
Gerald Griffeth

Part of the SW 1/4,
Section 21, Twp-20,
Rng-18, Washington
Township, Richland
County, Ohio

Sht 1/1 Sept. 18, 2006

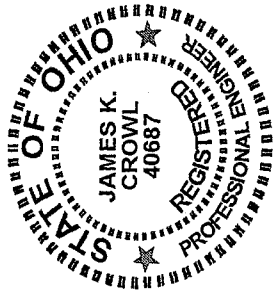

J.C. Consulting, L.L.C.
P.O. Box 8601
747 South Home Road
Mansfield, Ohio 44906
(Voice) 419-529-9747

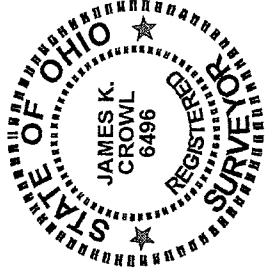

Description

Being a part of the south west Quarter of Section 21, Twp-20, Rng-18, Washington Township, Richland County, Ohio and more particularly described as follows;

Beginning at a railroad spike found on the centerline of Vanderbilt Road (TH-328) and the west line of Section 21 as referenced above, said point referenced by an iron pin set N 00° 26' 58" W at a distance of 30.00 feet;

Thence N 00° 26' 58" W along and with the west line of Section 21 as referenced above, a distance of 454.73 feet to a point, said point referenced by an iron pin found S 78° 10' 12" W at a distance of 2.15 feet;

Thence N 78° 10' 12" E a distance of 138.92 feet to an iron pin found;

Thence S 00° 24' 36" E a distance of 419.23 feet to a PK Nail set on the centerline of Vanderbilt Road (TH-328), said point referenced by an iron pin set N 00° 24' 36" W at a distance of 30.00 feet;

Thence south west along a curve to the right along and with the centerline of Vanderbilt Road (TH-328), having the following properties:

Delta = 11° 14' 58"
Radius = 763.94'
Arc = 149.99'
Chord = 149.75'
Chd Brg = S 64° 42' 42" W

To the Place of Beginning and containing 1.3730 acres, more or less, but subject to all highways and easements of record.

This description was prepared from a field survey performed by James K. Crowl, P.S. 6496, on September 18, 2006, the bearings referred to herein are based on an assumed meridian and are for purposes of angular measurement only. The iron pins set are 3/4" diameter rebar with identification caps stamped "JKC 6496".

Revised 9/26/06

NEW SURVEY
OF EXISTING PARCELS
RICHLAND COUNTY
TAX MAP OFFICE
MJC 9/27/06
INITIAL DATE

X-137