

X-125

# SURVEY PLAT

Part Southwest Quarter - Section 9  
Monroe Township, T-22, R-17  
Richland County, Ohio

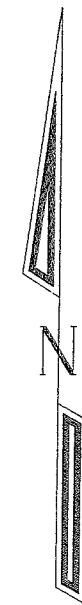
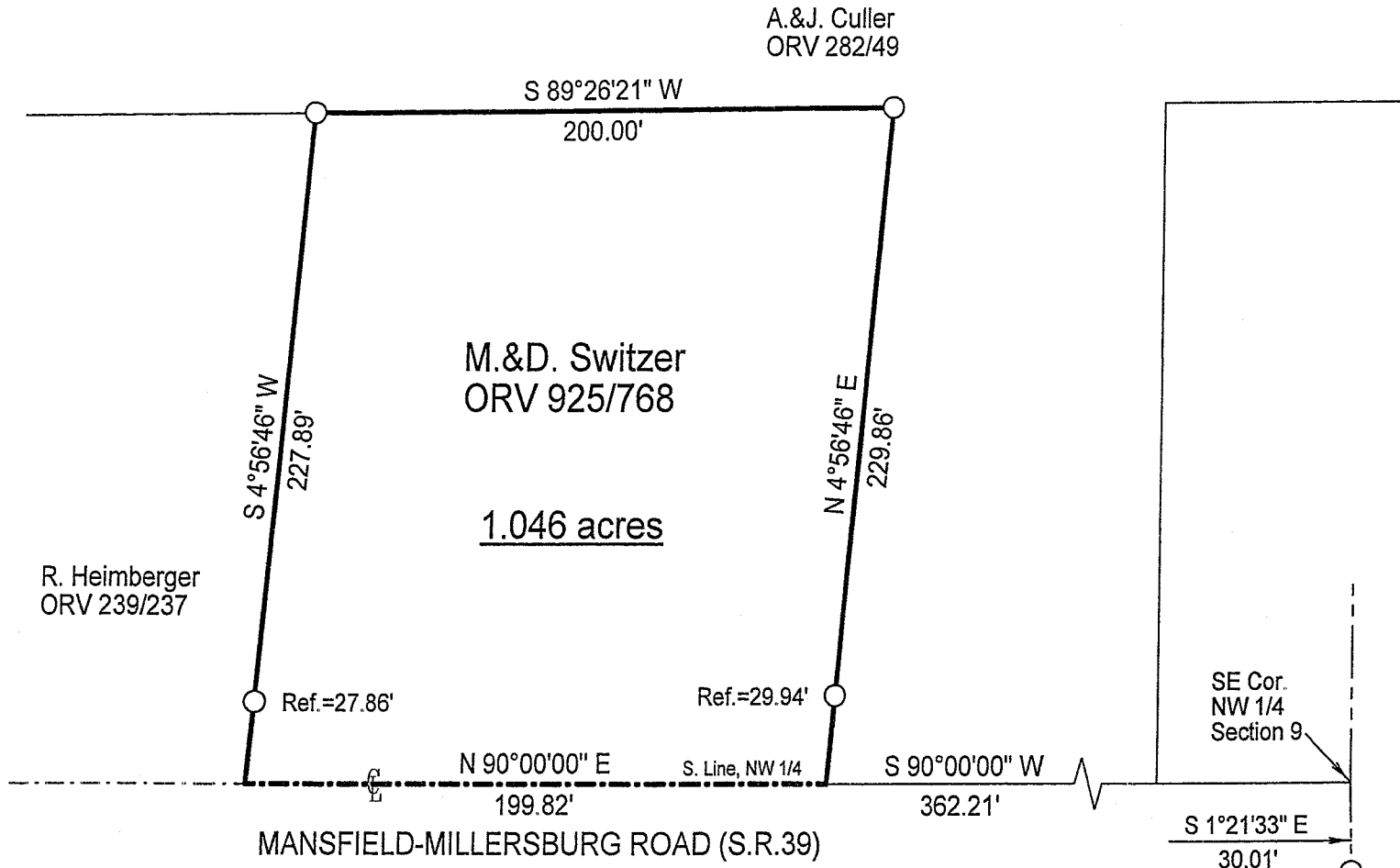

NEW SURVEY  
OF EXISTING PARCEL  
RICHLAND COUNTY  
TAX MAP OFFICE  
MIB 9-20-06  
INITIAL DATE

Scale : 1" = 60'

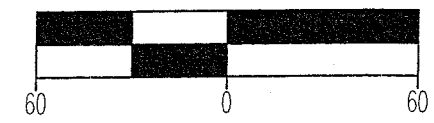

Bearings are based on Survey F-1-54.

## LEGEND

- Iron pin set with cap stamped "CLANCY 7178"
- Iron pin found

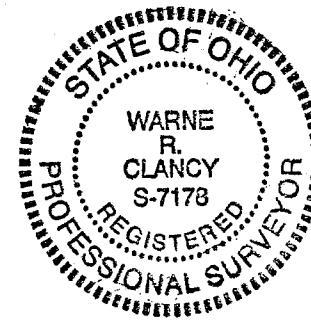

*Warne R. Clancy*  
Warne R. Clancy P.S. #7178

DATE: 9/18/06  
JOB NO.: W091806

SURVEY DESCRIPTION

Part Northwest Quarter - Section 9  
Monroe Township, T-22, R-17  
Richland County, Ohio

Situated in the Township of Monroe, County of Richland, State of Ohio, and being a part of the Northwest Quarter of Section 9 of Township 22 of Range 17, more particularly described as follows:

Commencing for the same at the southeast corner of said northwest quarter, referenced by an iron pin found South 01 degrees 21 minutes 33 seconds East a distance of 30.01 feet; Thence, South 90 degrees 00 minutes 00 seconds West with the south line of said quarter, the same being the centerline of State Route 39, a distance of 362.21 feet to a point, the Place of Beginning;

Thence, North 04 degrees 56 minutes 46 seconds East, passing an iron pin found for reference at 29.94 feet, a distance of 229.86 feet to an iron pin found;

Thence, South 89 degrees 26 minutes 21 seconds West, a distance of 200.00 feet to an iron pin found;

Thence, South 04 degrees 56 minutes 46 seconds West, passing an iron pin found for reference at 200.03 feet, a distance of 227.89 feet to a point on the said State Route 39 centerline;

Thence, North 90 degrees 00 minutes 00 seconds East with said centerline, a distance of 199.82 feet to the Place of Beginning, containing 1.046 acres according to survey by Warne R. Clancy, Professional Surveyor #7178, on September 18, 2006.

Iron pins set are #5 rebars with caps stamped "CLANCY 7178".

Bearings are based on Survey F-1-54.

NEW SURVEY  
OF EXISTING PARCEL  
RICHLAND COUNTY  
TAX MAP OFFICE

MLB 9-20-06  
INITIAL DATE

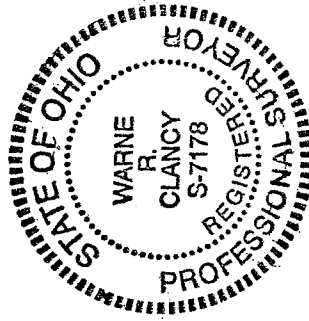

*Warne R. Clancy*  
Warne R. Clancy  
Professional Surveyor #7178