

Elliott
 O.R.V. 563 P. 25
 S86°26'28" E
 415.26
 BLSI Property LLC
 669.00'
 D.R.V. 1152 P. 138

5 04° 10' 08" W
 First Nat'l Bank
 D.K. 782 P. 360

6.397 Ac.

W.R.O.W. line
 80' 15"
 882.83
 Pennsylvania N 04° 00' 00" W
 E.R.O.W. Line

Ref. P. N 15° 46' 03" E
 44.35 of Int. of P's

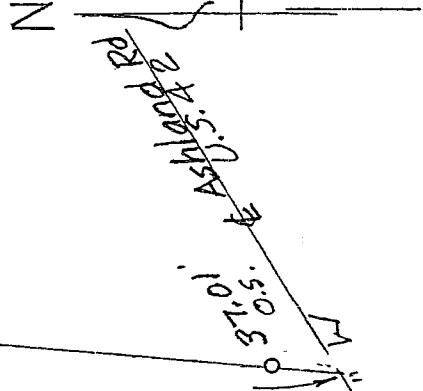

370.10' E
 370.10' N
 270.10' W
 270.10' S

357.47' 558° 19' 55"
 370.10'

- = Iron Pin set & capped "LITTLE 5524"
- = Iron Pin found
- ▲ = Mog nail set
- △ = P.R. nail found

Bearing Basis: Assumed

DESCRIPTION OF ENTIRE PEDDLER'S MARKET PROPERTY
 PART OF SE 1/4 SECTION 14
 TOWNSHIP 21 RANGE 18
 MADISON TOWNSHIP
 RICHLAND COUNTY, OHIO

Robert M. Little
 Registered Surveyor # 5524
 April 16, 2005

Robert M. Little

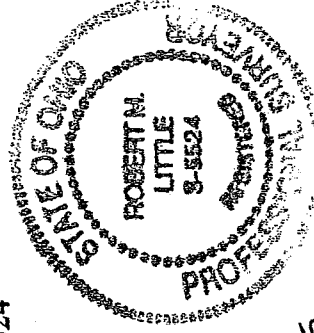

NEW SURVEY
 OF EXISTING PARCEL
 RICHLAND COUNTY,
 TAX MAP OFFICE

MLP 4-26-05
 INITIAL DATE

V-17

ROBERT M. LITTLE
SURVEYOR & ENGINEER
67 Redwood Rd, Mansfield, OH 44907 Phone 419-756-5056

DESCRIPTION OF ENTIRE PEDDLER'S MARKET PROPERTY
PART OF SE 1/4 SECTION 14
TOWNSHIP 21 RANGE 18
MADISON TOWNSHIP
RICHLAND COUNTY, OHIO

Situated in the Township of Madison, County of Richland, State of Ohio and being a part of the southeast quarter of Section 14, Township 21, Range 18, and being more fully described as follows:

Beginning at a P.K. nail, found, marking the intersection of centerlines of Ashland Road, U.S. 42, and Pennsylvania Ave. said point also bearing South 15°46' 03" West 44.35 feet from a reference Iron Pin, found;

Thence North 04° 00' 00" West, a distance of 882.83 feet to an Iron Pin, found, said course being with the centerline of pavement of Pennsylvania Ave., said centerline being 15 feet from the east right-of-way line and 30 feet from the west right-of-way line , as shown in Plat Book 11 Page 7;

Thence South 86° 26' 28" East, a distance of 415.26 feet to an iron pin found, said course being with the south line of lands conveyed to Elliott in Official Record Volume 563 Page 25;

Thence South 04° 10' 08" West, a distance of 669.00 feet to a point in the centerline of Ashland Road, passing an iron pin, found, 37.01 feet northerly of said point, at said bearing, said course being with the west line of lands conveyed to BLSI Property in Official Record Volume 1152 Page 138 and to First National Bank in Deed Volume 782 Page 360;

Thence South 58° 19' 55" West, a distance of 357.47 feet to the POINT OF BEGINNING, said course being with the centerline of said road;

Containing 6.397 Acres, more or less, but subject to all legal highways and easements of record.

BEARING BASIS: Bearings are assumed.

Note: The total parcel described herein is based on a more recent survey of the identically same parcel of land conveyed to Raymond and Joanne Wolf in Deed Volume 560 Page 16.

Robert M. Little
Registered Surveyor # 5524
April 22, 2005

NEW SURVEY
OF EXISTING PARCEL
RICHLAND COUNTY
TAX MAP OFFICE

INITIAL MLL DATE 4-22-05

