

R-240

NORTH



BEARINGS ARE BASED ON SURVEY F-2-403 ON FILE AT THE RICHLAND COUNTY TAX MAP OFFICE.

LEGEND

- IRON PIN FOUND
- ▲ RR SPIKE FOUND
- △ RR SPIKE SET
- ⊘ MAG NAIL SPIKE SET
- ⊗ 5/8" IRON PIN SET WITH CAP STAMPED "SEILER 6869"

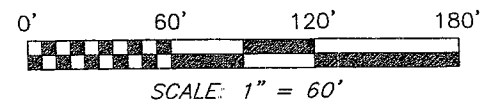

NEW SPLIT  
RICHLAND COUNTY  
TAX MAP OFFICE  
mlb 7-17-03  
INITIAL DATE

J. HALE, TRUSTEE  
O.R.V. 1093, PG. 836

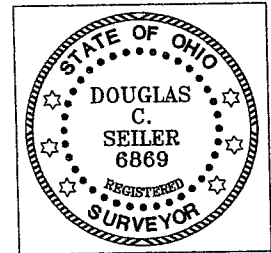

THE WEST LINE OF THE NW QTR. SECTION 32

M. RAUSCHER  
O.R.V. 880, PG. 800

S 89°38'15" E 143.00' N 89°38'15" W 240.00'

PARCEL 'A'  
0.32 ACRE

N 89°38'15" W 123.00'

B. AND V. EDMONDS  
O.R.V 36, PG. 295

PARCEL 'B'  
1.36 ACRES

J. AND R. LEWIS  
O.R.V. 1237, PG. 256

THE SW CORNER OF THE NW QTR. SECTION 32

THE PLACE OF BEGINNING PARCEL "A"

THE PLACE OF BEGINNING PARCEL "B"

THE SOUTH LINE OF THE NW QTR. SECTION 32

S 89°38'15" E 354.75' S 89°38'15" E 497.75' S 89°38'15" E 240.00'

COTTER ROAD  
(TOWNSHIP HIGHWAY 265)

N 89°38'15" W 20.00'

SEE DETAIL

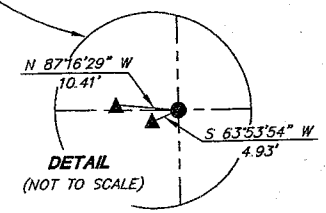

APPROVED THIS \_\_\_\_\_ DAY OF \_\_\_\_\_, 2003

EDWIN K. (JAKE) LAYFIELD  
WELLER TOWNSHIP  
ZONING INSPECTOR

SURVEY PLAT FOR	
PROPERTY TRANSFER	
PART NW QTR. SECTION 32, T-24, R-17	
WELLER TOWNSHIP	
RICHLAND COUNTY, OHIO	
DATE: JUNE 23, 2003	SCALE: 1"=60'
EDMONDS.DWG	

*Douglas C. Seiler*  
SURVEYED BY: DOUGLAS C. SEILER  
PROFESSIONAL SURVEYOR #6869  
52-1/2 NORTH MAIN STREET  
MANSFIELD, OHIO 44902  
(419) 525-3644  
FAX (419) 525-3696

R 240

# Douglas C. Seiler

Professional Land Surveyor

52½ North Main • Mansfield, Ohio 44902  
(419) 525-3644 • FAX (419) 525-3696

## SURVEY DESCRIPTION

### PARCEL "A"

PART NW QUARTER SECTION 32  
WELLER TOWNSHIP  
RICHLAND COUNTY, OHIO

Situated in the Township of Weller, County of Richland, State of Ohio and being part of the Northwest Quarter of Section 32, Township 24 North, Range 17 West, and more particularly described as follows:

Commencing at an iron pin found and accepted as marking the southwest corner of said quarter; Thence, South 89 degrees 38 minutes 15 seconds East with the south line of said quarter, the same being the centerline of Cotter Road (Township Highway 265), a distance of 354.75 feet to a Mag Nail spike set marking the southeast corner of a parcel currently owned by M. Rauscher (deed reference: O.R.V. 880, Pg. 800) and an existing corner of a parcel currently owned by J. Hale, Trustee (deed reference: O.R.V. 1093, Pg. 836), said spike being the place of beginning of the parcel herein described;

Thence, North 00 degrees 00 minutes 00 seconds East with the line common to the aforementioned parties, passing through an iron pin set for reference at 20.00 feet, a total distance of 247.50 feet to an iron pin set marking the northeast corner of said Rauscher parcel;

Thence, South 89 degrees 38 minutes 15 seconds East a distance of 143.00 feet to an iron pin set;

Thence, South 00 degrees 00 minutes 00 seconds East a distance of 72.50 feet to an iron pin set marking the northeast corner of a parcel currently owned by B. and V. Edmonds (deed reference: O.R.V. 36, Pg. 295);

Thence, North 89 degrees 38 minutes 15 seconds West with the north line of said Edmonds parcel a distance of 123.00 feet to the northwest corner thereof;

Thence, South 00 degrees 00 minutes 00 seconds East with the west line of said parcel, passing through an iron pin set for reference at 2.00 feet and also passing through an iron pin set for reference at 155.00 feet, a total distance of 175.00 feet to a Mag Nail spike set on said centerline and said south line;

Thence, North 89 degrees 38 minutes 15 seconds West with said centerline and said south line, a distance of 20.00 feet to the place of beginning, containing 0.32 of an acre, according to survey by Douglas C. Seiler, Professional Surveyor #6869 on June 23, 2003, but subject to the right of way of Cotter Road.

The grantee, his heirs and assigns do hereby covenant and agree that the parcel of land described by this instrument will not be conveyed by said grantee, heirs, or assigns independently from a contiguous parcel of land without the approval of the Richland County Regional Planning Commission.

Iron pins set are 5/8 inch rods with caps stamped "Seiler 6869".

Bearings are based on survey F-2-403 as recorded on file at the Richland County Tax Map office and are intended to be used for angular determination only.

NEW SPLIT  
RICHLAND COUNTY  
TAX MAP OFFICE

MLC  
INITIAL

7-17-03  
DATE

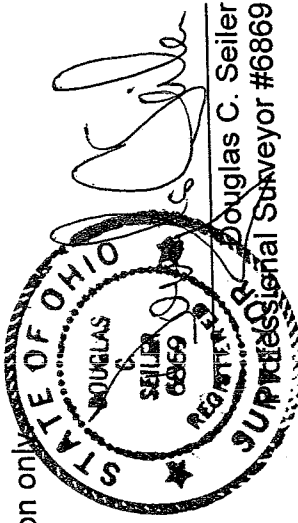

Douglas C. Seiler  
Professional Surveyor #6869

# Douglas C. Seiler

Professional Land Surveyor

52½ North Main • Mansfield, Ohio 44902  
(419) 525-3644 • FAX (419) 525-3696

## SURVEY DESCRIPTION

### PARCEL "B"

PART NW QUARTER SECTION 32  
WELLER TOWNSHIP  
RICHLAND COUNTY, OHIO

Situated in the Township of Weller, County of Richland, State of Ohio and being part of the Northwest Quarter of Section 32, Township 24 North, Range 17 West, and more particularly described as follows:

Commencing at an iron pin found and accepted as marking the southwest corner of said quarter; Thence, South 89 degrees 38 minutes 15 seconds East with the south line of said quarter, the same being the centerline of Cotter Road (Township Highway 265), a distance of 497.75 feet to a Mag Nail set marking the southeast corner of a parcel currently owned by B. and V. Edmonds (deed reference: O.R.V. 36, Pg. 295) and a southwesterly corner of a parcel currently owned by J. Hale, Trustee (deed reference: O.R.V. 1093, Pg. 836), said spike being the place of beginning of the parcel herein described;

Thence, continuing South 89 degrees 38 minutes 15 seconds East with said south line and said centerline a distance of 240.00 feet to a railroad spike set marking the southwest corner of a parcel currently owned by J. and R. Lewis (O.R.V. 1237, Pg. 256);

Thence, North 00 degrees 00 minutes 00 seconds East with the west line of said parcel and the northerly prolongation thereof, passing through an iron pin set for reference at 30.00 feet, a total distance of 247.50 feet to an iron pin set;

Thence, North 89 degrees 38 minutes 15 seconds West a distance of 240.00 feet to an iron pin set;

Thence, South 00 degrees 00 minutes 00 seconds East passing through an iron pin set for reference at 227.50 feet, a total distance of 247.50 feet to the place of beginning, containing 1.36 acres, according to survey by Douglas C. Seiler, Professional Surveyor #6869 on June 23, 2003, but subject to the right of way of Cotter Road.

Iron pins set are 5/8 inch rods with caps stamped "Seiler 6869".

Bearings are based on survey F-2-403 as recorded on file at the Richland County Tax Map office and are intended to be used for angular determination only.

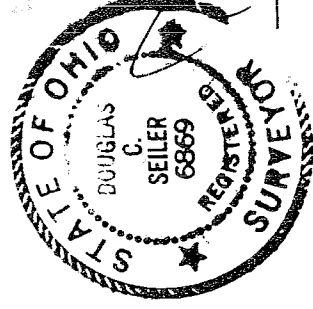

*Douglas C. Seiler*  
Douglas C. Seiler  
Professional Surveyor #6869

NEW SPLIT  
RICHLAND COUNTY,  
TAX MAP OFFICE

MSA- 7-11-03  
INITIAL DATE