

**SURVEY FOR  
RINDY SANSOM**

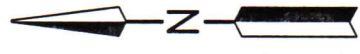
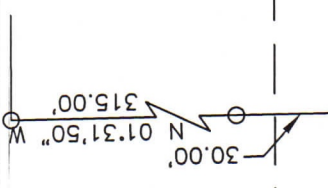

260.74'  
N 89°40'59" E 450.04'  
ALEXANDER ROAD (T.H. 340)(40')

RINDY D. SANSOM  
O.R.V.-3013 P.-2014  
**1.002 Acres**

S 89°40'59" W 450.04'  
DARWYN, LLC  
O.R.V.-2818 P.-112

MARIANNE KANUCH  
O.R.V.-2871 P.-311

BELLVILLE NORTH ROAD (C.H. 341)(60')

97.00'  
S 01°39'48" E 20.00'

GAR.

0.25'  
ENCROACHMENT



NEW SURVEY  
OF EXISTING PARCEL  
RICHLAND COUNTY  
TAX MAP OFFICE

**EAK 4-17-24**  
INITIAL & DATE  
**QQ-109**

PART OF THE SW. 1/4  
OF SEC. 34, T-20, R-18,  
WASHINGTON TWP.,  
RICHLAND CO., OHIO.

**LEGEND**

- IRON PIN FOUND
- IRON PIN SET, 5/8" DIA.  
ROD WITH PLASTIC CAP  
STAMPED "STEVENS 7052"

Distances shown hereon are expressed in feet and decimal parts thereof.

Basis of bearings: Survey NN-278.

CERTIFICATION: I hereby certify that the foregoing survey was prepared from actual field measurements, in accordance with Chapter 4733-37, Ohio Administrative Code and is correct to the best of my knowledge.

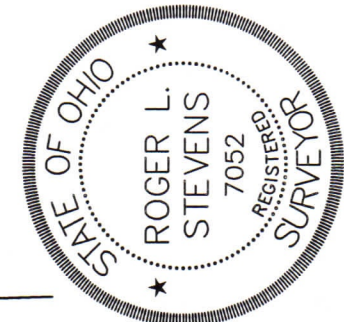

*Roger L. Stevens*

**SURVEYOR'S DESCRIPTION FOR  
RINDY SANSOM**

**1.002 Acre**

Situated in the Township of Washington, County of Richland, State of Ohio and being part of the Southwest Quarter of Section 34, Township 20, Range 18 and being more particularly described as follows:

**Beginning** at an iron pin found in the intersection of the centerline of Alexander Road (T.H. 340) and the west line of said Southwest Quarter;

Thence with the following **FOUR** courses:

- 1) **N 89° 40' 59" E, 450.04 feet** along said centerline of Alexander Road (T.H. 340) to a point being the northwest corner of a parcel of land conveyed to Marianne Kanuch by official records volume 2871, page 311, said point being referenced by an iron pin set S 01° 39' 48" E, 20.00 feet from said point;
- 2) **S 01° 39' 48" E, 97.00 feet** along the west line of said land of Marianne Kanuch to an iron pin set in the northeast corner of a parcel of land conveyed to Darwyn LLC by official records volume 2818, page 112 and passing through previously referenced iron pin set at 20.00 feet;
- 3) **S 89° 40' 59" W, 450.04 feet** along the north line of land of Darwyn LLC to a point being the northwest corner of said land, said point also being in said west line of said Southwest Quarter and passing through an iron pin set at 410.10 feet;
- 4) **N 01° 39' 48" W, 97.00 feet** along said west line of said Southwest Quarter to the **place of beginning** and containing **1.002 acre**, more or less, and subject to all legal highways and easements of record.

Basis of bearings: Survey NN-278 .

All iron pins set are 5/8" diameter reinforcing rod with plastic cap stamped "STEVENS 7052".

According to a survey made in April 2024 by Roger L. Stevens, Ohio Registered Surveyor No. 7052.



*Roger L. Stevens*  
 Roger L. Stevens  
 Registered Surveyor No. 7052  
 WASHINGTON 34A

NEW SURVEY  
 OF EXISTING PARCEL  
 RICHLAND COUNTY  
 TAX MAP OFFICE

**EAK 4-17-24**

INITIAL & DATE

**QQ-109**