

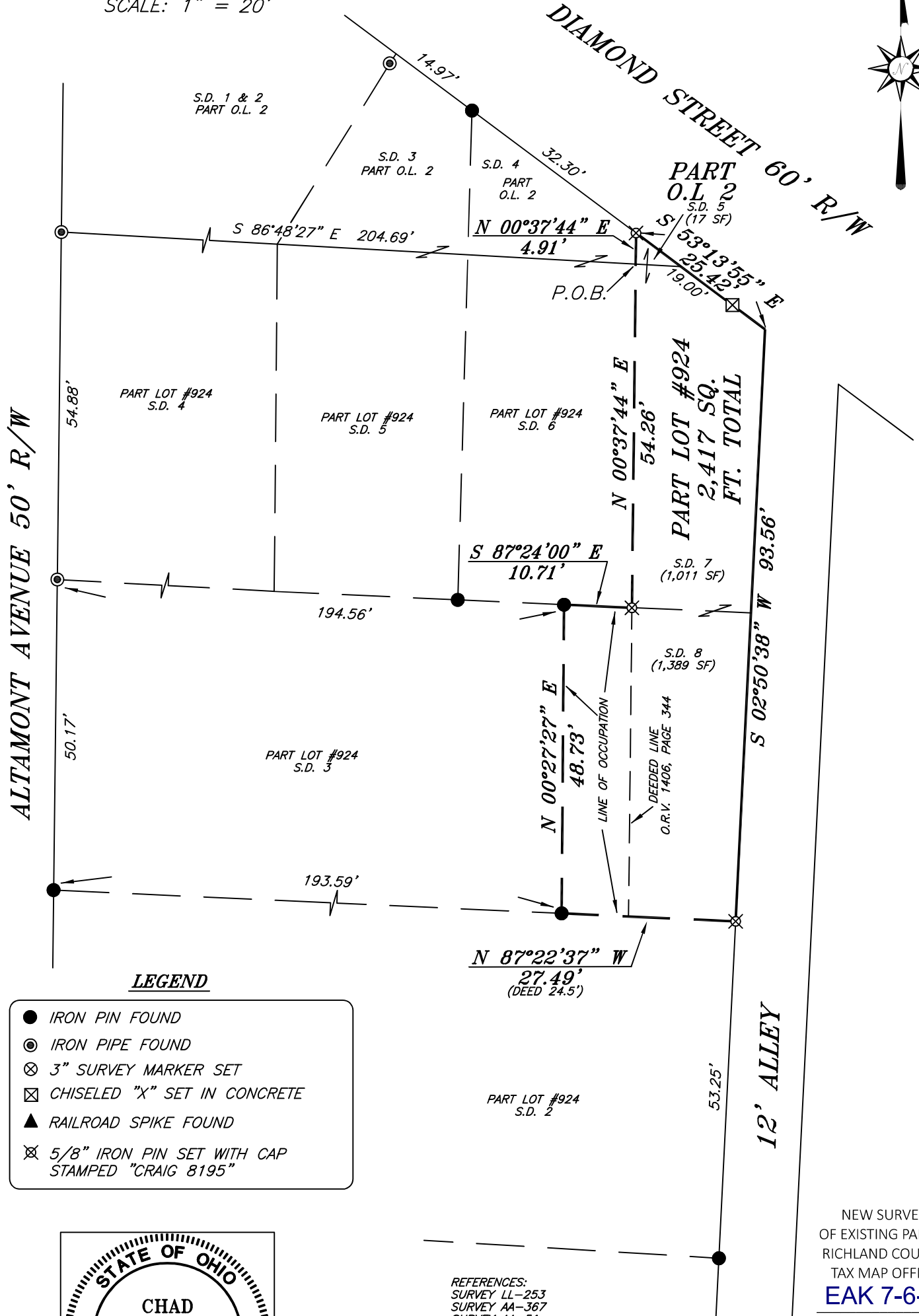

SCALE: 1" = 20'

BASIS OF BEARING IS STATE PLANE
GRID NORTH NAD 83 (2011), GEOID
18A, OHIO NORTH ZONE.

NORTH



LEGEND

- IRON PIN FOUND
- ⊙ IRON PIPE FOUND
- ⊗ 3" SURVEY MARKER SET
- ⊠ CHISELED "X" SET IN CONCRETE
- ▲ RAILROAD SPIKE FOUND
- ⊗ 5/8" IRON PIN SET WITH CAP STAMPED "CRAIG 8195"



Chad F. Craig

REFERENCES:
 SURVEY LL-253
 SURVEY AA-367
 SURVEY AA-51
 SURVEY NN-176

NEW SURVEY
 OF EXISTING PARCEL
 RICHLAND COUNTY
 TAX MAP OFFICE
EAK 7-6-23

INITIAL & DATE
PP-177

SURVEY BY: CHAD F. CRAIG P.S. #8195
 for SEILER & CRAIG SURVEYING INC.
 270 PARK AVENUE WEST
 MANSFIELD, OHIO 44902
 (419) 525-3644
 EMAIL: SEILERANDCRAIG@SEILERANDCRAIG.COM

SURVEY PLAT FOR	
PROPERTY TRANSFER	
PART OUT LOT 2 (S.D. 5) & PART LOT #924 (S.D. 7 & 8)	
CITY OF MANSFIELD	
RICHLAND COUNTY, OHIO	
DATE: JUNE 26, 2023	SCALE: 1"=20'
DIAMOND_ST_320	

SURVEY DESCRIPTION

PART OUT LOT 2, S.D. 5 AND PART LOT #924, S.D. 7 & 8
CITY OF MANSFIELD,
RICHLAND COUNTY, OHIO

Situated in the City of Mansfield, County of Richland, State of Ohio and being known as Part of Out Lot 2, S.D. 5 and Part of Lot #924, S.D. 7 & 8 of the consecutively numbered lots in said city and being more particularly described as follows:

Commencing at an iron pipe found and accepted as marking the southwest corner of Out Lot 2, Thence, South 86 degrees 48 minutes 27 seconds East with the south line of said out lot 204.69 feet to a point referenced by an iron pin set on a bearing of North 00 degrees 37 minutes 44 seconds East and at a distance of 4.91 feet, said point being the place of beginning of the parcel herein described;

Thence, North 00 degrees 37 minutes 44 seconds East 4.91 feet to an iron pin set;

Thence, South 53 degrees 13 minutes 55 seconds East passing through a chiseled "X" set in concrete at a distance of 19.00 feet, a total distance of 25.42 feet to a point marking a northeasterly corner of Lot #924, S.D. 7;

Thence, South 02 degrees 50 minutes 38 seconds West with east line of said lot 93.56 feet to an iron pin set marking the northeast corner of Part Lot #924 S.D. 2;

Thence, North 87 degrees 22 minutes 37 seconds West with the north line of said part lot 27.49 feet to an iron pin found;

Thence, North 00 degrees 27 minutes 27 seconds East 48.73 feet to an iron pin found on the south line of Part Lot #924 S.D. 6;

Thence, South 87 degrees 24 minutes 00 seconds East with said south line 10.71 feet to an iron pin set marking the southeast corner of said part lot;

Thence, North 00 degrees 37 minutes 44 seconds East with the east line of said part lot 54.26 feet to the place of beginning, containing a total of 2,417 square feet of which 17 square feet are located in Out Lot 2, S.D. 5, 1,011 square feet are located in Part Lot #924 S.D. 7 and 1,389 square feet are located in Part Lot #924 S.D. 8, according to survey by Chad F. Craig P.S. 8195 on June 26, 2023, but subject to all easements, right of ways and highways of record.

Iron pins set are 5/8" rods with caps stamped "CRAIG 8195".

Bearings are based on State Plane Grid North NAD 83 (2011), Geoid 18A, Ohio North Zone and are intended to be used for angular determination only.

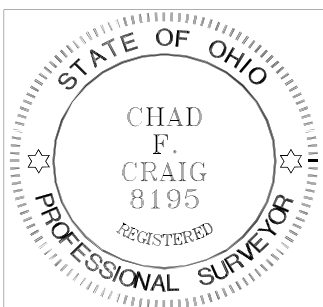

NEW SURVEY
OF EXISTING PARCEL
RICHLAND COUNTY
TAX MAP OFFICE
EAK 7-6-23
INITIAL & DATE
PP-177

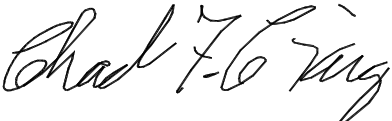
Chad F. Craig P.S. #8195
Seiler and Craig Surveying, Inc.