

M-377

OHIO EDISON COMPANY  
O.R.V. 251, P. 476

M. ZAVIS, TRUST  
D.V. 880, P. 728

CITY OF MANSFIELD,  
AN OHIO MUNICIPAL CORP.  
O.R.V. 704, P.476

The grantor, grantee and all subsequent owners or assignees taking title from, under or through the grantor or grantee agrees that any use or improvement made on this land shall be in conformity with all existing valid zoning, platting, health, or other lawful rules and regulations."

**BASIS OF BEARINGS**

BEARINGS ARE BASED UPON THE CENTERLINE OF HARRINGTON MEMORIAL ROAD BEARING BEING N 00°39'39" W AS SHOWN ON P.B.V. 27, P. 123 RICHLAND COUNTY RECORDER'S RECORDS.

C1  
Δ=10°27'17"  
R=487.73'  
L=89.00'  
CH BRG=S69°56'41"W  
CH=88.87'  
T=44.62'

WEST LINE, S.E. 1/4, SEC. 4  
N01°04'26"W 1175.53'

FUTURE ROAD RIGHT OF WAY  
(60' R/W)

APPROVED BY THE MANSFIELD CITY PLANNING COMMISSION  
NO PLAT REQUIRED

SIGNED: *Howard L. Koziny*  
SECRETARY, CITY PLANNING COMMISSION  
DATE *Sept 11, 2000*

PARAGON PARKWAY  
P.B.V. 26, P. 139

LOT 22768

LOT 22770

S.E. CORNER  
S.E. 1/4  
SEC. 4

NEW SPLIT  
TAX MAP APPROVED  
FAX *9-12-00*  
INITIAL DATE

**LEGEND**

- SURVEY MARKER SET-5/8" DIA. X 30" LG. REBAR WITH CAP STAMPED "RICHLAND ENG RLS 7209"
- ◇ RAILROAD SPIKE FOUND
- IRON PIPE FOUND
- SURVEY MARKER FOUND-5/8" DIA. X 30" LG. REBAR WITH CAP STAMPED "RICHLAND ENG RLS 7209"
- ⊗ SURVEY MARKER FOUND-5/8" DIA. X 30" LG. REBAR WITH CAP STAMPED, "RICHLAND ENGINEERING LIMITED, ROBERT A CUNNING RLS 4939"

THE GRANTEEES, HIS HEIRS AND ASSIGNS DO HEREBY COVENANT AND AGREE THAT THE PARCEL OF LAND DESCRIBED IN THIS INSTRUMENT OR ANY PORTION THEREOF DOES NOT CONSTITUTE A PRINCIPAL BUILDING SITE UNDER APPLICABLE ZONING.

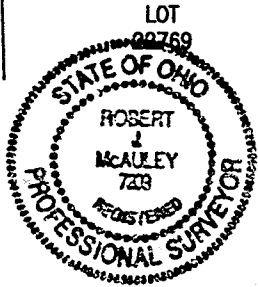

*Robert J. McAuley* 6 Sept 2000  
ROBERT J. MCAULEY DATE  
RLS 7209



RICHLAND ENGINEERING LIMITED  
29 NORTH PARK STREET MANSFIELD, OHIO 44902

Survey of Property  
0.950 Acre Parcel  
City of Mansfield

SITUATED IN THE CITY OF MANSFIELD, TOWNSHIP OF MADISON, COUNTY OF RICHLAND, STATE OF OHIO, AND BEING A PART OF THE SOUTHEAST QUARTER OF SECTION 4, TOWNSHIP 21, RANGE 18

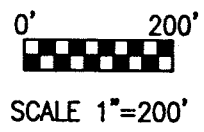

Description For  
City of Mansfield  
0.950 Acre Parcel (cont.)

Thence North 88°11'50" East, a distance of 770.00 feet to a survey marker set on the west line of lands now or formerly owned by CR/PL Limited Partnership as recorded in Official Record Volume 368, Page 359;

Thence South 01°48'10" East along the west line of said CR/PL Limited Partnership lands, a distance of 50.00 feet to the "RLS 7209" survey marker found at the point of beginning, containing 0.950 acres of land, more or less, subject to all highways, easements and use restrictions of record.

This description is based upon an actual field survey. All bearings are based upon the centerline of Harrington Memorial Road (66' R/W) bearing North 00°39'39" West as shown on Plat Volume 27, Page 123 of the Richland County Recorder's Records.

Bearings are assumed and are for the determination of angular measurement only.

Survey markers set are 5/8" x 30" long rebar with plastic cap stamped "RICHLAND ENG. RLS 7209".

"RLS 7209" survey markers found are 5/8" x 30" long rebar with plastic cap stamped "RICHLAND ENG. RLS 7209".

"RLS 4939" survey markers found are 5/8" x 30" long rebar with cap stamped "RICHLAND ENGINEERING LIMITED, Robert A. Cunning, RLS 4939".

The grantees, their heirs and assigns do hereby covenant and agree that the parcel of land described in this instrument or any portion thereof does not constitute a principal building site under applicable zoning and will not be conveyed by said grantees, heirs, and assigns independent and separate from any adjoining or continuous parcel fronting on a public highway or street.

Deed Reference: Official Record Volume 704, Page 476.

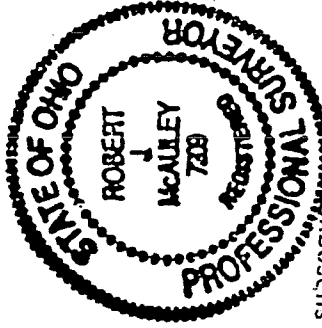
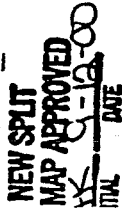

*Robert J. McAuley*  
Robert J. McAuley : Date  
RLS 7209 : 6 Sept 2000

M-377

APPROVED BY THE MANSFIELD CITY PLANNING COMMISSION;  
NO PLAT REQUIRED.

or, grantee and all subsequent owners  
is taking title from, under or through the  
grantee agrees that any use or improve-  
ment on this land shall be in conformity with  
valid zoning, platting, health, or other  
and regulations."

SIGNED: *Howard J. Natus*  
SECRETARY, CITY PLANNING COMMISSION;

DATE: *Sept 11, 2000*