

- SYMBOLS**
- △ = POST FOUND
 - ⊕ = STONE FOUND
 - = RAILROAD SPIKE FOUND
 - = 5/8" YEAGER UNLESS NOTED.
 - = RAILROAD SPIKE SET
 - = 5/8" IRON PIN SET WITH CAP STAMPED LAUGHERY P.S. 6111
 - ⊗ = PK NAIL FOUND
- - - - - = EXISTING PROPERTY LINE
 - - - - - = CENTER LINE
 - - - - - = PROPOSED OR SUBJECT LINE
 * * * * * = FENCE LINE
 T.M.P. = CURRENT TAX MAP PARCEL ID
 (R), (M), (C) = RECORD, MEASURED, CALCULATED
 BEARINGS ARE BASED ON A SURVEY BY ROY E. YEAGER DATED 09/04/2008.
 DISTANCES ARE MEASURED UNLESS OTHERWISE STATED.
 ANGLES ARE IN DEG - MIN - SEC.
 DISTANCES ARE IN FEET

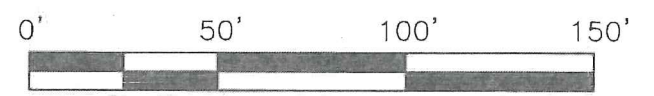

I HEREBY CERTIFY THIS PLAT TO BE A TRUE DELINEATION OF A FIELD SURVEY IN FEBRUARY, 2018.

Ronald L. Laughery
 RONALD L. LAUGHERY
 REGISTERED SURVEYOR #6111

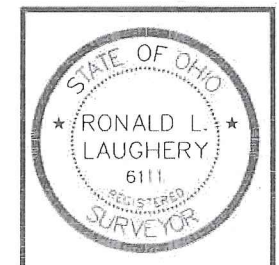

PLAT OF A SURVEY TO LOCATE AND DESCRIBE ALL OF A TRACT OF LAND CONVEYED TO KEVIN E. STARKEY BY DEED RECORDED IN OFFICIAL RECORDS VOLUME 2496, PAGE 0348.

NEW SURVEY
 OF EXISTING PARCEL
 RICHLAND COUNTY
 TAX MAP OFFICE

EAK 2-22-18
 INITIAL DATE
KK-40

LAUGHERY, INC.
 ENGINEERING & SURVEYING
 967 US 42
 ASHLAND, OHIO 44805
 rlaughery@frontier.com 419-289-0469

SE 1/4, SECTION 3, T-22-N, R-18-W
 FRANKLIN TOWNSHIP
 RICHLAND COUNTY, OHIO

DRAWN BY JKL DATE 02/13/18 SCALE 1"=50'

LAUGHERY, INC.
ENGINEERING AND SURVEYING
967 US 42
ASHLAND, OHIO 44805

1.000 ACRES

The following parcel of land Situated in the State of Ohio, the County of Richland and the Township of Franklin;

Being a parcel of land conveyed to Kevin E. Starkey by deed recorded in Official Records Volume 02496, Page 0348 and known as being a part of the southeast quarter of Section 3, T-22-North, R-18-West and being more fully described as follows:

Beginning for reference at a P.K. nail found on the west line of the southeast quarter of Section 3 and the center of SR 96 (60' r/w); Thence South 84°-09'-00" East, along the center of said SR 96, a distance of 194.14 feet to a point at the southwest corner of a parcel of land conveyed to David L. and Linda L. Clark by deed recorded in Official Records Volume 0387, Page 0201, said point being referenced by a 7/8" pipe found North 06°-21'-02" East a distance of 36.61 feet; Thence South 83°-56'-00" East, along the center of said SR 96, a distance of 287.86 feet to a point at the southeast corner of said Clark parcel, said point being referenced by a 2" pipe found North 05°-42'-57" East a distance of 35.03 feet, said point also being the true place of beginning for the parcel herein to be conveyed;

Thence along the following 4 courses:

1. North 06°-04'-00" East, along the east line of said Clark parcel, a distance of 188.57 feet to an iron pin set on the south line of a parcel of land conveyed to Betsy A. Rhodes by deed recorded in Volume 870, Page 765 of the Richland County Record of Deeds;
2. South 83°-56'-00" East, along the south line of said Rhodes parcel, a distance of 231.00 feet to a 5/8" Yeager pin found at the northwest corner of a parcel of land conveyed to Vernon L. Stephens by deed recorded in Official Records Volume 2511, Page 0201;
3. South 06°-04'-00" West, along the west line of said Stephens parcel, a distance of 188.57 feet to a point in the center of said SR 96, said point being referenced by a 5/8" Yeager pin found North 06°-04'-00" East a distance of 30.00 feet;
4. North 83°-56'-00" West, along the center of said SR 96, a distance of 231.00 feet to the true place of beginning.

The tract of land as surveyed contains 1.000 acres of land subject to all legal highways and easements of record. These bearings are based on a survey by Roy E. Yeager dated 09/04/2008. All iron pins set are 5/8" rebar, 30 inches long with cap stamped "Laughery- P.S. 6111".

The above description was prepared by Ronald L. Laughery, Registered Surveyor No. 6111, from notes of a field survey performed February, 2018.

NEW SURVEY
OF EXISTING PARCEL
RICHLAND COUNTY
TAX MAP OFFICE

EAK 2-22-18
INITIAL DATE
KK-40