

KRISTIAN T. & ANITA L. KOCHHEISER
ORV. 2420, PG. 176

N 69°54'45" E 160.31'

0.656 AC.
DAVID A. DASHKOVITZ
AND
ROBIN L. DASKOVITZ
ORV. 2462, PG. 738

N 03°04'44" W 160.38'

REF=32.24'

±46.7'

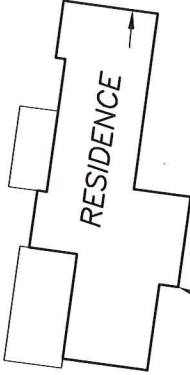

±27.8'



±4.0'

S 05°02'47" W 285.97'

REF=25.70'

HEIDI M. McMANES
ORV. 2532, PG. 86

NEW SURVEY
OF EXISTING PARCEL
RICHLAND COUNTY
TAX MAP OFFICE

EAK 1-8-18
INITIAL DATE
KK-10
DWG. ONLY

CURVE "A"
L=130.01'
R=399.06'
Δ=18°40'01"
CH. BRG.=N 61°27'09" W
CH. DIST.=129.44'
T=65.59'

ALTA WEST ROAD—(T.H. 147)

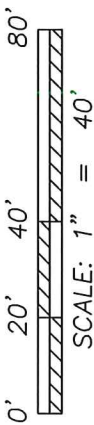

SCALE: 1" = 40'



LEGEND

- IRON PIN/PIPE FOUND
- LATH SET ON PROPERTY LINE

Distances shown hereon are expressed in feet and decimal parts thereof.

Bearings are to an assumed meridian and are used to express angles only.

By: Nathaniel B. Ramsey P.S. #8396 Date 10/03/2017

For Ramsey Surveying

RAMSEY SURVEYING
Professional Land Surveying Services

283 Eby Road
Shiloh, Ohio 44878
TEL (419) 512-2596 FAX (419) 522-0399
EMAIL nramsey@ramsey-surveying.com

SURVEY MADE AT THE REQUEST OF
ROBIN DASHKOVITZ

PART OF THE NORTHWEST QUARTER
OF SECTION 36, SPRINGFIELD TOWNSHIP,
T-21 N, R-19 W

RICHLAND COUNTY, OHIO

DRAWN NSR	CHECKED <u>NSR</u>	SCALE 1" = 40'	DATE 10/03/2017
JOB NO: SM-5219			SHEET 1 OF 1