

MORTGAGE LOCATION - SURVEY PLAT

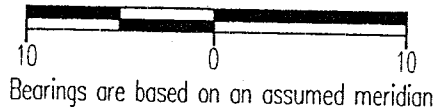

Scale : 1" = 10'



PROPERTY INFORMATION	
FOR: ACS Title and Closing Services	
LENDER: EquiCredit	
BUYER: Danny S. Roucker	QUARTER:
OWNER: D.&D. Rentals	SECTION:
ADDRESS: 199 Mason Street	TOWNSHIP:
ALLOTMENT:	RANGE:
PLAT BOOK: VOL 5 ,PG. 17	GREAT LOT:
CITY OR VILLAGE: Mansfield	COUNTY: Richland
LOT(S) NO. Part #4095	STATE: Ohio

NOTE

THIS MORTGAGE LOCATION SERVICE IS PROVIDED FOR TITLE COMPANY AND/OR LENDER ONLY; AND MUST NOT BE RELIED UPON BY PROPERTY OWNER IN DETERMINATION OF BOUNDARY LINES, SET BACK LINES OR ANY OTHER PURPOSE.

Lot #4094

S 89°35'14" E
60.00'

Part Lot #4095
2280 sq ft

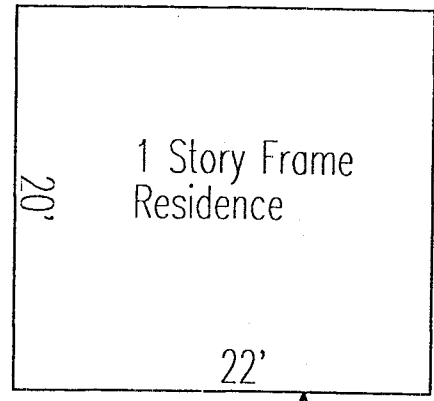

N 89°35'14" W
60.00'

N 0°14'37" W
38.00'

S 0°14'37" E
38.00'

I Herby certify that the foregoing Mortgage Location Survey was prepared from actual field measurements in accordance with Chapter 4733-38, Ohio Administrative Code, and is not a boundary survey pursuant to Chapter 4733-37 of said code.

Subject structure(s) is outside the special flood hazard area shown on federal insurance agency flood hazard map No. 390477 0009 C.

LEGEND

- Iron pin set with cap stamped "CLANCY 7178"

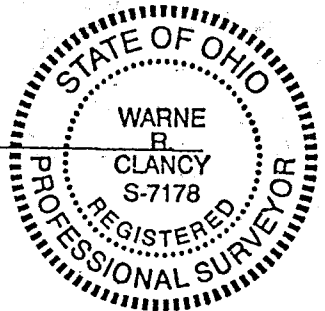

NEW SURVEY OF EXISTING PARCEL TAX MAP APPROVED
 INITIAL: [Signature] DATE: 12-7-98

Warne R. Clancy
 Warne R. Clancy P.S. #7178

MASON STREET (40' R/W)

DATE: 12/4/98
 JOB NO.: W120298

SW Corner Lot #4095
 S 89°35'14" E
 Iron pin found 43.00'

Part Lot #4095

Part Lot #4095

SURVEY DESCRIPTION

Part Lot #4095, City of Mansfield
Plat Volume 5, Page 17
Richland County, Ohio

Situated in the City of Mansfield, County of Richland, State of Ohio, and being a part of Lot #4095 of the consecutively numbered lots of said city as recorded in Plat Volume 5, page 17 of the plat records of said county, more particularly described as follows:

Commencing for the same at an iron pin found marking the southwest corner of said Lot #4095, the same being a point on the north right-of-way line of Mason Street (40' R/W); Thence, South 89 degrees 35 minutes 14 seconds East with said right-of-way line, a distance of 43.00 feet to an iron pin set, the Place of Beginning;

Thence, North 00 degrees 14 minutes 37 seconds West, a distance of 38.00 feet to an iron pin set on the north line of said Lot #4095;

Thence, South 89 degrees 35 minutes 14 seconds East with said north line, a distance of 60.00 feet to an iron pin set thereon;

Thence, South 00 degrees 14 minutes 37 seconds East, a distance of 38.00 feet to an iron pin set on the said north Mason Street right-of-way line;

Thence, North 89 degrees 35 minutes 14 seconds West with said right-of-way line, a distance of 60.00 feet to the Place of Beginning, containing 2,280 square feet according to survey by Warne R. Clancy, Professional Surveyor #7178, on December 2, 1998.

Iron pins set are #5 rebars with caps stamped "CLANCY 7178".

Bearings are based on an assumed meridian.

K-233

NEW SURVEY
OF EXISTING PARCEL
TAX MAP APPROVED
DATE 12-2-98

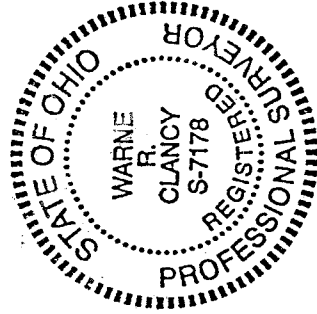

Warne R. Clancy
Warne R. Clancy
Professional Surveyor #7178