

SURVEY FOR ANDREW J. KNAPP

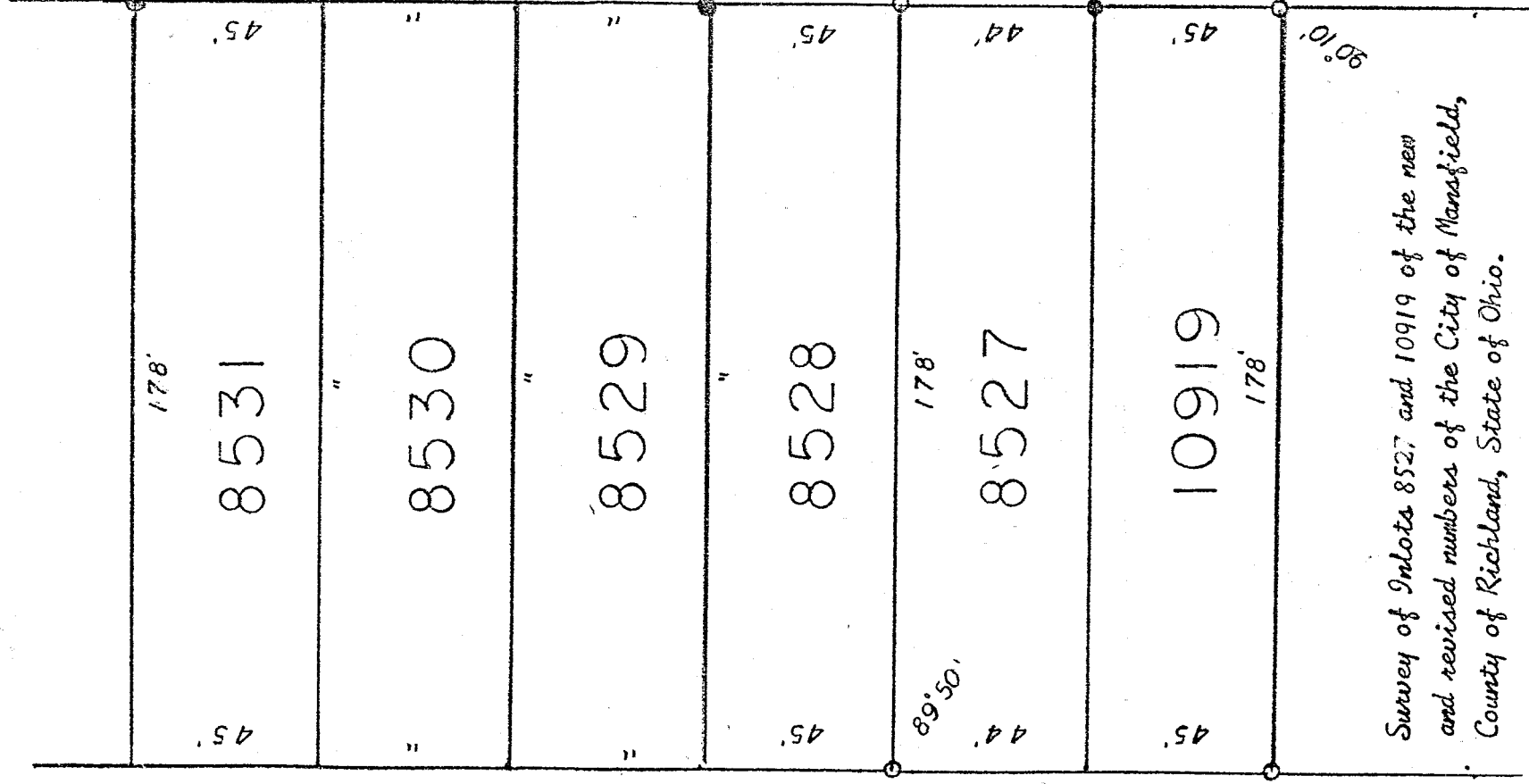

Survey of Inlots 8527 and 10919 of the new
and revised numbers of the City of Mansfield,
County of Richland, State of Ohio.

References: Plat Book 13 pg. 2
Plat Book 14 pg. 19

VENNUM AVE. 65'

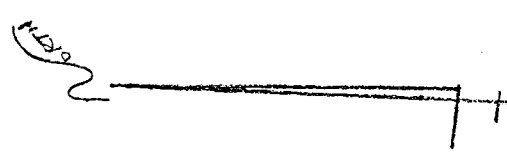

K-4

- - Iron pin set
 - - Iron pin found
- Gerald W. Riedel
Ohio reg. surveyor 5817
Scale: 1" to 40'
September 8, 1982

5R