

PROPERTY INFORMATION

FOR: Southern Title of Ohio, Inc.
 LENDER: Tower Mortgage
 BUYER: Dean R. & Angela L. Levingslon
 OWNER: John C. & Becky K. Smith
 ADDRESS: 3982 Tucker Rd.
 ALLOTMENT:
 PLAT BOOK: VOL PG.
 CITY OR VILLAGE:
 LOT(S) NO.

LEGEND

- Iron pin set with cap stamped "CLANCY 7178"
- Iron pin found
- ◻ Railroad Spike found
- ⊙ Mag-nail set

J.&M. Huss
1.357 ac.
ORV 167/234

HASTINGS - NEWVILLE ROAD (C.H. 302)
 S 56° 45' 37" E 118.82'

Ref.=26.97'

R.&H. Butterbaugh
79.173 ac.
ORV 516/361

5' deck encroachment

0.5' pole type addition encroachment

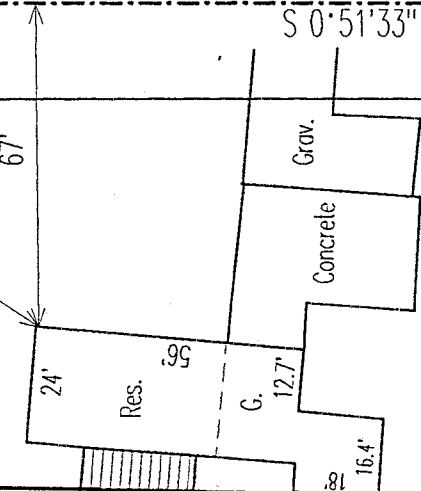

N 0° 18' 22" E 349.94'

0.740 acres

Ref.=22.06'

S 87° 38' 49" W 105.54'

L.&R. Smith
0.687 ac.
ORV 327/506

DATE: 8/11/98

JOB NO.: W073198

SURVEY PLAT

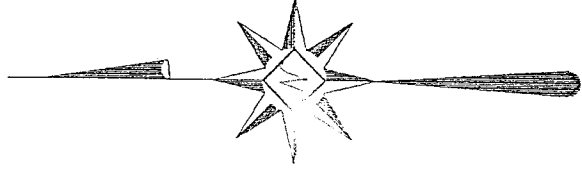

NEW SURVEY
 OF EXISTING PARCEL
 TAX MAP APPROVED
 INITIAL DATE
 EAK 8-14-98

J.&R. Huss
1.5 ac.
ORV 33/407

Scale: 1" = 40'



Bearings are based on Survey F-2-139.

NOTE

THIS SERVICE IS PROVIDED FOR TITLE COMPANY AND/OR LENDER ONLY; AND MUST NOT BE RELIED UPON BY PROPERTY OWNER IN DETERMINATION OF BOUNDARY LINES, SET BACK LINES OR ANY OTHER PURPOSE.

I Hereby certify that the foregoing Mortgage Location Survey was prepared from actual field measurements in accordance with Chapter 4733-38, Ohio Administrative Code, and is not a boundary survey pursuant to Chapter 4733-37 of said code.

Subject structure(s) is outside the special flood hazard area shown on federal insurance agency flood hazard map No. 390476 0150 B.

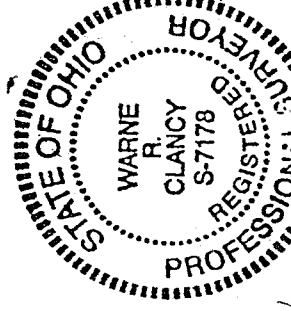

Warne R. Clancy

Warne R. Clancy

P.S. 7178

J-519

SURVEY DESCRIPTION

Part Southwest Quarter, Section 30
Monroe Township, T-22, R-17
Richland County, Ohio

Situated in the Township of Monroe, County of Richland, State of Ohio, and being a part of the Southwest Quarter of Section 30 of Township 22, Range 17, more particularly described as follows:

Beginning for the same at a railroad spike found marking the intersection of the centerlines of Tucker Road (T.H. 336) and Hastings-Newville Road (C.H. 302), the same being a point on the east line of said southwest quarter;

Thence, South 00 degrees 51 minutes 33 seconds East with said east line and said Tucker Road centerline, a distance of 280.50 feet to a Mag-nail set marking the northeast corner of an existing 0.687 acre parcel owned by L.&R. Smith (ORV 327/506);

Thence, South 87 degrees 38 minutes 49 seconds West with the north line of said 0.687 acres, passing an iron pin found for reference at 22.06 feet, a distance of 105.54 feet to an iron pin set on the east line of an existing 79.173 acre parcel owned by R.& H. Butterbaugh (ORV 516/361);

Thence, North 00 degrees 18 minutes 22 seconds East with said east line, passing an iron pin found for reference at 322.97 feet, a distance of 349.94 feet to a railroad spike found on the said Hastings-Newville Road centerline;

Thence, South 56 degrees 45 minutes 31 seconds East with said centerline, a distance of 118.82 feet to the Place of Beginning, containing 0.740 acres according to survey by Warne R. Clancy, Professional Surveyor #7178, on July 31, 1998.

Iron pin set is a #5 rebar with cap stamped "CLANCY 7178".

Bearings are based on Survey F-2-139.

U-519

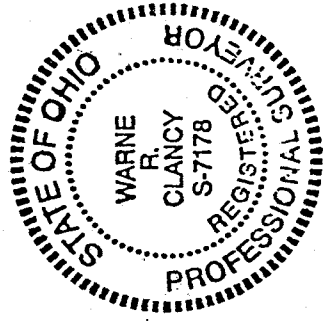

Warne R. Clancy
Warne R. Clancy
Professional Surveyor #7178

NEW SURVEY
OF EXISTING PARCEL
TAX MAP APPROVED
DATE 1-98
INITIAL [Signature]