

SURVEY FOR
 GEORGE BASSLER
 RANGE 17, TOWNSHIP 21, S.W. QUARTER OF SECTION 16,
 WORTHINGTON TOWNSHIP, RICHLAND COUNTY, OHIO

J-310

Scale 1" = 200 Date 5-1-98 P.B. P. O.K. 461 P. 917 Drawn By SKV

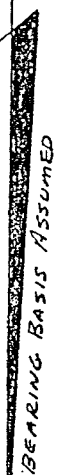
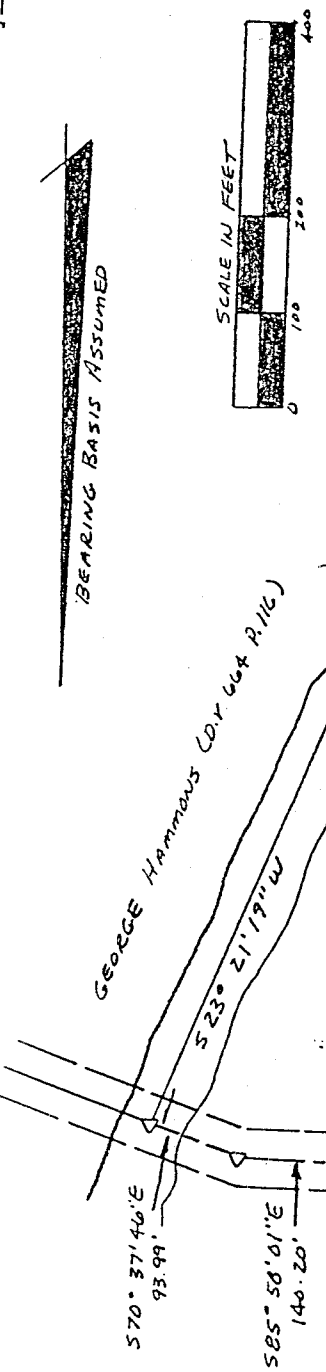

LEGEND

- △ PR NAIL SET
- 1/2" X 30" IRON PIN SET W/ PLASTIC CAP STAMPED "VANCE 6553"
- IRON PIN FOUND

NEW SURVEY
 OF EXISTING PARCEL
 TAX MAP APPROVED
 EAY 5-17-98
 INITIAL DATE

J-310

19.585
 ACRES

T.H. 349

CLEAR FORK RIVER
 M.W. LETSCHE, TRUSTEE (O.R. 135 P. 330)

BENEDICT ROAD

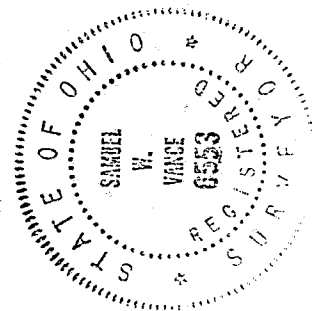

I hereby certify that the foregoing drawing was prepared from an actual survey of the premises.

M. & M. GILLSON (O.R. 777 P. 36)

Samuel W. Vance
 Registered Surveyor No. 6553

VANCE SURVEYING

LAND SURVEYOR
 28 Clinton Road, Mount Vernon, Ohio 43050

Vance Sur

28 Clinton Road

Mount Vernon, Ohio 43050 - 1157

DESCRIPTION 19.585 ACRES

Being Situated in the southwest quarter of Section sixteen (16), Range seventeen (17), Township twenty-one (21), Worthington Township, Richland County, State of Ohio and being part of that land of record in Official Records Volume 461 Page 917 in the Richland County Recorder's Office and being more particularly described as follows;

Beginning for reference at an iron pin found at the southwest corner of Section 16, being the common corner of Sections 16, 17, 20 and 21; thence North 02 degrees 35 minutes 12 seconds East along the west line of Section 16 a distance of 1005.00 feet to a 1/2 inch iron pin set and being the true place of beginning;

thence from the true place of beginning North 02 degrees 35 minutes 12 seconds East along the west line of section 16, the easterly boundary of M. & M. Gillson (D.V. 797 P. 36), a distance of 415.50 feet (passing over a 1/2 inch iron pin set at 385.50 feet) to a pk nail set the centerline of Benedict Road (Township Highway 349);

thence along the centerline of Benedict Road (Township Highway 349) the following 11 courses:

North 82 degrees 50 minutes 24 seconds East a distance of 60.98 feet to a pk nail set;
North 70 degrees 59 minutes 24 seconds East a distance of 250.60 feet to a pk nail set;
North 65 degrees 52 minutes 38 seconds East a distance of 323.15 feet to a pk nail set;
North 70 degrees 50 minutes 51 seconds East a distance of 120.92 feet to a pk nail set;
North 82 degrees 00 minutes 44 seconds East a distance of 158.81 feet to a pk nail set;
South 83 degrees 48 minutes 07 seconds East a distance of 249.22 feet to a pk nail set;
North 71 degrees 26 minutes 41 seconds East a distance of 189.31 feet to a pk nail set;
North 85 degrees 56 minutes 46 seconds East a distance of 209.25 feet to a 1/2 inch iron pin set;
North 41 degrees 03 minutes 17 seconds East a distance of 254.11 feet to a 1/2 inch iron pin set;
South 85 degrees 58 minutes 01 seconds East a distance of 140.20 feet to a pk nail set;
South 70 degrees 37 minutes 46 seconds East a distance of 93.99 feet to a pk nail set in the center of a bridge over the Clear Fork River;

thence South 23 degrees 21 minutes 19 seconds West partially along the centerline of the Clear Fork River, the westerly boundary of George Hammons (D.V. 664 P. 116), a distance of 649.30 feet to a 1/2 inch iron pin set;

thence South 81 degrees 35 minutes 12 seconds West along a northerly boundary of M.W. Letsche, Trustee (O.R. 135 P. 330) a distance of 1290.62 feet to a 1/2 inch iron pin set;

thence South 73 degrees 35 minutes 12 seconds West continuing along a northerly boundary of said Letsche a distance of 396.00 feet to the place of beginning - containing 19.585 acres, more or less.

Subject to all legal right-of-way of previous records.

The above description was prepared from a survey made by me, Samuel W. Vance, Registered Surveyor No. 6553 in April, 1998. Bearing basis assumed. All pins set are 1/2 inch by 30 inch iron pins with plastic caps stamped "Vance 6553".

NEW SURVEY
OF EXISTING PARCEL
TAX MAP APPROVED
DATE 5-12-98
INITIAL SAK

J-310