

CITY OF MANSFIELD

COUNTY OF RICHLAND

STATE OF OHIO

BASIS OF BEARINGS:  
PLAT BOOK 18 PG. 113

N

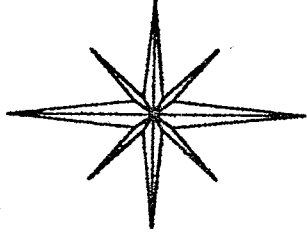

14306

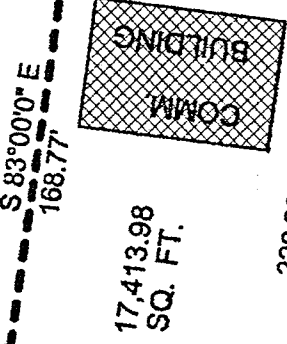

C/I/L CURVE DATA:

R = 4457.47'

D = 01 17' 07"

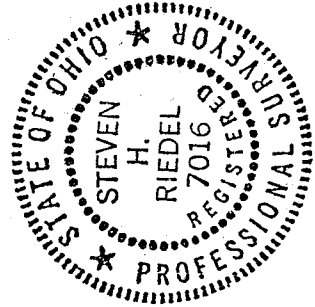

14307

C/L LEXINGTON AVE. (S.R. 42)  
C.P.C.

C/I/L LOGAN ROAD

NEW SURVEY  
OF EXISTING PARCEL  
TAX MAP APPROVED  
DATE 5-5-98  
INITIAL Dug ONLY

Graphic Scale

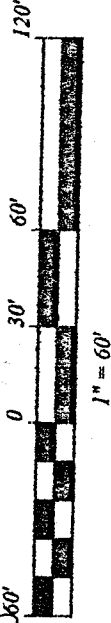

LEGEND:

- - 5/8 INCH REBAR W/CAP STAMPED "PS 7016" SET
- - EXISTING IRON PIPE
- ⊙ - CONCRETE MONUMENT FOUND

STEVEN H. RIEDEL  
OHIO SURVEYOR 7016  
APRIL 12, 1998  
MA14306

CORP. LINE & EAST LINE N.W. 1/4 SEC. 5  
S 1°29'56" W  
281.52'  
89.48'

25.12'

J-280