

VAN ROSS & SHIRLEY J. WADE  
D.V.-610 P.-607

N 01°12'54" W  
759.73'

DOUGLAS A. & KAREN D. DARR  
O.R.V.-419 P.-106

S 89°17'18" E  
665.20'

S 87°05'37" E  
655.04'

39.96'

DOUGLAS DARR  
O.R.V.-203 P.-460

654.80'D.  
655.04'M.  
S 87°05'37" E

30.12'

15.158 AC.

JANET S. McCONACHIE  
O.R.V.-188 P.-593



- SURVEY FOR  
JANET S. McCONACHIE**
- LEGEND**
- M. MEASURED
  - D. DEED
  - O IRON PIN FOUND
  - RAILROAD SPIKE FOUND
  - RAILROAD SPIKE SET
  - IRON PIN SET, 5/8" DIA. ROD WITH PLASTIC CAP STAMPED "STEVENS 7052"

212.90' C DILL ROAD (T.R. 400)

30.08'

S 87°05'37" E  
610.00'

5.000 AC.

JANET S. McCONACHIE  
O.R.V.-295 P.-526

N 01°12'54" W  
358.00'

710.15'  
N 89°17'18" W

175.22' N 87°05'37" W

30.08'

SE CORNER  
NE. 1/4 SEC. 11

679.33' N 01°12'54" W

S. LINE NE. 1/4 SEC. 11

EDWIN L. SECRIST  
D.V.-799 P.-265  
D.V.-800 P.-647  
D.V.-871 P.-762

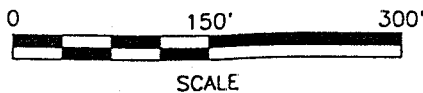

Distances shown hereon are expressed in feet and decimal parts thereof, bearings are to an assumed meridian and are used to express angles only.

CERTIFICATION: I hereby certify that the foregoing survey was prepared from actual field measurements, in accordance with Chapter 4733-37, Ohio Administration Code.

PART OF THE NE. 1/4 OF  
SEC. 11, T-19, R-18,  
JEFFERSON TWP.,  
RICHLAND CO., OHIO.

NEW SURVEY  
OF EXISTING PARCEL  
TAX MAP APPROVED  
BAK 2-18-98  
DATE

*Roger L. Stevens*  
Roger L. Stevens, P.S. #7052 Date 2-18-98 SM-1757

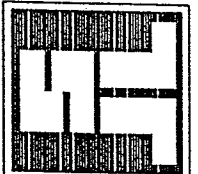

**SHAFFER, JOHNSTON, LICHTENW ALTER  
& ASSOCIATES, INC.**  
CONSULTING ENGINEERS - SURVEYORS  
MANSFIELD OHIO WOOSTER

211-C

Roger L. Stevens

February 18, 1998

**SURVEYOR'S DESCRIPTION FOR  
JANET S. MCCONACHIE**

5.000 Acres

Situated in the Township of Jefferson, County of Richland, State of Ohio and being part of the Northeast Quarter of Section 11, Township 19, Range 18 and being more particularly described as follows:

Commencing at a railroad spike found in the southeast corner of said Northeast Quarter, said iron pin also being in the centerline of Dill Road (T.H. 400);

Thence N 01° 12' 54" W, 679.33 feet along said centerline of Dill Road also being the east line of said Northeast Quarter to a railroad spike set in the northwest corner of a parcel land conveyed to Edwin L. Secrist by deed volume 799, page 265, deed volume 800, page 647 and deed volume 871, page 762, said railroad spike being the true place of beginning;

Thence N 87° 05' 37" W, 610.00 feet along the north line of said land of Edwin L. Secrist to an iron pin set and passing through an iron pin set at 30.08 feet;

Thence N 01° 12' 54" W, 358.00 feet to an iron pin set;

Thence S 87° 05' 37" E, 610.00 feet to a railroad spike set in the east line of said Northeast Quarter, said railroad spike also being in said centerline of Dill Road and passing through an iron pin set at 579.92 feet;

Thence S 01° 12' 54" E, 358.00 feet along said east line of said Northeast Quarter and said centerline of Dill Road to the true place of beginning and containing 5.000 acres, more or less, but subject to all legal highways and easements of record.

Bearings are to an assumed meridian and are used to express angles only.

All iron pins set are 5/8" diameter reinforcing rod with plastic cap stamped "STEVENS 7052".

According to a survey made in February 1998 by Roger L. Stevens, Ohio Registered Surveyor No. 7052.

NEW SURVEY  
OF EXISTING PARCEL  
TAX MAP APPROVED  
**BAK**  
DATE **2-19-98**

**15.158 Acres**

Situated in the Township of Jefferson, County of Richland, State of Ohio and being part of the Northeast Quarter of Section 11, Township 19, Range 18 and being more particularly described as follows:

Commencing at a railroad spike found in the southeast corner of said Northeast Quarter, said iron pin also being in the centerline of Dill Road (T.H. 400);

Thence N 01° 12' 54" W, 1,037.33 feet along said centerline of Dill Road also being the east line of said Northeast Quarter to a railroad spike set, said railroad spike being the true place of beginning;

Thence N 87° 05' 37" W, 610.00 feet to an iron pin set and passing through an iron pin set at 30.08 feet;

Thence S 01° 12' 54" E, 358.00 feet to an iron pin set in the north line of a parcel land conveyed to Edwin L. Secrist by deed volume 799, page 265, deed volume 800, page 647 and deed volume 871, page 762;

Thence N 89° 17' 18" W, 710.15 feet along the north line of said land of Edwin L. Secrist to an iron pin set in the southeast corner of a parcel of land conveyed to Van Ross and Shirley J. Wade by deed volume 610, page 607;

Thence N 01° 12' 54" W, 759.73 feet along the east line of said land of Van Ross and Shirley J. Wade to an iron pin set in the southwest corner of a parcel of land conveyed to Douglas A. and Karen D. Darr by official records volume 419, page 106;

Thence S 89° 17' 18" E, 665.20 feet along the south line of said land of Douglas A. and Karen D. Darr to an iron pin found in the northwest corner of a parcel of land conveyed to Douglas Darr by official records volume 203, page 460;

Thence S 01° 12' 59" E, 187.10 feet along the west line of said land of Douglas Darr to an iron pin found in the southeast corner of said land;

Thence S 87° 05' 37" E, 655.04 feet along the south line of said land of Douglas Darr to the southeast corner of said land also being in the east line of said Northeast Quarter and said centerline of Dill Road and passing through an iron pin found at 624.92 feet;

Thence S 01° 12' 54" E, 212.90 feet along said east line of said Northeast Quarter and said centerline of Dill Road to the true place of beginning and containing 15.158 acres, more or less, but subject to all legal highways and easements of record.

Measurements are to an assumed meridian and are used to express angles only.

All iron pins set are 5/8" diameter reinforcing rod with plastic cap stamped "STEVENS 7052".

According to a survey made in February 1998 by Roger L. Stevens, Ohio Registered Surveyor No. 7052.



*Roger L. Stevens*  
Roger L. Stevens  
Registered Surveyor No. 7052  
SM-1757C

NEW SURVEY  
OF EXISTING PARCEL  
TAX MAP APPROVER  
EAK 3-19-98  
INITIAL DATE

U-1100