

H-H-H

8hh-H

SURVEY PLAT

For Barbara Kenipe
Part Northwest Quarter, Section 10
Washington Township, T-20, R-18
Richland County, Ohio

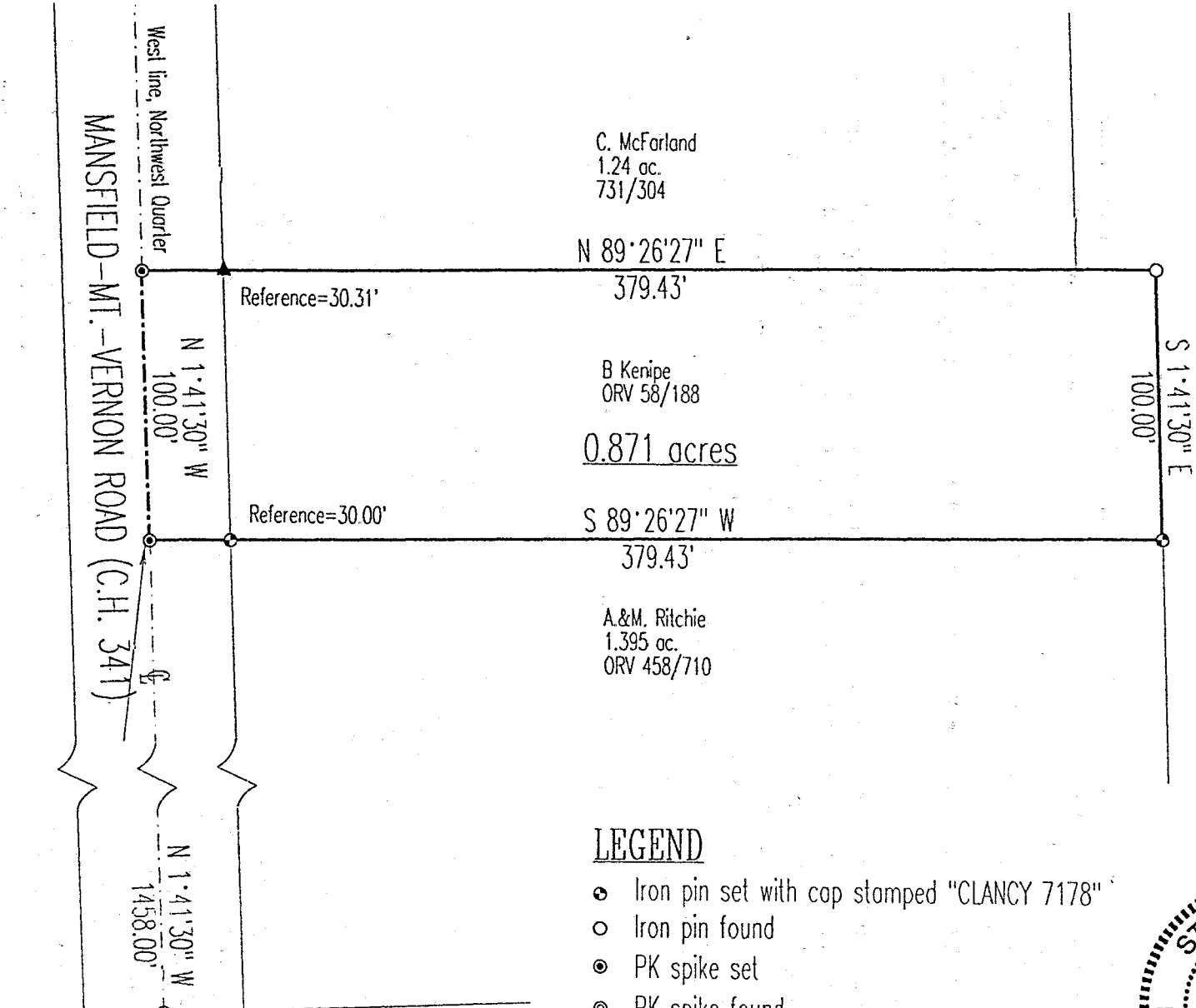

R. Fleck
38.871 ac.
ORV 260/700

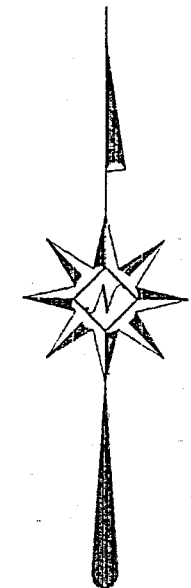

Scale : 1" = 60'

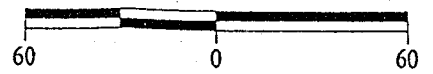

Bearings are based on Survey F-1-96.

LEGEND

- Iron pin set with cap stamped "CLANCY 7178"
- Iron pin found
- ⊙ PK spike set
- ⊙ PK spike found
- ▲ Railroad Spike found



NEW SURVEY
OF EXISTING PARCEL
TAX MAP APPROVED
DATE 12-18-97

Warne R. Clancy
Warne R. Clancy P.S. #7178

H-448

DATE: 12/16/97

JOB NO.: W121597

H-448

H-448

H-448

SURVEY DESCRIPTION

PAT NORTHWEST QUARTER, SECTION 10
WASHINGTON TOWNSHIP, T-20, R-18
RICHLAND COUNTY, OHIO

Situated in the Township of Washington, County of Richland, State of Ohio, and being a part of the Northwest Quarter of Section 10 of Township 20, Range 18, more particularly described as follows:

Commencing for the same at a PK spike found marking the southwest corner of said quarter, the same being a point on the centerline of the Mansfield-Mt. Vernon Road (C.H. 341); Thence, North 01 degrees 41 minutes 30 seconds West with the west line of said quarter and said centerline, a distance of 1458.00 feet to a PK spike set marking the northwest corner of an existing 1.395 acre parcel owned by A.&M. Ritchie (ORV 458/710), the Place of Beginning;

Thence, continuing with said quarter and centerlines North 01 degrees 41 minutes 30 seconds West, a distance of 100.00 feet to a PK spike set marking the southwest corner of an existing 1.24 acre parcel owned by C. McFarland (731/304);

Thence, North 89 degrees 26 minutes 27 seconds East with the south line of said 1.24 acres and its easterly projection, passing a railroad spike found for reference at 30.31 feet, a distance of 379.43 feet to an iron pin found on the westerly line of an existing 38.871 acre parcel owned by R. Fleck (ORV 260/700);

Thence, South 01 degrees 41 minutes 30 seconds East with said westerly line, a distance of 100.00 feet to and iron pin set marking the northeast corner of said 1.395 acres;

Thence, South 89 degrees 26 minutes 27 seconds West with the north line of said 1.395 acres, passing an iron pin set for reference at 349.43 feet, a distance of 379.43 feet to the Place of Beginning, containing 0.871 acres according to survey by Warne R. Clancy, Professional Surveyor #7178, on December 15, 1997.

Iron pins set are #5 rebars with caps stamped "CLANCY7178".

Bearings are based on survey F-1-96.

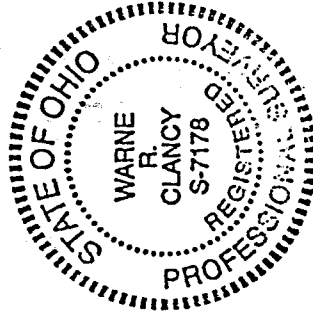

Warne R. Clancy
Warne R. Clancy
Professional Surveyor #7178

NEW SURVEY
OF EXISTING PARCEL
TAX MAP APPROVED
12-18-97
DATE

H-448