

7-325

11-325

SURVEY FOR
K. & P. POLAND
SW QUARTER OF SECTION 30, RANGE 19, TOWNSHIP 21,
SPRINGFIELD TOWNSHIP, RICHLAND COUNTY, OHIO

Scale 1"= 50' Date 1-31-97 P.B. P. O.R. 76 P.328 Drawn By S.W.V.

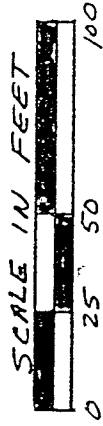

SCALE IN FEET

BEARINGS ASSUMED

B. FUGITT (D.V. 768 P. 23)

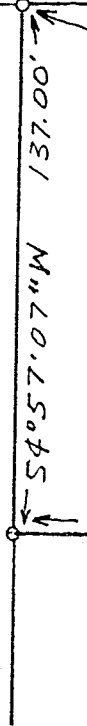

137.00'

S4°57'07\"/>

1.381
ACRES

439.00'

439.00'

R. & C. MURRAY (D.V. 722 P. 285)

N85°36'27\"/>

P. HOLMES (O.R. 430 P. 642)

S85°36'27\"/>

SECTION 30

SECTION 31

S.W. CORNER
SECT. 30

N4°57'07\"/>

LOHR ROAD - T.R. 45

LEGEND

- △ PK NAIL SET
- IRON PIPE FOUND

NEW SURVEY
OF EXISTING PARCEL
MAP APPROVED
JAN 23 1997

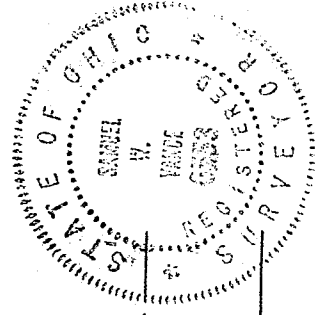

I hereby certify that the foregoing drawing was prepared from an actual survey of the premises.

Samuel W. Vance
Registered Surveyor No. 6553

VANCE SURVEYING
LAND SURVEYOR

H-325

DESCRIPTION - 1.381 ACRE TRACT

Being situated in the southwest quarter of Section thirty (30), Township twenty-one (21), Range nineteen (19), Springfield Township, Richland County, State of Ohio and being that land of record in Official Records Volume 76, Page 328 in the Richland County Recorder's Office and being more particularly described as follows;

Beginning for reference at a pk nail set in the centerline of Lohr Road (Township Highway 45) at the southwest corner of the southwest quarter of Section 30;

thence from the place of beginning North 04 degrees 57 minutes 07 seconds East along the centerline of Lohr Road, the west line of Section 30, a distance of 137.00 feet to a point;

thence South 85 degrees 36 minutes 27 seconds East along the southerly boundary of P. Holmes (O.R. 430 P. 642) a distance of 439.00 feet (passing over an iron pipe found at 30.00 feet) to an iron pipe found;

thence South 04 degrees 57 minutes 07 seconds West along the westerly boundary of B. Fugitt (D.V. 768 P. 23) a distance of 137.00 feet to an iron pipe found;

thence North 85 degrees 36 minutes 27 seconds West along the south line of Section 30, the northerly boundary of R. & C. Murnay (D.V. 772 P. 285) a distance of 439.00 feet (passing over an iron pipe found at 409.00 feet) to the place of beginning-containing 1.381 acres, more or less.

Subject to all legal right-of-way of previous record.

The above description was prepared from a survey made by me, Samuel W. Vance, Registered Surveyor No. 6553 in January, 1997. Bearing Basis assumed. All pins set are 1/2 inch by 30 inch iron pins with plastic cap stamped "Vance 6553".

NEW SURVEY
OF EXISTING PARCEL
APPROVED
JH 2397