

NE Cor of Lot 2547

Lot 2547

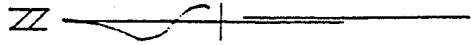

Scale: 1" = 40'
0 40'

⊙ = Iron Pin set & capped "1.17711 - 5524"

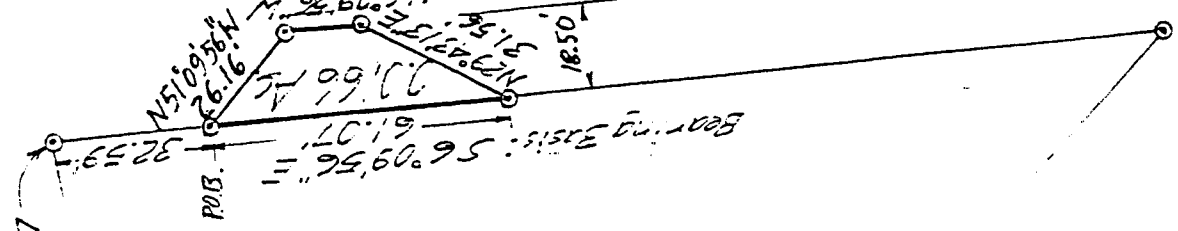

DRAWING OF SURVEY FOR LAD WUTHRICH

PART OF NE 1/4 SECTION 26
TOWNSHIP 21 RANGE 19
SPRINGFIELD TOWNSHIP
VILLAGE OF ONTARIO
RICHLAND COUNTY, OHIO

Robert M. Little

Robert M. Little
Registered Surveyor # Ohio 5524
June 4, 1996

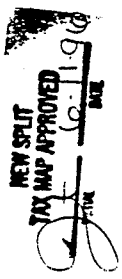
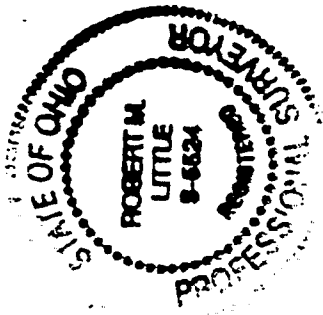

G-204

G-204

ROBERT M. LITTLE
PROFESSIONAL SURVEYOR AND ENGINEER
67 Redwood Rd., Mansfield, Ohio, 44907
Phone 419 / 756-5056

DESCRIPTION OF SURVEY FOR LAD WUTHRICH

PART OF NE 1/4 SECTION 26
TOWNSHIP 21 RANGE 19
SPRINGFIELD TOWNSHIP
VILLAGE OF ONTARIO
RICHLAND COUNTY, OHIO

Situated in the Village of Ontario, in the County of Richland, State of Ohio and being a part of the Northeast Quarter of Section 26, Township 21, Range 19, and being more particularly described as follows:

Starting at an iron pin, set and capped, marking the northeast corner of Lot 2547 of the Village of Ontario;

Thence South 06° 09' 56" East a distance of 32.59 feet to an iron pin, set and capped, marking the TRUE POINT OF BEGINNING of lands herein described, said course being with the east line of said quarter;

Thence continuing South 06° 09' 56" East a distance of 61.07 feet to an iron pin, set and capped, said course being with the east line of said quarter;

Thence North 29° 43' 13" East a distance of 31.56 feet to an iron pin, set and capped;

Thence North 06° 09' 56" West a distance of 17.00 feet to an iron pin, set and capped, said course being parallel to, and 18.5 feet easterly of, the east line of said quarter;

Thence North 51° 09' 56" West a distance of 26.16 feet to the point of beginning;

Containing 0.0166 acres of land, more or less, but subject to all easements of record.

Bearing basis: The platted bearings of Lot 2547;

Grantees, their heirs and assigns do hereby covenant and agree that the parcel of land described in this instrument will not be conveyed by said grantees, heirs and assigns, unless said parcel fronts on a public highway or dedicated street, or is sold together with land fronting on a public highway or dedicated street.



Robert M. Little
Registered Surveyor # Ohio 5524
June 4, 1996

disk 82

