

G-13

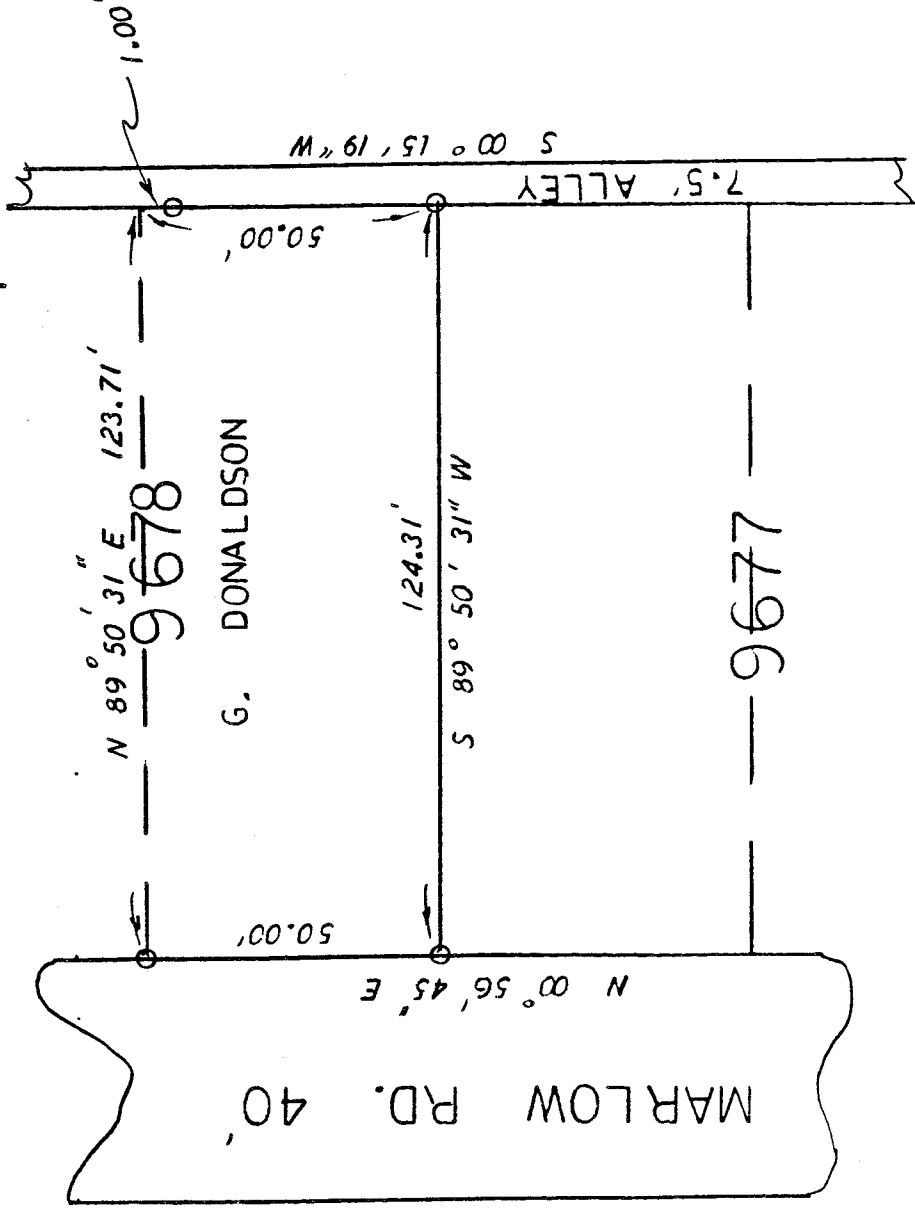

NEW SURVEY  
OF EXISTING PARCEL  
TAX MAP APPROVED  
INITIAL DATE  
S.H.S. 2-4-96

CITY OF MANSFIELD  
COUNTY OF RICHLAND  
STATE OF OHIO

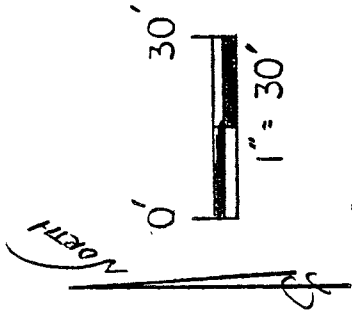

LEGEND:

0 - 5/8" REBAR W/ CAP  
STAMPED "PS 7016" SET

BASIS OF BEARINGS:

① PLAT BOOK "B" PAGE 34

STEVEN H. RIEDEL  
OHIO SURVEYOR 7016  
FEBRUARY 12, 1996

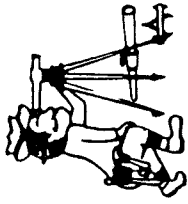

Phone (419) 683-1951

# Riedel Land Surveying Company

712 N. Henry St.  
Crestline, Ohio 44827

February 16, 1996

Gordon Donaldson (Pt. Lot 9678)  
ma9678

Being known as part of Inlot 9678 of the new and revised numbers of the City of Mansfield, County of Richland, State of Ohio and being more fully described as follows:

Beginning at a 5/8 inch rebar set at the Southwest corner of Inlot 9678;

thence running North 00 deg. 56 min. 45 sec. East along the West line of Inlot 9678 (also being the East line of Marlow Road) for 50.00 feet to a 5/8 inch rebar set;

thence turning and running North 89 deg. 50 min. 31 sec. East for 123.71 feet;

thence turning and running South 00 deg. 15 min. 19 sec. West along the East line of Inlot 9678 (also being the West line of a 7.50 foot alley), passing a 5/8 inch rebar set at 1.00 foot, for a total distance of 50.00 feet to a 5/8 inch rebar set at the Southeast corner of Inlot 9678;

thence turning and running South 89 deg. 50 min. 31 sec. West along the South line of said Inlot for 124.31 feet to the place of beginning.

All 5/8 inch rebars set have a plastic cap stamped "PS 7016.

The above described parcel is referenced to a survey made on February 12, 1996 by Steven H. Riedel, Ohio registered surveyor 7016.

Basis of bearings: Plat book B page 34

NEW SURVEY  
OF EXISTING PARCEL  
TAX MAP APPROVED  
BY PA 34-96  
DATE