

14 14
14 14

14 13
14 13

MAP OF SURVEY OF A 162.156 ACRE PARCEL

SE QUARTER OF SECTION 14
T-22-N; R-19-W
JACKSON TOWNSHIP
RICHLAND COUNTY, OHIO

162.156 ACRES TOTAL

SHELBY LAND COMPANY, LTD.
O.R. 1368, P-310

LASER RD. T.R. 210

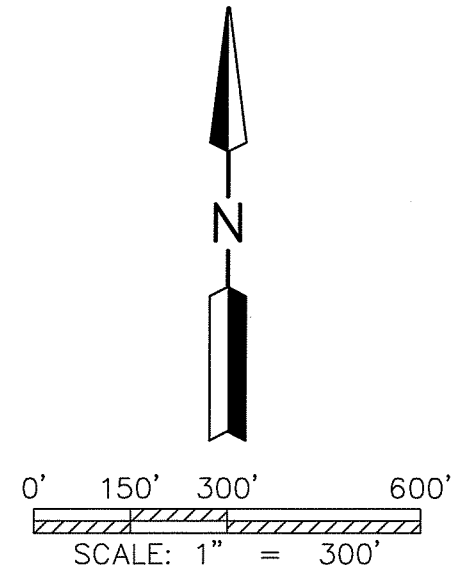

REFERENCE SURVEY:
F-2-13, G-252, M-4, V-171, Z-202, BB-284

BASIS OF BEARING:
The bearings as shown hereon are relative to
GRID NORTH of the OHIO STATE PLANE
COORDINATE SYSTEM, NAD 83 DATUM

NEW SURVEY
OF EXISTING PARCEL
RICHLAND COUNTY
TAX MAP OFFICE
EAK 12-11-13
INITIAL DATE
EE-308



Distances shown hereon are expressed in feet and decimal parts thereof, bearings are used to express angles only, iron pins or monuments were found or set as indicated hereon. All of which I believe to be correct to the best of my knowledge.

By: Jason J. Lingenfelter 11-27-13
JASON J. LINGENFELTER, P.S. #8499 DATE

SHAFFER, JOHNSTON, LICHTENWALTER & ASSOCIATES, INC.
Consulting Engineers & Surveyors
909 South Main Street
Mansfield, Ohio 44907
TEL (419) 756-7302 FAX (419) 756-0867 EMAIL sjl@sjl-inc.com

DRAWN JUL	CHECKED	1" SCALE = 300'	DATE NOV. 27, 2013
DWG NO: SM-2090	JOB NO: SM-2090	SHEET 1 OF 1	

NORTH LINE OF THE SE QTR N 89°54'31" E 1305.87' TOTAL

"VILLAGE ENGINEERING" BAR & CAP FD. @ 30.00' N 89°46'33" E 1342.23' TOTAL REC. & USED

"KERG" BAR & CAP FD. @ THE NW CORNER OF THE SE QTR OF SEC 14

"KERG" BAR & CAP FD. @ 58.00'

BAR & CAP SET @ THE NE CORNER OF THE SE QTR OF SEC 14

WEST LINE OF THE SE QTR

N 00°03'04" E 2386.91'

S 00°30'30" E 2675.04'

EAST LINE OF THE SE QTR

RPF LIMITED PARTNERSHIP, AN OHIO LIMITED PARTNERSHIP O.R. 2030, P-113

N 89°55'08" W 154.67'

N 00°02'00" E 280.74' TOTAL

FD. @ 29.62'

FD. @ 29.20'

SOUTH LINE OF THE SE QTR

S 89°59'38" W 2519.43'

PK NAIL FD. @ THE SE CORNER OF THE SE QTR OF SEC 14

1/2" IRON PIPE FD. @ 25.27'

TAYLORTOWN RD. C.R. 200

23 23

23 24

1/2" IRON PIPE FD. @ THE SW CORNER OF THE SE QTR OF SEC 14

**SHAFFER, JOHNSTON, LICHTENWALTER
& ASSOCIATES, INC.
ENGINEERS & SURVEYORS**

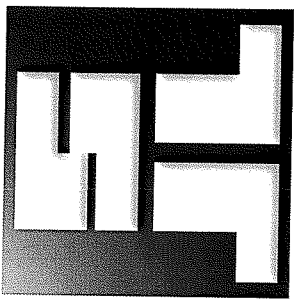

Boundary description of a **162.156** acre parcel

Job No. SM-2090

Situated in the Township of Jackson, County of Richland, State of Ohio and known as being a part of the Southeast Quarter, Section 14, T-22 N; R-19 W, also known as being a part of lands conveyed to Shelby Land Company LTD an Ohio LTD in Official Record Volume 1368, Page 310 and further bound and described as follows:

BEGINNING at a 5/8 inch iron bar with ident cap "Kerg" found and also known as the Northwest corner of the Southeast Quarter of Section 14, Jackson Township;

THENCE WITH THE FOLLOWING SEVEN (7) COURSES:

- 1) **N 89° 54' 31" E, 1305.87** feet along the Quarter Section Line and the Grantors' north line to a railroad spike found in Laser Road, (Township Road 210), and witnessed by a 5/8 inch iron bar with ident cap "Kerg" found 58.00 feet southwest on line and witnessed by a 5/8 inch iron bar with ident cap found N 89° 46' 33" E, 30.00 feet,
- 2) **N 89° 46' 33" E, 1342.21** feet along the Quarter Section Line and the Grantors' north line to a capped iron bar set at the Northeast Corner of the Southeast Quarter of Section 14, Jackson Township,
- 3) **S 00° 30' 30" E, 2675.04** feet along the Section Line and the Grantors' east line to a PK nail found in Taylortown Road, (County Road 200), and witnessed by a 1/2 inch iron pipe found 25.27 feet northwest on line,
- 4) **S 89° 59' 38" W, 2519.43** feet along the Section Line and the Grantors' south line and with Taylortown Road to a point witnessed by a 5/8 inch iron bar with ident cap "PS 7016" found N 00° 02' 00" E, 29.20 feet,
- 5) **N 00° 02' 00" E, 280.74** feet along the Grantors' west line and the east line of the lands of RPF Limited Partnership an Ohio Limited Partnership, (O.R. V-2030, P-113), to a 5/8 inch iron bar with ident cap "PS 7016" found,

Boundary description of a **162.156** acre parcel continued;

- 6) **N 89° 55' 08" W, 154.67** feet along the Grantors' south line and the north line of the said RPF Limited Partnership to a 5/8 inch iron bar with ident cap "PS 7016" found on the West Quarter Section Line,
- 7) **N 00° 03' 04" E, 2386.91** feet along the Quarter Section Line and the Grantors' west line to a 5/8 inch iron bar with ident cap "Kerg" found and the true place of beginning and containing within said bounds **162.156** acres of land, more or less, and subject to all legal highways and easements of record.

Basis of Bearings are relative to Grid North of the Ohio State Plane Coordinate System, NAD 83 Datum.

According to a survey made in November 2013 by Jason J. Lingenfelter, Ohio Professional Surveyor No. 8499.

All iron pins set are 5/8" diameter rod with plastic cap stamped "SJL, INC".



Jason J. Lingenfelter

Professional Surveyor No. 8499
November 27, 2013

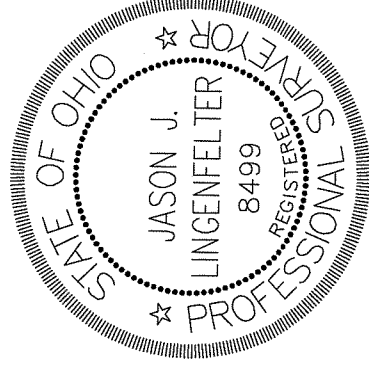

NEW SURVEY
OF EXISTING PARCEL
RICHLAND COUNTY.
TAX MAP OFFICE

EAL 10-19-13
INITIAL DATE
EE-308