

DRAFTED BY K.E. MCCARTNEY & ASSOCIATES INC., JOB TITLE: SV-401A SHEET NAME: Plat SCALE: 1=100 DATE: 6/4/13

BIXLER ROAD (T.H. 412, 50' R/W)

P.O.B. 1 POORMAN ROAD (T.H. 415) 30' R/W  
507.01'

S 86°14'01" E

P.O.B. 2 280.84'

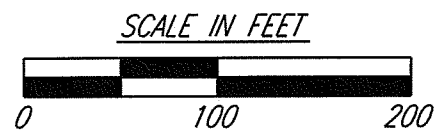

- LEGEND:**
- SURVEY MARKER SET WITH CAP STAMPED "MCCARTNEY S-7921" (5/8" DIA. x 30" LONG).
  - ⊕ MAG SPIKE SET, 2"-LONG
  - 1" PIPE FOUND
  - △ R.R. SPIKE FOUND
  - CORNER POST FOUND



CHARLES D. WISE & PATRICIA L. WISE  
O.R.V. 1643, PAGE 617

KIP WISE & JILL WISE  
O.R.V. 1761, PAGE 83

JOHN & RHONDA  
STUEMUND  
O.R.V. 846, PAGE 754

O.R.V. 1757, PAGE 694  
200.27'

N 00°28'03" W, 771.95'  
W. LINE, S.W. 1/4, SECTION 9

PARCEL 1  
8.2720 AC.

PARCEL 2  
9.5713 AC.

REF=30.00'  
REF=30.04'  
REF=30.04'  
734.04'  
N 03°45'59" E  
25' Building Setback (Typ.)

NEW SPLIT  
RICHLAND COUNTY  
TAX MAP OFFICE  
EAK 6-21-13  
INITIAL DATE  
EE-140

*Brian P. McCartney*  
BRIAN P. MCCARTNEY, P.E., P.S.  
OHIO REGISTERED PROFESSIONAL SURVEYOR  
NO. S-7957 MARCH, 2006  
For K.E. McCartney & Associates, Inc.

NEW SURVEY  
OF EXISTING PARCEL  
RICHLAND COUNTY  
TAX MAP OFFICE  
EAK 6-21-13  
INITIAL DATE  
EE-140

*Nathaniel B. Ramsey*  
NATHANIEL B. RAMSEY, P.S.  
OHIO REGISTERED PROFESSIONAL SURVEYOR  
NO. S-8396 JUNE, 2013  
For K.E. McCartney & Associates, Inc.

KENT B. HORN AND PATRICIA A. HORNE  
O.R.V. 277, PAGE 113

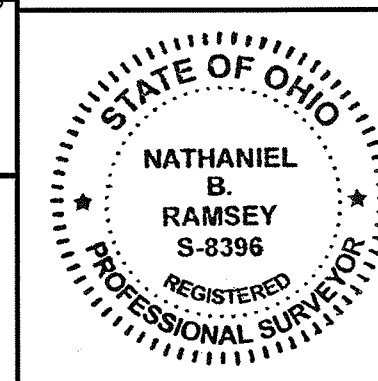

S.W. CORNER 451.44'  
SECTION 9 S. LINE, S.W. 1/4, SECTION 9

S 89°13'01" W, 1274.51'

**BASIS OF BEARINGS:** BEARINGS ARE TO AN ASSUMED MERIDIAN USED TO DELINEATE ANGLES ONLY. **PRIOR DEED REFERENCE:** O.R.V. 1643, PG. 617

52 N. Diamond Street  
Mansfield, Ohio 44902  
419/525-0093, Fax: 419/525-0635



230 Third Street  
Elyria, Ohio 44035  
440/323-9608, Fax: 440/323-3644

**K.E. McCartney & Associates, Inc.**

Engineers • Planners • Surveyors

**SURVEY PLAT FOR CHARLES D. WISE**

PART OF THE SOUTHWEST QUARTER OF SECTION 9, T-19-N, R-18-W,  
TOWNSHIP OF JEFFERSON, COUNTY OF RICHLAND, STATE OF OHIO

THIS PLAT WAS PREPARED FROM  
AN ACTUAL FIELD SURVEY  
PERFORMED BY K.E. MCCARTNEY  
AND ASSOCIATES, INC. IN MARCH  
2006 AND JUNE 2013

# KEM

## K.E. McCartney & Associates, Inc.

### Engineers • Planners • Surveyors

SY-401  
6-12-13

LEGAL DESCRIPTION  
CHARLES D. WISE AND PATRICIA L. WISE  
PARCEL 1 - 8.2720 AC.

Situated in the Township of Jefferson, County of Richland, State of Ohio and being part of the southwest quarter of Section 9, Township 19-N, Range 18-W and further described as follows:

Beginning for the same at a railroad spike found on the west line of the southwest quarter of Section 9, and accepted as marking the intersection of Bixler Road (T.H. 412, 50' R/W) and Poorman Road (T.H. 415, 30' R/W);

Thence, the following FOUR courses:

1. **South 86 degrees 14 minutes 01 second East, 507.01 feet** along said centerline of Poorman Road (T.H. 415), to a Magnail spike set;
2. **South 03 degrees 45 minutes 59 seconds West, 734.04 feet** to a survey marker set on the south line of Section 9 and passing for reference a survey marker set at 30.00 feet;
3. **South 89 degrees 13 minutes 01 second West, 451.44 feet** along said south line of Section 9 to a corner post found and accepted as marking the southwest corner of said Section;
4. **North 00 degrees 28 minutes 03 seconds West, 771.95 feet** along the west line of Section 9 to the **Point of Beginning**; Enclosing an area of 8.2720 acres, more or less, being subject to all legal easements, use restrictions and public right of ways now on record.

This description was prepared by Brian P. McCartney, P.E., P.S. S-7957 from an actual field survey performed by K.E. McCartney and Associates, Inc., in March, 2006 and June, 2013.

Survey markers set are 5/8" diameter by 30" long rebar with cap stamped "McCartney S-7921".

Basis of Bearings: The bearings referred to herein are to an assumed meridian and used to delineate angles only.

Prior Deed Reference: Official Record Volume 1643, Page 0617 of the Richland County Recorder's Office.

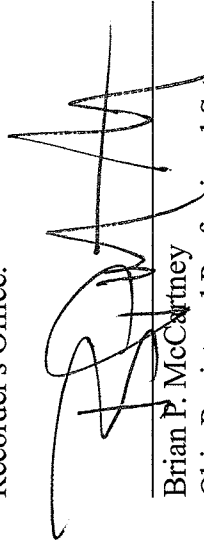

Brian P. McCartney  
Ohio Registered Professional Surveyor No. 7957  
for K.E. McCartney & Associates, Inc.

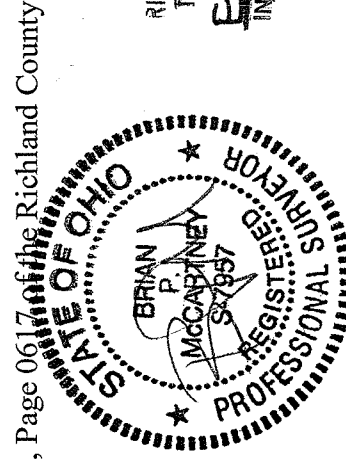

NEW SPLIT  
RICHLAND COUNTY  
TAX MAP OFFICE  
EAK 1072113  
INITIAL DATE  
EE-140



Nathaniel B. Ramsey  
Ohio Registered Professional Surveyor No. 8396  
for K.E. McCartney & Associates, Inc.



z:\kem projects\sy-401a\sy-401a\_p1.docx  
52 N. Diamond St. • Mansfield, OH 44902 • TEL. 419.525.0093 • FAX 419.525.0635  
52 N. Diamond St. • Mansfield, OH 44902 • TEL. 419.525.0093 • FAX 419.525.0635

Brian P. McCartney, P.E., P.S. • Kenneth A. McCartney, P.S. • James D. Mawhorr, P.E., P.S. • Wayne C. Bishop, P.E.

KEM  
Quality  
since 1978

**KEM**

---

**K.E. McCartney & Associates, Inc.**

---

***Engineers • Planners • Surveyors***

SY-401A  
6-20-13

LEGAL DESCRIPTION  
CHARLES D. WISE AND PATRICIA L. WISE  
PARCEL 2 -9.5713 AC.

Situated in the Township of Jefferson, County of Richland, State of Ohio and being part of the southwest quarter of Section 9, Township 19-N, Range 18-W and further described as follows:

Commencing at a railroad spike found on the west line of the southwest quarter of Section 9, and accepted as marking the intersection of Bixler Road (T.H. 412, 50' R/W) and Poorman Road (T.H. 415, 30' R/W); Thence, **South 86 degrees 14 minutes 01 second East, 507.01 feet** along the centerline of said Poorman Road (T.H. 415) to a Magnail spike set, said Magnail spike being the **Place of Beginning** of the parcel herein described;

Thence, the following **SIX** courses:

1. **South 86 degrees 14 minutes 01 second East, 280.84 feet** continuing along said centerline of Poorman Road (T.H. 415) to a Magnail spike set in the northwest corner of a parcel conveyed to Kip Wise and Jill Wise by O.R.V. 1761. Page 83;
2. **South 00 degrees 38 minutes 23 seconds West, 308.45 feet** along the west line of said Kip & Jill Wise parcel to a survey marker set in the southwest corner thereof, and passing for reference a survey marker set at 30.04 feet;
3. **North 89 degrees 13 minutes 01 second East, 495.46 feet** along the south line of said Kip & Jill Wise parcel and along the south line of a parcel conveyed to John Studemund and Rhonda Studemund by O.R.V. 1757, Page 694 to survey marker set in the southeast corner of said Studemund parcel, said survey marker also being on the west line of a parcel conveyed to Kent B. Horne and Patricia A. Horne by O.R.V. 277, Page 113;
4. **South 00 degrees 22 minutes 01 second East, 401.11 feet** along said west line of said Horne parcel to a 1" pipe found in the southwest corner thereof, said pipe also being on the south line of said Section 9;
5. **South 89 degrees 13 minutes 01 second West, 823.07 feet** along said south line of Section 9 to a survey marker set;

52 N. Diamond St. • Mansfield, OH 44902 • TEL. 419.525.0093 • FAX 419.525.0635  
52 N. Diamond St. • Mansfield, OH 44902 • TEL. 419.525.0093 • FAX 419.525.0635

Brian P. McCartney, P.E., P.S. • Kenneth A. McCartney, P.S. • James D. Mawhort, P.E., P.S. • Wayne C. Bishop, P.E.

**KEM**  
*Quality*  
since 1978

6. North 03 degrees 45 minutes 59 seconds East, 734.04 feet to the Place of Beginning, and passing for reference a survey marker set at 704.04 feet. Enclosing an area of 9.5713 acres, more or less, being subject to a 2.5' building setback requirement, all legal easements, use restrictions and public right of ways now on record.

This description was prepared by Brian P. McCartney, P.E., P.S. S-7957 from an actual field survey performed by K.E. McCartney and Associates, Inc., in March, 2006 and June, 2013. Survey markers set are 5/8" diameter by 30" long rebar with cap stamped "McCartney S-7921".

Basis of Bearings: The bearings referred to herein are to an assumed meridian and used to delineate angles only.

Prior Deed Reference: Official Record Volume 1643, Page 0617.

All deeds referred to are recorded in the Richland County Recorder's Office.

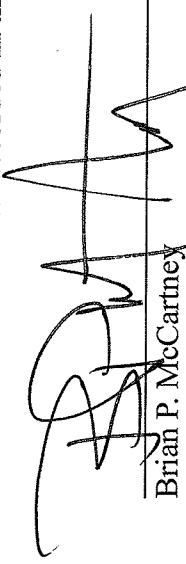

Brian P. McCartney  
Ohio Registered Professional Surveyor No. 7957  
for K.E. McCartney & Associates, Inc.

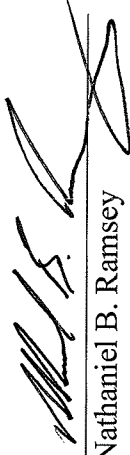
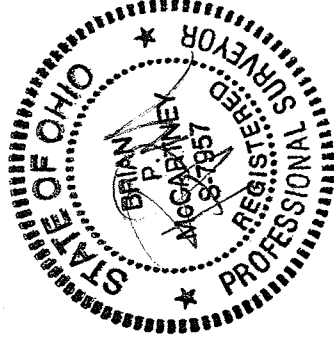

Nathaniel B. Ramsey  
Ohio Registered Professional Surveyor No. 8396  
for K.E. McCartney & Associates, Inc.

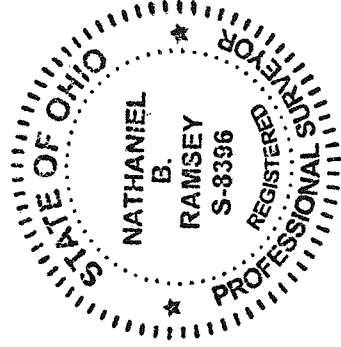

NEW SURVEY  
OF EXISTING PARCEL  
RICHLAND COUNTY  
TAX MAP OFFICE

FAK 10-21-13  
INITIAL DATE  
EE-140

z:\kem projects\sy-401a\sy-401a\_p2.docx  
52 N. Diamond St. • Mansfield, OH 44902 • TEL. 419.525.0093 • FAX 419.525.0635  
52 N. Diamond St. • Mansfield, OH 44902 • TEL. 419.525.0093 • FAX 419.525.0635

Brian P. McCartney, P.E., P.S. • Kenneth A. McCartney, P.S. • James D. Mawhorr, P.E., P.S. • Wayne C. Bishop, P.E.

**KEM**  
*Quality*  
since 1978