

**SHAFFER, JOHNSTON, LICHTENWALTER
& ASSOCIATES, INC.
ENGINEERS & SURVEYORS**

Boundary description of an 8.705 acre parcel

Job No. SM-2071

Situated in the Township of Washington, County of Richland, State of Ohio and known as being a part of Northeast Quarter, Section 22, T-20 N; R-18 W, also known as being a part of lands conveyed to Frederick W. & Terry L. Beer in Official Record Volume 793, Page 297 and further bound and described as follows:

Commencing at a railroad spike found in Touby Road, (Township Road 327), and known as the Northeast Corner of the Northeast Quarter, Section 22, Washington Township;

Thence S 00° 00' 00" E, 551.97 feet along the East Section Line and with Touby Road to a point witnessed by a capped iron bar set N 89° 59' 33" W a distance of 25.00 feet and the True Place of Beginning;

THENCE WITH THE FOLLOWING SIX (6) COURSES:

- 1) **S 00° 00' 00" E, 555.89** feet along the Section Line and with Touby Road to a MAG nail found and witnessed by a 5/8 inch iron bar with ident cap "Blunk" found N 88° 57' 17" W a distance of 25.00 feet,
- 2) **N 88° 57' 17" W, 530.00** feet along the Grantors' south line and the north line of the lands of Aaron W. & Lisa J. Beer, (O.R. V-793, P-295), to a 5/8 inch iron bar with ident cap "Blunk" found,
- 3) **S 00° 00' 00" E, 118.15** feet along the Grantors' east line and the west line of the said Beer lands to a capped iron bar set,
- 4) **N 89° 59' 33" W, 127.92** feet to a 5/8 inch iron bar with ident cap "Blunk" found,
- 5) **N 00° 34' 01" W, 664.47** feet along the Grantors' west line and the east line of the lands of Fisteks Arts, LLC, (O.R. V-2117, P-617), to a 5/8 inch iron bar with ident cap "Blunk" found,
- 6) **S 89° 59' 33" E, 664.41** feet in part along the Grantors' north line and the south line of the lands of Fisteks Arts, LLC, (O.R. V-2155, P-81), to a point on the East Section Line and in Touby Road and the true place of beginning and containing within said bounds **8.705** acres of land, more or less, and subject to all legal highways and easements of record.

Boundary description of an 8.705 acre parcel continued;

Basis of Bearings: Bearings from Survey "F-2-300".

According to a survey made on May 17th, 2013 by Jason J. Lingenfelter, Ohio Professional Surveyor No. 8499.

All iron pins set are 5/8" diameter rod with plastic cap stamped "SJL, INC".

Jason J. Lingenfelter
Professional Surveyor No. 8499
May 17, 2013

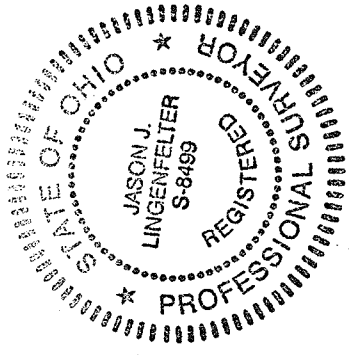

APPROVED

This is to certify that the attached survey meets the 75 Road, Frontage Requirement

Zoning Inspector Washington Township DATE 5-28-13

WASHINGTON TWP. ZONING

R.I.

ZONING INSPECTOR DATE

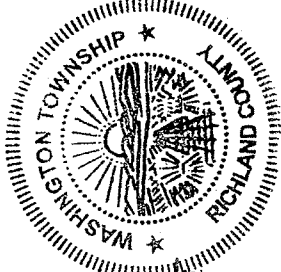

NEW SPLIT
RICHLAND COUNTY
TAX MAP OFFICE
EAK INITIAL DATE
EE-115 5-29-13

ADDRESS ASSIGNMENT
 NEW ADDRESS 2900 TORBY RD
 PRESENT ADDRESS

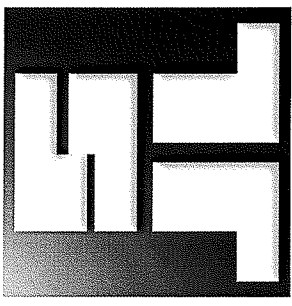
Washington Zoning Inspector Date



**SHAFFER, JOHNSTON, LICHTENWALTER
& ASSOCIATES, INC.
ENGINEERS & SURVEYORS**

Boundary description of a 6.884 acre parcel

Job No. SM-2071

Situated in the Township of Washington, County of Richland, State of Ohio and known as being a part of Northeast Quarter, Section 22, T-20 N; R-18 W, also known as being a part of lands conveyed to Frederick W. & Terry L. Beer in Official Record Volume 793, Page 297 and further bound and described as follows:

Beginning at a railroad spike found in Touby Road, (Township Road 327), and known as the Northeast Corner of the Northeast Quarter, Section 22, Washington Township;

THENCE WITH THE FOLLOWING FOUR (4) COURSES:

- 1) **S 00° 00' 00" E, 551.97** feet along the East Section Line and with Touby Road to a point witnessed by a capped iron bar set N 89° 59' 33" W a distance of 25.00 feet,
- 2) **N 89° 59' 33" W, 540.54** feet to a 5/8 inch iron bar with ident cap "Blunk" found,
- 3) **N 00° 34' 01" W, 552.00** feet along the Grantors' west line and the east line of the lands of Fisteks Arts, LLC, (O.R. V-2155, P-81), to a 5/8 inch iron bar with ident cap Blunk" found on the North Section Line,
- 4) **S 89° 59' 33" E, 546.00** feet along the Section to a railroad spike found in Touby Road and witnessed by a 5/8 inch iron bar with ident cap "Blunk" found 25.00 feet northwest on line and the true place of beginning and containing within said bounds **6.884** acres of land, more or less, and subject to all legal highways and easements of record.

Basis of Bearings: Bearings from Survey "F-2-300".

All iron pins set are 5/8" diameter rod with plastic cap stamped "SJL, INC".

According to a survey made on May 17th, 2013 by Jason J. Lingenfelter, Ohio Professional Surveyor No. 8499.

NEW SPLIT
RICHLAND COUNTY
TAX MAP OFFICE

INITIAL DATE
EE-115
5-29-13

Jason J. Lingenfelter
Professional Surveyor No. 8499
May 17, 2013

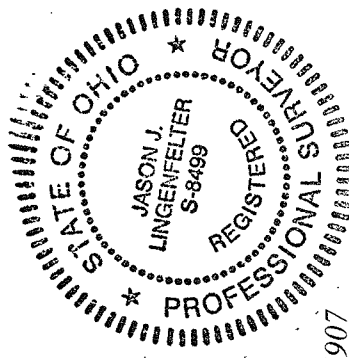

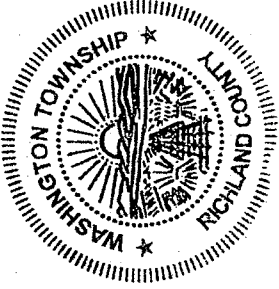

APPROVED

This is to certify that the attached survey meets the 75 Road Frontage Requirement.

[Signature]
Zoning Inspector Washington Township DATE

WASHINGTON TWP. ZONING
R-1

[Signature]
ZONING INSPECTOR DATE

ADDRESS ASSIGNMENT
 NEW ADDRESS 2860 LOUBY
 PRESENT ADDRESS
[Signature]
Washington Zoning Inspector Date