

PLAT OF PROPERTY.

DOUGLAS G. & MARILYN E. HEDRICKS
 PART OF THE SOUTHEAST QUARTER OF SECTION SEVEN(7)
 TOWNSHIP TWENTY-THREE(23), RANGE SEVENTEEN(17)
 MIFFLIN TOWNSHIP, RICHLAND COUNTY, OHIO

DUE SOUTH
30.00'

DUE WEST 701.25'
 N.LINE, SE 1/4, SEC. 7
 DUE EAST 646.00'
 30' ROAD R/W

MERRYWOOD LANE-60'
(VACATED VOL.38/392)

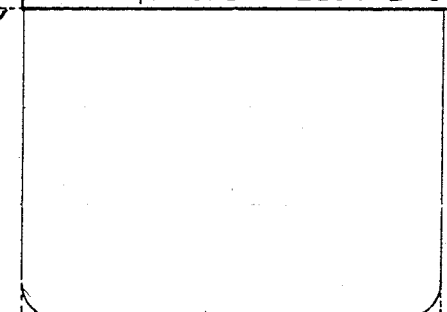

CURVE INFO.
 Δ - 90°15'39"
 R - 25.00'
 L - 39.38'
 CH - S 44°52'11"E
 35.44'

WOODMONT RD. - 60'

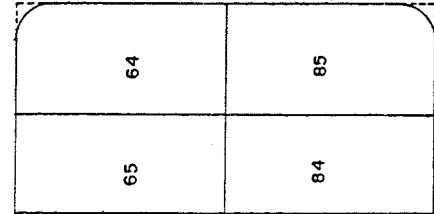

19.677 ACRES
 M.L. CAMPBELL
 D. 372/87

DUE EAST 50.00'
 DUE NORTH 340.00'
 CURVE INFO
 Δ - 90°00'00"
 R - 25.00'
 L - 39.27'
 CH - N 45°00'00"E
 35.35'

LANE - 60'

SCALE: 1" = 100'

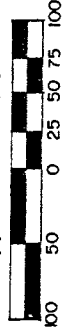

BEARINGS ARE BASED ON PLAT 18 /158.

FARMDALE RD-60'

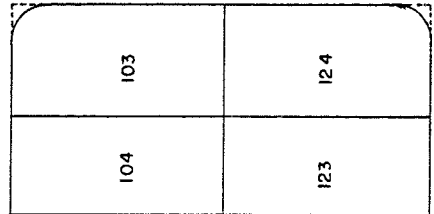

MERRYWOOD

DUE EAST 50.00'
 DUE WEST 60.00'
 DUE NORTH 570.00'
 CURVE INFO
 Δ - 90°00'00"
 R - 25.00'
 L - 39.27'
 CH - N 45°00'00"W
 35.35'

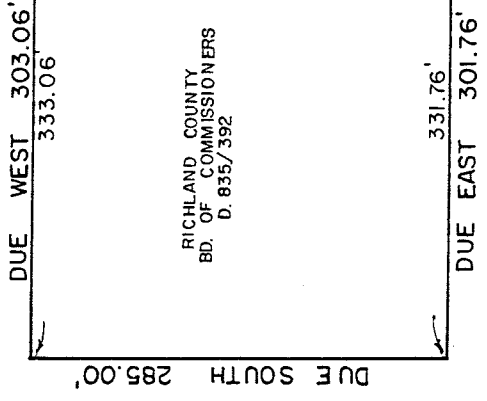

HOUT RD. - 60'

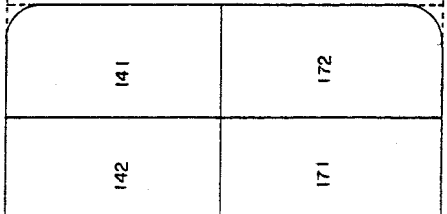

DUE EAST 75.00'
 DUE WEST 60.00'
 DUE NORTH 287.90'
 (VACATED VOL.38/392)

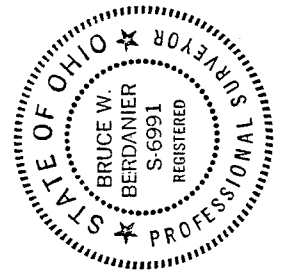

NOTE: THIS PLAT IS BASED ON A SURVEY PERFORMED BY CHARLES BLOSSER ON DEC. 19, 1955, FOR THE ORIGINAL PLATTING OF CRESTWOOD HILLS AS RECORDED IN PLAT 18/158. FIELD MEASUREMENTS WERE OBSERVED TO VERIFY THAT RECORDED PLAT DIMENSIONS FIT EXISTING FIELD CONDITIONS.

PREPARED BY
 F. E. KROCKA & ASSOCIATES
Bruce W. Berdanier
 BRUCE W BERDANIER
 OHIO REGISTERED SURVEYOR NO. 6991
 DATE: JANUARY 20, 1988

N 89° 36' 10" W 715.09'
 30' ROAD R/W

CURVE INFO
 Δ - 90°08'11"
 R - 25.00'
 L - 39.33'
 CH - S 45°19'44"W
 35.40'