

WASHINGTON TWP. ZONING

ADDRESS ASSIGNMENT

NEW ADDRESS 1865 Kochheiser

APPROVED

This is to certify that the attached survey meets the 25 Road Frontage Requirement.

ZONING INSPECTOR [Signature] DATE 5/29/12

Washington Zoning Inspector Date

Zoning Inspector [Signature] Washington Township DATE 5/29/12

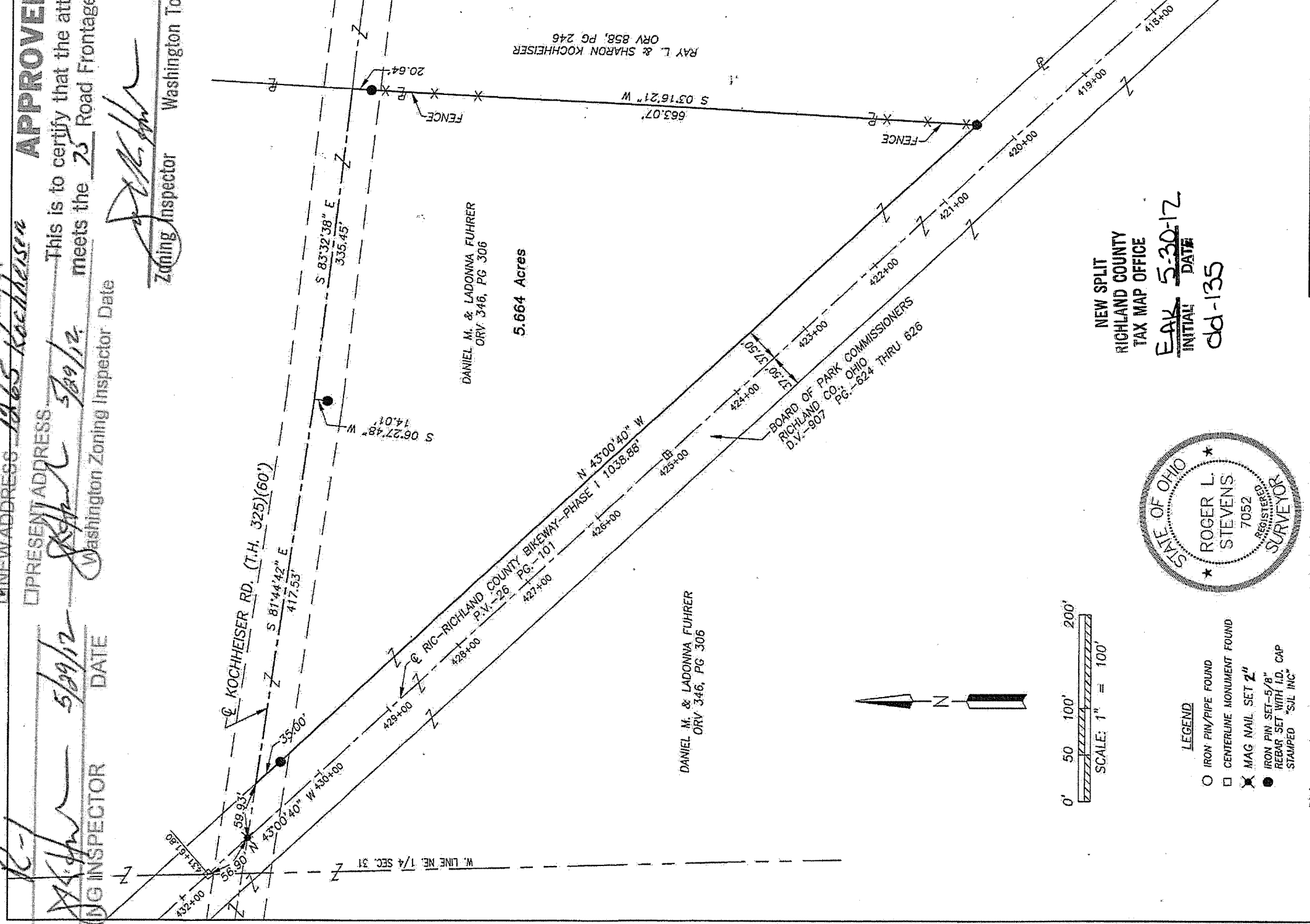

NEW SPLIT  
RICHLAND COUNTY  
TAX MAP OFFICE  
EAK INITIAL dd DATE 5-30-12  
dd-135

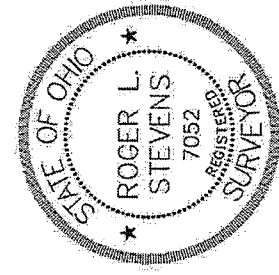

- LEGEND
- IRON PIN/PIPE FOUND
  - CENTERLINE MONUMENT FOUND
  - ✕ MAG NAIL SET 2"
  - IRON PIN SET-5/8" REBAR SET WITH I.D. CAP STAMPED "SUL INC"

Distances shown hereon are expressed in feet and decimal parts thereof.  
Bearings are to an assumed meridian and are used to express angles only.

CERTIFICATION: I hereby state that the foregoing survey was prepared from actual field measurements, in accordance with Chapter 4733-37, Ohio Administrative Code.

By: [Signature] Date 5-25-12  
Roger L. Stevens, P.S. #7052  
for Shafter, Johnston, Lichtenwalter,  
& Associates, Inc.

**SHAFTER, JOHNSTON, LICHTENWALTER & ASSOCIATES, INC.**  
Consulting Engineers & Surveyors  
909 South Main Street Mansfield, Ohio 44607  
TEL (419) 756-7202  
FAX (419) 756-0867 EMAIL [arcm59@sjl-inc.com](mailto:arcm59@sjl-inc.com)

SURVEY MADE AT THE REQUEST OF:  
**DANIEL & LADONNA FUHRER**  
PART OF THE NORTHEAST QUARTER  
OF SECTION 31, WASHINGTON TOWNSHIP  
T-20 N. R-18 W  
RICHLAND COUNTY, OHIO

DRAWN BY	SCALE	DATE	SHEET
SH	1" = 100'	05/25/2012	1 OF 1
ORDER NO.	JOB NO.	TOWNSHIP	SECTION
SM-19444A	SM-19444	WASHINGTON	31

**SHAFFER, JOHNSTON, LICHTENWALTER  
& ASSOCIATES, INC.  
ENGINEERS & SURVEYORS**

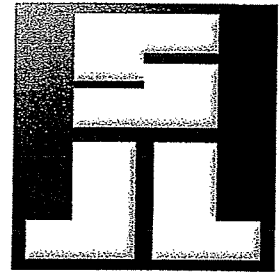

May 25, 2012

**LEGAL DESCRIPTION**

**5.664 ACRES**

**PART NE QUARTER SECTION 31  
WASHINGTON TOWNSHIP  
RICHLAND COUNTY, OHIO**

Situated in the Township of Washington, County of Richland, State of Ohio, being a part of the Northeast Quarter of Section 31, Township 20 North, Range 18 West, and being part of the land conveyed to Daniel M. and LaDonna Fuhrer by official record volume 0346, page 0306 of the Richland County Recorders records, and being more particularly described as follows:

**Commencing** at a monument box found marking the intersection of the west line of said Northeast Quarter and the centerline of Ric-Richland County Bikeway-Phase 1 as recorded in plat volume 26, page 101;

Thence South 43 degrees 00 minutes 40 seconds East, 56.90 feet along said centerline of Ric-Richland County Bikeway-Phase 1 to a mag nail set in the centerline of Kochheiser Road (T.H. 325), said mag nail being referenced by a monument box found North 43 degrees 00 minutes 40 seconds West from said point;

Thence South 81 degrees 44 minutes 42 seconds East, 59.93 feet along said centerline of Kochheiser Road (T.H. 325), 56.90 feet to a point being in the northeasterly right of way line of line of Ric-Richland County Bikeway-Phase 1, said point being referenced by an iron pin set South 43 degrees 00 minutes 40 seconds East, 35.00 feet from said point and being the **true place of beginning** of the parcel herein described;

Thence, the following **FOUR** courses:

1. **South 81 degrees 44 minutes 42 seconds East, 417.53 feet** along said centerline of Kochheiser Road (T.H. 325) to a point, said point being reference by an iron pin set South 06 degrees 27 minutes 48 seconds West, 14.01 feet from said point;
2. **South 83 degrees 32 minutes 38 seconds East, 335.45 feet** and continuing along said centerline of Kochheiser Road (T.H. 325) to a point being in the west line of a parcel of

909 South Main Street Mansfield, Ohio 44907  
Ph. (419) 756-7302 Fax (419) 756-0867

5.664 AC"

land conveyed to Ray L. and Sharon Kochheiser by official record volume 0858, page 0246;

- 3. **South 03 degrees 16 minutes 21 seconds West, 663.07 feet** along said west line of said land of Ray L. and Sharon Kochheiser to an iron pin set in said northeasterly right of way line of Ric-Richland County Bikeway-Phase 1 and passing through an iron pin set at 20.64 feet;
- 4. **North 43 degree 00 minutes 40 seconds West, 1,038.88 feet** along said northeasterly right of way line of Ric-Richland County Bikeway-Phase 1 to the true place of beginning, containing 5.664 acres, more or less, and subject to all legal highways and easements of record.

Bearings recited herein are to an assumed meridian and are used to express angles only.

According to a survey made in May 2012 by Roger L. Stevens, Ohio Registered Professional Surveyor No. 7052.

All iron pins set are 5/8" diameter rod with plastic cap stamped "SJL INC".

*Roger L. Stevens*

Roger L. Stevens  
Professional Surveyor No. 7052  
SM-1944\_5.664 AC.doc



WASHINGTON TWP. ZONING

*R-1*

*[Signature]* 5/29/12  
ZONING INSPECTOR DATE

ADDRESS ASSIGNMENT

NEW ADDRESS *1365 Kochheiser Rd.*

PRESENT ADDRESS

*[Signature]* 5/29/12  
Washington Zoning Inspector DATE

NEW SPLIT  
RICHLAND COUNTY  
TAX MAP OFFICE

*EAK* 5-30-12  
INITIAL DATE

*dd-135*

**APPROVED**

This is to certify that the attached survey meets the 25 Road Frontage Requirement.

*[Signature]* 5/29/12  
Zoning Inspector Washington Township DATE