



THE CITY OF MANSFIELD
DEED VOLUME 743, PAGE 480

N 88°52'08" E 684.12'

REF=10.00'

N 02°22'02" W 640.12'

R. & C. BUTLER
O.R.V. 1625, PAGE 343

18.35 ACRES

J. & G. ROBERTS
DEED VOLUME 763,
PAGE 45

S 89°02'31" W
376.17'

N 00°41'00" W
350.75'

REF=33.14'

284.88'
S 89°04'03" W

THE SOUTH LINE
OF THE SE QTR.
SEC. 29

P. HEROLD
O.R.V. 1580, PAGE 307

S 00°42'55" E 1394.84'

ERNSBERGER ROAD (T.H. 234)

THE EAST LINE
OF THE SE QTR.
SEC. 29

BEARINGS ARE BASED ON AN ASSUMED
MERIDIAN AND ARE INTENDED TO BE
USED FOR ANGULAR DETERMINATION ONLY

NORTH

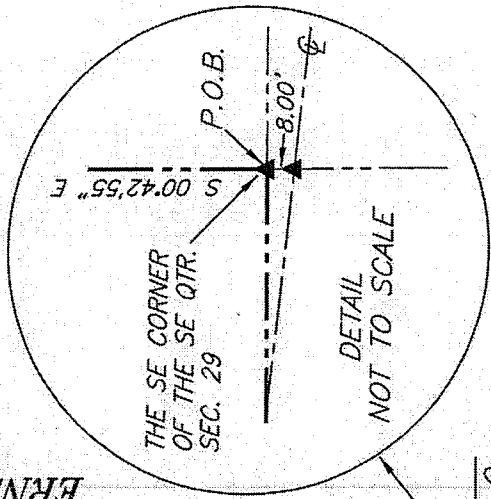

AMOY EAST ROAD (C.H. 90)

NEW SURVEY
OF EXISTING PARCEL
RICHLAND COUNTY
TAX MAP OFFICE

INITIAL **5-24-12**
DATE
dd-128

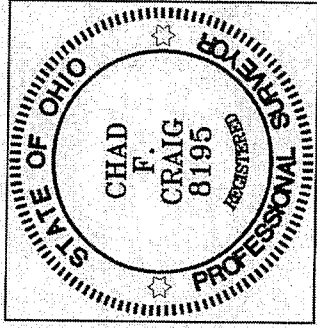

Chad F. Craig

SURVEY BY: CHAD F. CRAIG P.S. #8195
for SEILER & CRAIG SURVEYING INC.
52-1/2 NORTH MAIN STREET
MANSFIELD, OHIO 44902
(419) 525-3644
FAX (419) 525-3686

LEGEND

- IRON PIN FOUND
- ⊙ MAG NAIL SPIKE FOUND
- ⊗ 3" SURVEY MARKER SET
- △ RAILROAD SPIKE SET
- ▲ RAILROAD SPIKE FOUND
- ⊗ 5/8" IRON PIN SET WITH CAP STAMPED "CRAIG 8195"

SURVEY PLAT FOR
PROPERTY TRANSFER

PART SE QTR. SEC. 29, T-22, R-18
FRANKLIN TOWNSHIP
RICHLAND COUNTY, OHIO

DATE: MAY 16, 2012 SCALE: 1"=200'

AMOY_EAST_RD_DAWSON

SEILER & CRAIG SURVEYING, INC.

Douglas C. Seiler, PS & Chad F. Craig, PS
52 1/2 North Main Street
Mansfield, Ohio 44902
419-525-3644 Fax 419-525-3696
www.seilerandcraig.com

SURVEY DESCRIPTION

**PART OF THE SE QUARTER OF SECTION 29
FRANKLIN TOWNSHIP
RICHLAND COUNTY, OHIO**

Situated in the Township of Franklin, County of Richland, State of Ohio and being a part of the Southeast Quarter of Section 29, of Township 22 North, Range 18 West, and being more particularly described as follows:

Beginning for the same at a railroad spike found and accepted as marking the southeast corner of said quarter section; Thence, South 89 degrees 04 minutes 03 seconds West with the south line of said quarter section, a distance of 284.88 feet to a point referenced by an iron pin found on a bearing of North 00 degrees 41 minutes 00 seconds West and at a distance of 33.14 feet, said point being the southeast corner of a parcel currently owned by J. and G. Roberts (D.V. 763, Page: 45);

Thence, with said Roberts parcel the following two (2) courses and distances:

1. North 00 degrees 41 minutes 00 seconds West passing through said reference pin, a total distance of 350.75 feet to an iron pin found
2. South 89 degrees 02 minutes 31 seconds West 376.17 feet to an iron pin found on the east line of a parcel currently owned by P. Herold (O.R.V. 1580, Page: 307)

Thence, North 01 degree 23 minutes 56 seconds West with the east line of said Herold parcel a distance of 401.98 feet to an iron pin found on the northeast corner thereof, the same being the southeast corner of a parcel currently owned by R. and C. Butler (O.R.V. 1625, Page: 343);

Thence, North 02 degrees 22 minutes 02 seconds West with the east line of said Butler parcel a distance of 640.12 feet to an iron pin found marking the southwest corner of a parcel currently owned by The City of Mansfield (D.V. 743, Page: 480);

Thence, North 88 degrees 52 minutes 08 seconds East with the south line of said City of Mansfield parcel passing through an iron pin set for reference at 674.12, a total distance of 684.12 feet to a Mag Nail spike found on the east line of said quarter, the same being a point in Ernsberger Road (T.H. 234);

Thence, South 00 degrees 42 minutes 55 seconds East with said east line, a distance of 1394.84 feet to the place of beginning, containing 18.35 acres according to survey by Chad F. Craig P.S. #8195 for Seiler & Craig Surveying, Inc. on May 16, 2012, but subject to all easements and right of ways of record.

Iron pins set are 5/8" rods with caps stamped "CRAIG 8195".

Bearings are based on an assumed meridian and are intended to be used for angular determination only.

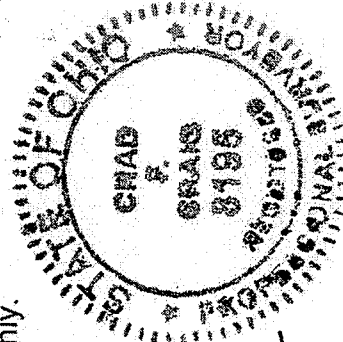

NEW SURVEY
OF EXISTING PARCEL
RICHLAND COUNTY
TAX MAP OFFICE

EAK 5-24-12
INITIAL DATE

cd-128

Chad F. Craig P.S.#8195
for Seiler & Craig Surveying, Inc.