

PLAT OF PROPERTY SURVEY AT THE REQUEST OF  
**JEFFREY S. GORMAN**  
 PART OF THE NORTHWEST QUARTER OF SECTION TWENTY-SEVEN (27)  
 TOWNSHIP TWENTY-THREE (23), RANGE SEVENTEEN (17)  
 MIFFLIN TOWNSHIP, RICHLAND COUNTY, OHIO

MICHELE SPOGNARDI  
 GORMAN TRUST  
 O.R.V. 1818, P. 177

TERRY A. FRAKER, ET. AL.  
 O.R.V. 125, P. 485

MAX I. AND  
 CYNTHIA A. ARNOLD  
 O.R.V. 1927, P. 805

LEE A. AND  
 KELLY J. SHULL  
 O.R.V. 1057, P. 386

DONALD W. AND  
 TERESA B. MAGEE  
 O.R.V. 558, P. 38  
 16.179 AC.  
 (12.6082 REMAINING)

WILLIAM H. AND  
 EDNA N. HARRY  
 O.R.V. 254, P. 266

PETERSON ROAD (T.H. 295)

N.W. COR.,  
 N.W. QTR.,  
 SEC. 27

W. LINE, N.W. QTR., SEC. 27  
 S 03°35'36" E 1791.14'  
 PUGH ROAD (T.H. 299)

DONALD R. AND  
 PATRICIA R.  
 SAYLOR  
 O.R.V. 1884,  
 P. 482

200.00'  
 30.00'  
 347.25'  
 N 88°06'30" E

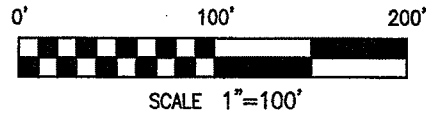

**BASIS OF BEARINGS**  
 BEARINGS ARE BASED ON AN ASSUMED MERIDIAN  
 AND ARE USED TO EXPRESS ANGLES ONLY.

N 86°50'36" E  
 553.97'

N 03°15'36" W  
 244.69'

N 85°16'57" W 551.63'

S 01°53'14" E  
 320.34'  
 867.48'

**3.5708 ACRES**

NEW SPLIT  
 RICHLAND COUNTY  
 TAX MAP OFFICE

EAK 1-4-12  
 INITIAL DATE  
 DD-1

**REFERENCE MATERIAL**  
 TAX MAPS  
 DEEDS LISTED HEREON  
 SURVEY FILES; D-177, J-76, F-1-84

**LEGEND**

- 5/8" DIA. x 30" LONG REBAR SET WITH PLASTIC CAP STAMPED "WEIGLER 7747"
- ◆ 2 1/2" MAG NAIL SET
- ⊙ REBAR FOUND WITH CAP STAMPED "SEILER 6869"
- △ RAILROAD SPIKE FOUND
- 3/4" IRON PIPE FOUND
- ⊗ 5/8" REBAR FOUND

CERTIFICATION: I HEREBY CERTIFY THAT THE FOREGOING SURVEY WAS PREPARED FROM ACTUAL FIELD MEASUREMENTS IN ACCORDANCE WITH CHAPTER 4733-37, OHIO ADMINISTRATIVE CODE.

PREPARED BY  
**WEIGLER LAND SURVEYING, LTD.**

GARY E. WEIGLER  
 OHIO REGISTERED SURVEYOR NO. 7747  
 DATE: DECEMBER 21, 2011  
 FILE NO. 11038

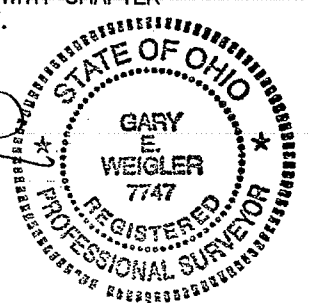

EXIST. RESIDENCE

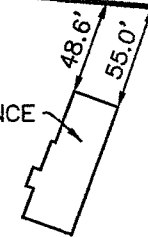



**Weigler Land Surveying, Ltd.**  
 513 Amoy East Road, Mansfield, Ohio 44903  
 Phone and Fax (419) 747-7155

11038

**DESCRIPTION**  
**3.5708 ACRES**

Situated in the State of Ohio, County of Richland, Township of Mifflin, being part of the northwest quarter of Section Twenty-seven (27), Township Twenty-three (23), Range Seventeen (17), and being lands now or formerly owned by Donald W. and Teresa B. Magee as recorded in Official Record Volume 558, Page 38 of the Richland County Recorder's Records and being more particularly described as follows:

**Commencing** at a railroad spike found marking the northwest corner of the northwest quarter of Section 27, said rebar being in the intersection of the centerlines of Peterson Road (Township Highway 295) and Pugh Road (Township Highway 299);

Thence South 03°35'36" East, 1791.14 feet with the west line of said quarter and the centerline of Pugh Road to a mag nail set, said mag nail marks the northwest corner of said Magee lands, and being referenced by a 5/8" rebar found North 88°06'30" East, 30.00 feet;

Thence North 88°06'30" East, 347.25 feet with the north line of said Magee lands to a rebar with cap stamped "Seiler 6869" found;

Thence North 74°33'18" East, 390.27 feet with the north line of said Magee lands to a rebar with cap stamped "Seiler 6869" found marking the **POINT OF BEGINNING** for the parcel herein described, said rebar also marking the southeast corner of lands now or formerly owned by Lee A. and Kelly J. Shull as recrded in Official Record Volume 1057, Page 386 of the Richland County Recorder's Records;

Thence with the following Four (4) courses;

1. North 03°15'36" West, 244.69 feet with the east line of said Shull lands to a 5/8" rebar found in the south line of lands now or formerly owned by Terry A. Fraker as recorded in Official Record Volume 125, Page 485 of the Richland County Recorder's Records;
2. North 86°50'36" East, 553.97 feet with the south line of said Fraker lands and the south line of lands now or formerly owned by Michelle Spognardi Gorman Trust as recorded in Official Record Volume 1818, Page 177 of the Richland County Recorder's Records, to a rebar with cap stamped "Seiler 6869" found, passing through a 3/4" iron pipe found at 178.38 feet;
3. South 01°53'14" East, 320.34 feet with the east line of said Magee lands to a rebar set;
4. North 85°16'57" West, 551.63 feet to the point of beginning for the parcel herein described, containing 3.5708 acres, being subject to all legal easements, restrictions and rights-of-way now on record.

The Grantees, his heirs and assigns do hereby covenant and agree that the above described parcel of land or any portion thereof does not constitute a principal building site under the applicable zoning and will not be conveyed by said grantees, heirs and assigns independent and separate from any adjoining or contiguous parcel fronting on a public highway or street.

Bearings are based on an assumed meridian, and are used to express angles only.

All rebar set are 5/8" Dia. x 30" long with plastic cap stamped "Weigler 7747"

I hereby certify that this description is based upon an actual field survey made by Gary E. Weigler, Registered Surveyor No. 7747 and all monumentation was set or found as indicated.

Prior Deed Reference: Official Record Volume 558, Page 38

prepared by:  
**Weigler Land Surveying, Ltd.**

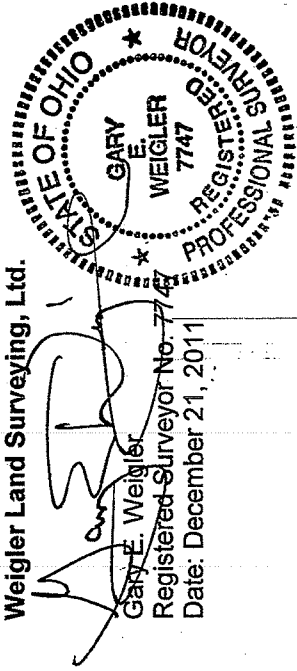

NEW SPLIT  
 RICHLAND COUNTY  
 TAX MAP OFFICE  
 INITIAL DATE  
 EAK 1-4-12  
 DD-1