

SURVEY FOR  
J. & L. BELTZELL  
RANGE 19, TOWNSHIP 21, S.W. QUARTER OF SECTION 13,  
VILLAGE OF ONTARIO, RICHLAND COUNTY, OHIO

Scale 1" = 60' Date 2-15-95 P.B. P. 827 D.V. 565 P. 172 Drawn By SPV

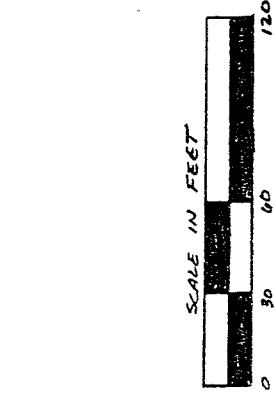

B-372

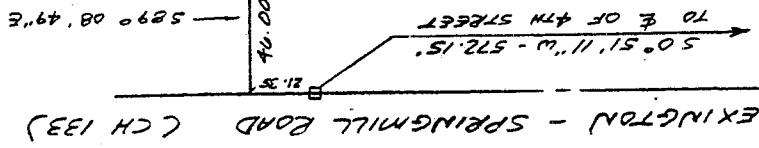

B.J. HUNT (D.V. 565 P. 172)

0.934 ACRES

LOT 1181  
WESTWOOD TRAK ALLOT.  
(P.B. 19 P. 24)

ROSEWOOD DRIVE (50')

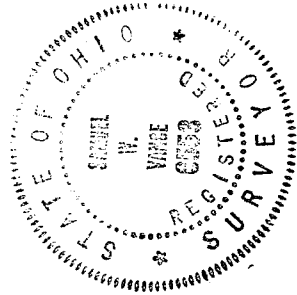

NEW SURVEY  
OF EXISTING PARCEL  
TAX MAP APPROVED  
EAV 2-16-95  
INITIAL DATE

LEGEND

- IRON PIN FOUND
- MONUMENT BOX
- 3/4" x 30" IRON PIPE SET IN PLASTIC CAP STAMPED "VANCE 6553"

I hereby certify that the foregoing drawing was prepared from an actual survey of the premises.

Samuel W. Vance  
Registered Surveyor No. 6553

VANCE SURVEYING  
LAND SURVEYOR  
28 Clinton Road, Mount Vernon, Ohio 43050

C-335

DESCRIPTION - 0.934 ACRE TRACT

Being situated in the southwest quarter of Section thirteen (13), Township twenty-one (21), Range nineteen (19), Village of Ontario, Richland County, State of Ohio and being that land of record in Deed Volume 827, Page 353 in the Richland County Recorder's Office and being more particularly described as follows;

Beginning at an iron pin found on the north line of Rosewood Drive (50 foot wide) at the southwest corner of Lot 1181 of Westwood Park Allotment (P.B. 19 P. 24);

thence from the place of beginning North 89 degrees 21 minutes 46 seconds West along the north line of Rosewood Drive a distance of 315.18 feet to a 3/4 inch iron pipe set;

thence North 44 degrees 59 minutes 36 seconds West along the northeasterly line of Rosewood Drive a distance of 18.08 feet to a 3/4 inch iron pipe set on the east line of Lexington-Springmill Road (County Highway 133);

thence North 00 degrees 51 minutes 11 seconds East along the east line of Lexington-Springmill Road a distance of 111.35 feet to an iron pin found, said iron pin being South 89 degrees 08 minutes 49 seconds East a distance of 46.00 feet from the centerline of said Road;

thence South 89 degrees 21 minutes 46 seconds East along the southerly boundary of B.J. Hunt (D.V. 565 P. 172) a distance of 329.18 feet to an iron pin found;

thence South 01 degrees 19 minutes 43 seconds West along the westerly line of Lot 1181 of Westwood Park Allotment a distance of 124.00 feet to the place of beginning - containing 0.934 acres, more or less.

Subject to all legal right-of-way of previous record.

The above description was prepared from a survey made by me, Samuel W. Vance, Registered Surveyor No. 6553 in February, 1995. Bearing Basis from Survey Volume B Page 377. All pins set are 3/4 inch by 30 inch iron pipe with plastic cap stamped "Vance 6553".

NEW SURVEY  
OF EXISTING PARCEL  
TAX MAP APPROVED  
EAV  
INITIAL      DATE  
2-16-95

