

C-121

PLAT OF PROPERTY SURVEY

GEORGE E. & ILLIGENE SWIGART
PART OF THE NORTHWEST QUARTER, SECTION ELEVEN (11)
TOWNSHIP TWENTY (20), RANGE NINETEEN (19)
TROY TOWNSHIP, RICHLAND COUNTY, OHIO

N.D. YOUNG
13.17 AC.
O.R.V. 56/68

A.L. MASSA
47.682 AC.
O.R.V. 213/751

N 03° 29' 15" E
243.00'

S 84° 55' 30" E
1076.00'

6.0002 ACRES
G.E. & I. SWIGART
D.V. 670/371

N 84° 55' 30" W
1076.00'

D. & D. TENISON
4.26 AC.
D.V. 893/596

N 3° 29' 15" E
615.0'

GRAHAM RD. (T.H. 141)

BEARINGS ARE BASED
ON A SURVEY DONE BY
R.A. CUNNING, RLS 4939,
DATED NOV. 6, 1989

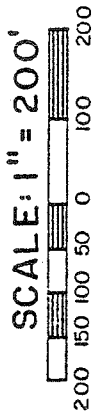

LEGEND

- ✕ RAILROAD SPIKE FOUND
- △ SURVEY NAIL SET
- 5/8" IRON PIN SET WITH
CAP STAMPED "LUTZ, 6756"

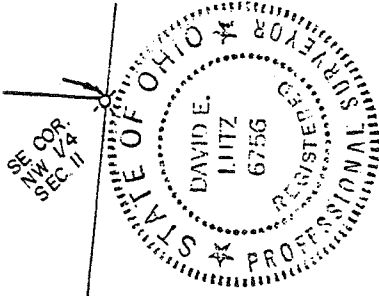

NEW SURVEY
OF EXISTING PARCEL
TAX MAP APPROVED
EAS Lutz 94
INITIAL DATE

S. LINE NW 1/4 SEC. 11

PREPARED BY

David E. Lutz

DAVID E. LUTZ
OHIO REGISTERED SURVEYORS NO. 6756
DATE: MAY 5, 1994

C-121

DESCRIPTION
GEORGE E. & ILIGENE SWIGART
PART OF THE NORTHWEST QUARTER, SECTION ELEVEN(11)
TOWNSHIP TWENTY(20), RANGE NINETEEN(19)
TROY TOWNSHIP, RICHLAND COUNTY, OHIO

DESCRIPTION: Being a part of the Northwest Quarter of Section Eleven (11), Township Twenty (20), Range Nineteen (19), Troy Township, Richland County, Ohio, and being more particularly described as follows:

Beginning for the same at a railroad spike found at the southeast corner of the Northwest Quarter of Section Eleven (11), also being a point in the centerline of Graham Road (T. H. 141); thence N 03° 29' 15" E a distance of 615.00 feet along the east line of said quarter section and said centerline to a survey nail set at the northeast corner of a 4.26 acre parcel described in Deed Volume 893, Page 596 and the real point of beginning of the parcel herein described;

- 1) thence N 84° 55' 30" W a distance of 1076.00 feet along the north line of said 4.26 acre parcel to an iron pin set and passing for reference an iron pin set at 30.01 feet;
- 2) thence N 03° 29' 15" E a distance of 243.00 feet along the east line of a 13.17 acre parcel described in Official Records Volume 56, Page 68 to an iron pin set on the south line of a 47.682 acre parcel described in Official Records Volume 213, Page 751;
- 3) thence S 84° 55' 30" E a distance of 1076.00 feet along the south line of said 47.682 acre parcel to a survey nail set in the centerline of Graham Rd. and the east line of the Northwest Quarter of Section 11, passing for reference an iron pin set 30.01 feet west thereof;
- 4) thence S 03° 29' 15" W a distance of 243.00 feet along said centerline to the real point of beginning
and containing 6.0002 acres, more or less, but subject to all legal easements and public rights-of-way now on record. Bearings are based on a survey done by R. A. Cuning, RLS 4939, dated November 6, 1989. All iron pins set are 5/8" diameter with caps stamped "LUTZ,6756".

CERTIFICATION: I hereby certify that a survey was made of the above property and markers found or set as indicated.

David E. Lutz
Ohio Registered Surveyor No. 6756
Date: May 5, 1994

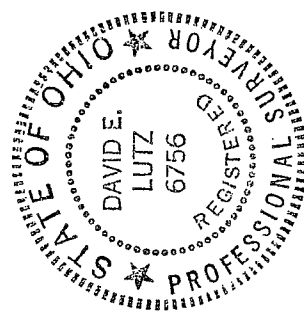

NEW SURVEY
OF EXISTING PARCEL
RICHLAND COUNTY
TAX MAP OFFICE

INITIAL DATE
7-1-10

ORIGINAL SURVEY

DONE 6-3-94

LEGAL Lost and
RESUBMITTED

C-121