

B-416 *Justin A Seiler*  
 SURVEY BY: JUSTIN A. SEILER  
 REG. SURVEYOR #4421

NORTH

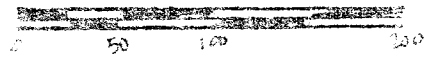

THE NE CORNER OF  
 THE NE 1/4 SEC. 36

50° E 670.45'

S. HOME RD (T.H.135)

GO BASEMENT  
 FOR INGRESS &  
 EGRESS

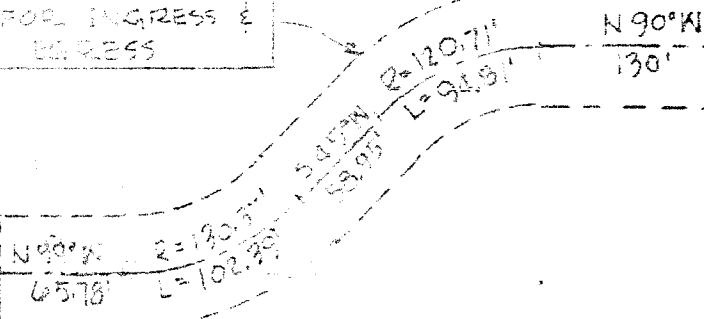

742.19'

F. & J. BEMILLER  
 5.283 AC.  
 VOL. 619, PG. 85-88

⊙ INDICATES PROPERTY CORNERS  
 OF THIS SURVEY WITH 5/8" IRON  
 PINS SET THEREON.

742.45'

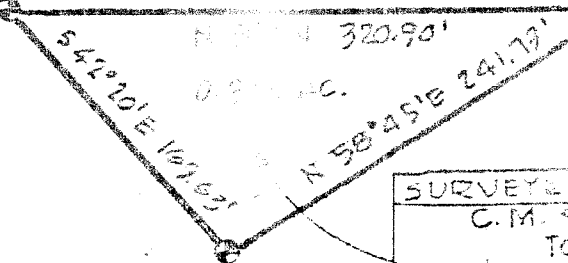

THE PLACE OF  
 BEGINNING

C.M. SCHONER

SURVEYED FOR TRANSFER  
 C.M. SCHONER  
 TO  
 F & J. BEMILLER

SURVEY PLAT FOR PROPERTY TRANSFER	
F. LOYAL BEMILLER	
PART NE 1/4 SECTION 36; T-21; R-19	
SPRINGFIELD TOWNSHIP	
RICHLAND COUNTY, OHIO	
DATE: SEPT. 10, 1985	SCALE: 1"=100'
DRAWING NO: 862004	DRW BY: JWS

B-1110