

RIEDEL LAND SURVEYING COMPANY
 712 North Henry Street
 CRESTLINE, OHIO 44827
 (419) 683-1951

JOB _____ OF B-375
 SHEET NO. _____
 CALCULATED BY _____ DATE _____
 CHECKED BY _____ DATE _____

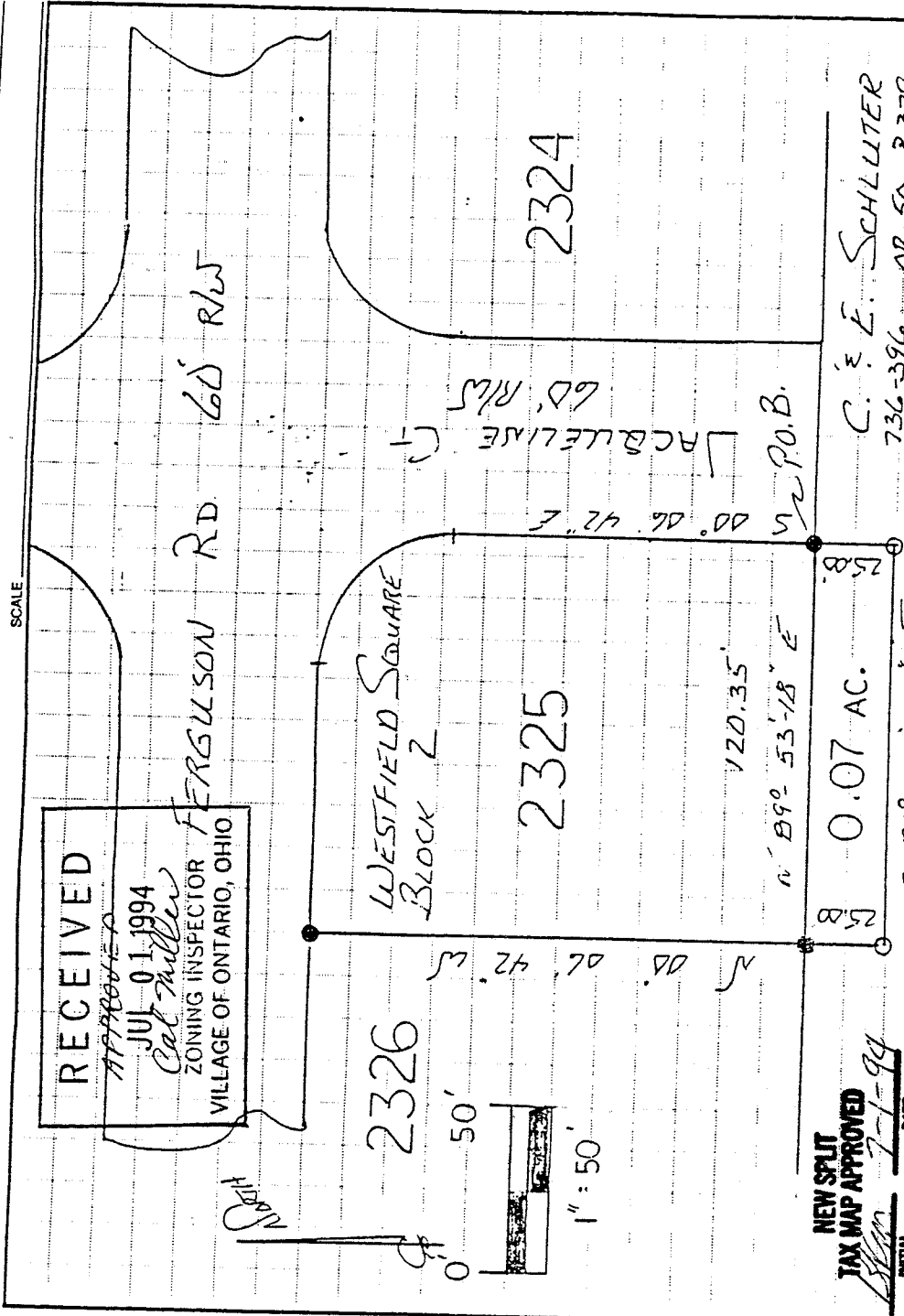

C. E. SCHLUTER
 736-396 DR 50 P. 379

LEGEND:

NORTHWEST QUARTER
 SECTION 14, T-21, R-19
 VILLAGE OF ONTARIO
 SPRINGFIELD TOWNSHIP,
 RICHLAND COUNTY, OHIO

0 - 5/8" REBAR W/LEAP
 STAMPED "PS 70/6" SET

● - EXISTING IRON PIN

BASIS OF BEARINGS:

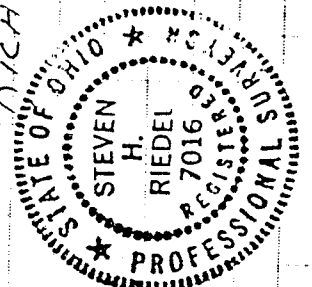

STEVEN H. RIEDEL
 OHIO SURVEYOR 7016
 MAY 17, 1994

DEPT BOOK 25 Pg. 132

375

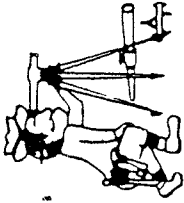

Riedel Land Surveying Company

712 N. Henry St.
Crestline, Ohio 44827

Phone (419) 683-1951

June 20, 1994

Bridges and Campbell (0.07 acres)
rsp14nw

Situated in the Township of Springfield, County of Richland, State of Ohio and being part of the Northwest quarter of Section 14, T-21, R-19, Village of Ontario and being more fully described as follows:

Beginning at an existing iron pin at the Southeast corner of Lot 2325 of the Westfield Square Block 2 recorded in Plat book 25 page 132 in the Richland County Recorder's Office;

thence running South 00 deg. 06 min. 42 sec. East for 25.00 feet to a 5/8 inch rebar set;

thence turning and running South 89 deg. 53 min. 18 sec. West for 120.35 feet to a 5/8 inch rebar set;

thence turning and running North 00 deg. 06 min. 42 sec. West for 25.00 feet to an existing iron bar at the Southwest corner of Lot 2325;

thence turning and running North 89 deg. 53 min. 18 sec. East along the South line of said Lot for 120.35 feet to the place of beginning.

All 5/8 inch rebars set have a plastic cap stamped "PS 7016".

The above described parcel has a calculated area of 0.07 acres of land according to a survey made on May 17, 1994 by Steven H. Riedel, Ohio registered surveyor 7016.

Prior Deed: Volume 736 page 396

Basis of bearings: Plat book 25 page 132

RECEIVED
APPROVED
JUL 01 1994
Carl Miller
ZONING INSPECTOR
VILLAGE OF ONTARIO, OHIO

Grantees, there heirs and assigns do here by covenant and agree that the parcel of land described in this instrument will not be conveyed by said grantees, heirs and assigns, unless said parcel fronts on a public highway or dedicated street, or is sold together with lands fronting on a public highway or dedicated street.

NEW SPLIT
TAX MAP APPROVED
[Signature] INITIAL
7-1-94 DATE