



N. LINE SW 1/4 SEC. 2

N. LINE SE 1/4 SEC. 2

THE NE CORNER
SW 1/4 SEC. 2

N 89°46'11" E
288.53'

PARCEL "A"
1.142 AC.

S 81°29'42" W
249.57'

PARCEL "B"
1.142 AC.

S 86°58'17" W
204.92'

N 11°43'44" W
206.56'

N 11°43'44" W
209.47'

PAVEMENT RULE ROAD-(60')
TOWNSHIP HIGHWAY 344

S 00°05'53" E 2061.61'

S 00°05'53" E

S 00°05'53" E 231.18'

E LINE SW 1/4 SEC. 2

W. LINE SW 1/4 SEC. 2

S. LINE SW 1/4 SEC. 2

S. LINE SE 1/4 SEC. 2

THE SE CORNER
SW 1/4 SEC. 2

GRACE I. ZIMMERMAN, ETAL
ORV. 1899, PG. 291

NEW SPLIT
RICHLAND COUNTY
TAX MAP OFFICE

INITIAL DATE
424-09

LEGEND

- IRON PIN FOUND
- 5/8" REBAR SET WITH I.D. CAP STAMPED "SUL INC"



Distances shown hereon are expressed in feet and decimal parts thereof.

Bearings are to an assumed meridian and are used to express angles only.

CERTIFICATION: I hereby state that the foregoing survey was prepared from actual field measurements, in accordance with Chapter 4733-37, Ohio Administrative Code.

By: *Nathaniel B. Ramsey*
Nathaniel B. Ramsey, P.S. #8396

Alayhoor
Date

4/20/09

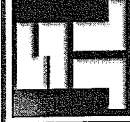

SHAFER, JOHNSTON, LICHTENWALTER
& ASSOCIATES, INC.

Consulting Engineers & Surveyors
909 South Main Street Mansfield, Ohio 44907
TEL (419) 756-7302
FAX (419) 756-0867 EMAIL nramsey@sjl-inc.com

SURVEY MADE AT THE REQUEST OF:

GRACE I. ZIMMERMAN
PART OF THE SOUTHWEST QUARTER
OF SECTION 2,
JEFFERSON TOWNSHIP
T-19 N, R-18 W
RICHLAND COUNTY, OHIO

DRAWN	CHECKED	SCALE	JOB NO.	DATE
NRK		1" = 100'	SM-1947	4/20/2009
DWG NO: SM-1947			SHEET 1 OF 1	

**SHAFFER, JOHNSTON, LICHTENWALTER
& ASSOCIATES, INC.
ENGINEERS & SURVEYORS**

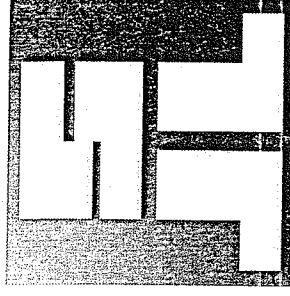

April 20, 2009

**SURVEYOR'S DESCRIPTION FOR
GRACE I. ZIMMERMAN**

PARCEL "A"

1.142 Acres

Situated in the Township of Jefferson, County of Richland, State of Ohio, being part of the Southwest Quarter of Section 2, Township 19 North, Range 18 West and being more particularly described as follows:

Commencing for the same at an iron pin found and accepted as marking the northeast corner of said quarter;

Thence, **South 00 degrees 05 minutes 53 seconds East, 2061.61 feet** with the east line of said quarter to an iron pin set, **the place of beginning** of the parcel herein described;

Thence, the following **FOUR** courses:

1. **South 00 degrees 05 minutes 53 seconds East, 166.50 feet** continuing with the east line of said quarter to an iron pin set;
2. **South 81 degrees 29 minutes 42 seconds West, 249.57 feet** to an iron pin set;
3. **North 11 degrees 43 minutes 44 seconds West, 206.56 feet** to an iron pin set;
4. **North 89 degrees 46 minutes 11 seconds East, 288.53 feet** to the **place of beginning** and containing **1.142 acres**, more or less, and subject to all legal highways and easements of record.

Bearings are based on an assumed meridian and are for angular determination only.

According to a survey made in April 2009 by Nathaniel B. Ramsey, Ohio Professional Surveyor No. 8396.

All iron pins set are 5/8" diameter rod with plastic cap stamped "S JL, INC".



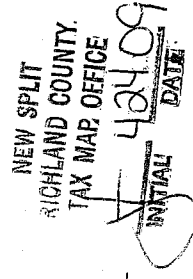

Nathaniel B. Ramsey
Professional Surveyor No. 8396
SM-1947_Parcel A.doc



909 South Main Street Mansfield, Ohio 44907
Ph. (419) 756-7302 Fax (419) 756-0867
Email: nramsey@sjl-inc.com

AA179

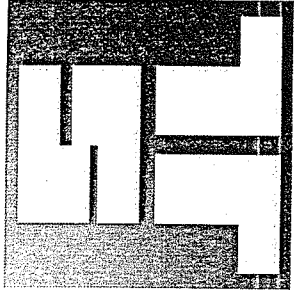
*SHAFFER, JOHNSTON, LICHTENWALTER
& ASSOCIATES, INC.
ENGINEERS & SURVEYORS*



April 20, 2009

**SURVEYOR'S DESCRIPTION FOR
GRACE I. ZIMMERMAN**

PARCEL "B"

1.142 Acres

Situated in the Township of Jefferson, County of Richland, State of Ohio, being part of the Southwest Quarter of Section 2, Township 19 North, Range 18 West and being more particularly described as follows:

Commencing for the same at an iron pin found and accepted as marking the northeast corner of said quarter;

Thence, **South 00 degrees 05 minutes 53 seconds East, 2228.11 feet** with the east line of said quarter to an iron pin set, **the place of beginning** of the parcel herein described, and passing through an iron pin set at 2061.61 feet;

Thence, the following **FOUR** courses:

1. **South 00 degrees 05 minutes 53 seconds East, 231.18 feet** continuing with said east line of said quarter to an iron pin set;
2. **South 86 degrees 58 minutes 17 seconds West, 204.92 feet** to an iron pin set;
3. **North 11 degrees 43 minutes 44 seconds West, 209.47 feet** to an iron pin set;
4. **North 81 degrees 29 minutes 42 seconds East, 249.57 feet** to the **place of beginning** and containing **1.142 acres**, more or less, and subject to all legal highways and easements of record.

Bearings are based on an assumed meridian and are for angular determination only.

According to a survey made in April 2009 by Nathaniel B. Ramsey, Ohio Professional Surveyor No. 8396.

All iron pins set are 5/8" diameter rod with plastic cap stamped "SJL, INC".



Nathaniel B. Ramsey
Professional Surveyor No. 8396
SM-1947_Parcel B.doc

909 South Main Street Mansfield, Ohio 44907
Ph. (419) 756-7302 Fax (419) 756-0867
Email: nramsey@sjl-inc.com

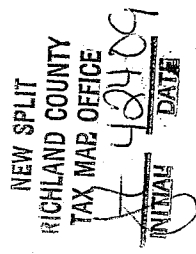

AAng