

LEON & DELORES BOND  
ORV 1463, PG 4

PAUL B. & MENDI S. GODSEY  
ORV 913, 74

ERIC W. & DIANNE M. VAIL  
ORV 1361, PG 162

CHRISTOPHER & ANITA J. BRANHAM  
ORV 1688, PG 634

NATHANIEL P. & MARIA T. POWERS  
ORV 1263, PG 733

McMILLEN ROAD  
TOWNSHIP HIGHWAY 429

8.263 AC.

N 89°25'20" E 456.35'

N 00°49'58" E 789.19'

S 00°48'56" W 788.43'

399.21'

R=20.81'

389.22'

S 89°38'38" W  
0.60'

R=20.00'

S 89°19'41" W 456.60'

S 89°19'41" W 862.01'

S 13°53'23" W  
1.26'  
(BROKEN IRON PIPE)

E. LINE NW 1/4 SEC. 12

R=45.00'

R=20.00'

R=45.00'

R=45.00'

R=45.00'

R=45.00'

**LEGEND**

- IRON PIPE FOUND
- ⊕ CONCRETE MONUMENT FOUND WITH IRON PIPE IN CENTER
- △ MAGNAIL SPIKE FOUND
- ⊙ 5/8" IRON PIN FOUND WITH I.D. CAP STAMPED "SEILER 6869"
- ⊗ 5/8" IRON PIN FOUND WITH I.D. CAP STAMPED "SEILER & CRAIG, INC."
- ⊗ 5/8" IRON PIN FOUND WITH I.D. CAP MARKED "BLUNK 6320"
- 5/8" REBAR SET WITH I.D. CAP STAMPED "SJL INC"

NEW SURVEY  
OF EXISTING PARCEL  
RICHLAND COUNTY  
TAX MAP OFFICE

MLB 11-5-08  
INITIAL DATE



Distances shown hereon are expressed in feet and decimal parts thereof.

Bearings are to an assumed meridian and are used to express angles only.

CERTIFICATION: I hereby certify that the foregoing survey was prepared from actual field measurements, in accordance with Chapter 4733-37, Ohio Administration Code.

By: *Roger L. Stevens* 10-5-08  
Roger L. Stevens, P.S. #7052 Date



SHAFER, JOHNSTON, LICHTENWALTER & ASSOCIATES, INC.  
Consulting Engineers & Surveyors  
909 South Main Street • P.O. Box 3598  
Mansfield, Ohio 44907  
TEL (419) 756-7302 FAX (419) 756-0867 EMAIL sjl@sjl-inc.com

**SURVEY MADE AT THE  
REQUEST OF:**

**CHRISTOPHER BRANHAM**  
PART NW 1/4 SEC. 12  
WELLER, TOWNSHIP  
T-22N, R-18W  
RICHLAND COUNTY, OHIO

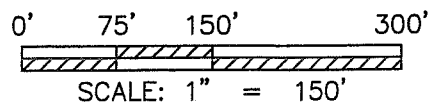

DRAWN NBR	CHECKED	SCALE	DATE
DWG NO: SM-1933	JOB NO: SM-1933	1" = 150'	10/30/08
SHEET 1 OF 1			

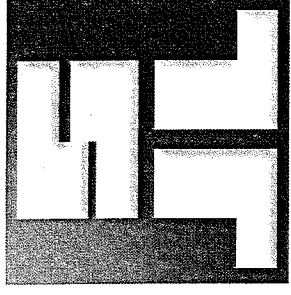

**SHAFFER, JOHNSTON, LICHTENWALTER  
& ASSOCIATES, INC.  
ENGINEERS & SURVEYORS**

November 3, 2008

**SURVEYOR'S DESCRIPTION FOR  
CHRISTOPHER BRANHAM**

**8.263 Acres**

Situated in the Township of Weller, County of Richland, State of Ohio, being part of the Northwest Quarter of Section 12, Township 22 North, Range 18 West and being more particularly described as follows:

**Commencing** at a concrete monument found and accepted as marking the southeast corner of said Northwest Quarter, said monument also marking the southeast corner of a parcel conveyed to Nathaniel P. and Maria T. Powers by official record volume 1263, page 733;

Thence, South 89 degrees 19 minutes 41 seconds West, 862.01 feet with the south line of said Northwest Quarter and the south line of said Nathaniel P. and Maria T. Powers parcel to a point marking the southwest corner of said parcel, said point also being in the centerline of McMillen Road (T.H. 429), being referenced by an iron pin found N 00° 48' 56" E, 20.81 feet from said point and the place of beginning of the parcel herein described:

Thence, the following **FOUR** courses:

1. **South 89 degrees 19 minutes 41 seconds West, 456.60 feet** continuing with the south line of said Northwest Quarter and said centerline to an iron pipe found in the southeast corner of a parcel conveyed to Paul B. and Mendi S. Godsey by official record volume 913, page 74;
2. **North 00 degrees 49 minutes 58 seconds East, 789.19 feet** with the east line of said Paul B. and Mendi S. Godsey parcel and an east line of a parcel conveyed to Leon and Delores Bond by official record volume 1463, page 4 to an iron pipe found in a southwest corner of a parcel conveyed to Eric W. and Dianne M. Vail by official record volume 1361, page 162;
3. **North 89 degrees 25 minutes 20 seconds East, 456.35 feet** with a south line of said Eric W. and Dianne M. Vail parcel to an iron pipe found in an existing interior corner of said parcel;
4. **South 00 degrees 48 minutes 56 seconds West, 788.43 feet** with a west line of said Eric W. and Dianne M. Vail parcel and the west line of the aforementioned Nathaniel P. and Maria T. Powers parcel to the place of beginning, passing through an iron pin found at 767.62 feet and **containing 8.263 acres**, more or less, and subject to all legal highways and easements of record.

Bearings are to an assumed meridian and are to be used for angular determination only.

According to a survey made in November 2008 by Roger L. Stevens, Ohio Registered Surveyor No. 7052.

All iron pins set are 5/8" diameter rod with plastic cap stamped "SJL, INC".

NEW SURVEY  
OF EXISTING PARCEL  
RICHLAND COUNTY  
TAX MAP OFFICE

*Roger L. Stevens*  
Roger L. Stevens

Registered Surveyor No. 7052  
SM-1933

MLB 11-5-08  
INITIAL DATE

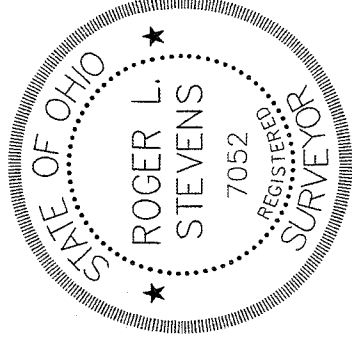

P.O. Box 3598 909 South Main Street Mansfield, Ohio 44906  
Ph. (419) 756-7302 Fax (419) 756-0867 Email: rstevens@sjl-inc.com

AA-64