

AA-13



BAHL AVENUE - 50' R/W
P.V.-7 P.-26

N 01°49'48" W 65.00'

The Place of Beginning

LOT #62
ERIC & OPAL BLACK
ORV 1479, PG 180
N 88°15'23" E 175.22'

PART OF 15'
VACATED ALLEY
(2246 SF)

S 88°15'23" W 50.69'
PART OF 15'
VACATED ALLEY

SHANE MORAN
ORV 1668, PG 454

8,415 SQ. FT.
TOTAL

PART OF
LOT #63
(3634 SF)

PART OF
LOT #64
(2535 SF)

S 00°00'00" E 57.50'

S 01°08'39" E
7.50'

JACQUE L. CONNERS
DV 806, PG 432

LOT 65
JEREMY A. & CHRISTY JARVIS
ORV 1552, PG 285

S 88°14'44" W 122.60'
JAMES L. STEELE & JACQUELYN STOUT
ORV 513, PG 756

LEGEND

- IRON PIN FOUND
- 5/8" REBAR SET WITH I.D. CAP MARKED "SJL INC"

NEW SURVEY
OF EXISTING PARCEL
RICHLAND COUNTY
TAX MAP OFFICE
MIB 4-8-08
INITIAL DATE

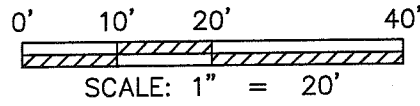

Distances shown hereon are expressed in feet and decimal parts thereof.
Bearings are based on survey "1-82" on file at the Richland County Taxmap Office.

CERTIFICATION: I hereby certify that the foregoing survey was prepared from actual field measurements, in accordance with Chapter 4733-37, Ohio Administration Code.

By: Roger L. Stevens 9-8-08
Roger L. Stevens, P.S. #7052 Date

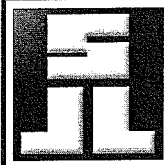

SHAFFER, JOHNSTON, LICHTENWALTER
& ASSOCIATES, INC.
Consulting Engineers & Surveyors
909 South Main Street • P.O. Box 3598
Mansfield, Ohio 44907
TEL (419) 756-7302 FAX (419) 756-0867 EMAIL sjl@sjl-inc.com

**SURVEY MADE AT THE
REQUEST OF:
SHANE MORAN**

**PARTS OF LOTS 63 & 64, PART OF VACATED ALLEY
BAHLVILLE, P.V.-7, P.-26,
MADISON TWP., RICHLAND CO., OHIO**

| | | | |
|-----------------|---------|-------------------|----------------|
| DRAWN NBR | CHECKED | SCALE 1" = 20' | DATE 9/3/08 |
| DWG NO: SM-1927 | | JOB NO: SM-1927 | |
| | | | SHEET 1 OF 1 |

5. South 88 degrees 14 minutes 44 seconds West, 122.60 feet with the north line of said James L. Steele & Jacquelyn Stout parcel to an iron pin found in the northwest corner thereof, said iron pin also being on said east right of way line of Bahl Avenue;
6. North 01 degree 49 minutes 48 seconds West, 65.00 feet with said east right of way line of Bahl Avenue to the **place of beginning** and containing a total of **8,415 square feet**, more or less, of which 3,634 square feet are located within part of lot 63, 2,535 square feet are located within part of lot 64, and 2,246 square feet are located within said vacated Alley, and subject to all legal highways and easements of record.

Basis of bearing: Survey I-82.

According to a survey made in September 2008 by Roger L. Stevens, Ohio Registered Surveyor No. 7052.

The intent of this instrument is to describe in greater detail the premises conveyed by Official Record Volume 1668, Page 454

All iron pins set are 5/8" diameter rod with plastic cap stamped "SJL, INC".



Roger L. Stevens
Registered Surveyor No. 7052
SM-1927

NEW SURVEY
OF EXISTING PARCEL
RICHLAND COUNTY
TAX MAP OFFICE

MLB 9-8-08
INITIAL DATE

P.O. Box 3598 909 South Main Street Mansfield, Ohio 44907
Ph. (419) 756-7302 Fax (419) 756-0867 Email: rstevens@sjl-inc.com

AA13

**SHAFFER, JOHNSTON, LICHTENWALTER
& ASSOCIATES, INC.
ENGINEERS & SURVEYORS**

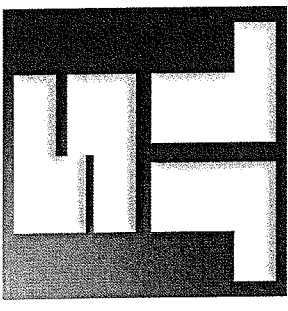

September 4, 2008

**SURVEYOR'S DESCRIPTION FOR
SHANE MORAN**

**Part of Lot 63
Part of Lot 64
Part Vacated Alley**

Situated in the Township of Madison, County of Richland, State of Ohio, being parts of Lots 63 and 64 and part of a vacated alley in Bahlville (Plat Volume 7, Page 26) and being more particularly described as follows:

Beginning for the same at an iron pin set in the southwest corner of Lot 62 of Bahlville, said iron pin also being on the east right of way line of Bahl Avenue (50 feet Right of Way) and on the north line of a vacated alley (15' wide);

Thence with the following **SIX** courses:

1. North 88 degrees 15 minutes 23 seconds East, 175.22 feet with the south line of said lot 62 and the north line of said vacated alley to an iron pin set on in the southeast corner of said lot 62, the east line of said Bahlville and the west line of a parcel conveyed to Jacque L. Conners by deed record volume 806, page 432;
2. South 01 degree 08 minutes 39 seconds East, 7.50 feet with said east line of Bahlville (Plat Volume 7, Page 26) and the west line of said Jacque L. Conners parcel to an iron pin set, said iron pin being in the northeast corner of a parcel conveyed to Jeremy A. & Christy Jarvis by official record volume 1552, page 285;
3. South 88 degrees 15 minutes 23 seconds West, 50.69 feet with the north line of said Jeremy A. & Christy Jarvis parcel to an iron pin set in the northwest corner thereof;
4. South 00 degrees 00 minutes 00 seconds East, 57.50 feet with the west line of said Jeremy A. & Christy Jarvis parcel, a part of which is along the east line of said Lot 64 to an iron pin set in the northeast corner of a parcel conveyed to James L. Steele & Jacquelyn Stout by official record volume 513, page 756;

*P.O. Box 3598 909 South Main Street Mansfield, Ohio 44907
Ph. (419) 756-7302 Fax (419) 756-0867 Email: rstevens@sjl-inc.com*

AA-13