

**CURVE "A"**  
 L=51.87'  
 R=626.83'  
 $\Delta=04^{\circ}44'28''$   
 C LEN=51.85'  
 BRG=S 85°27'08" W

R=0.58'

CURVE "A"

**WINWOOD DRIVE--60'**  
 PV 16, PG 3

NEW SURVEY  
 OF EXISTING PARCEL  
 OF RICHLAND COUNTY  
 TAX MAP OFFICE  
 MLB 9-5-08  
 INITIAL DATE

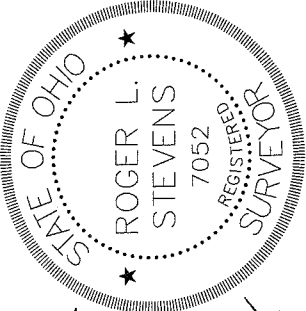
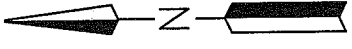
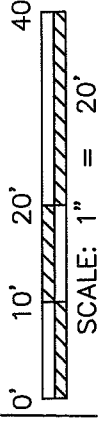

**LEGEND**

- IRON PIN FOUND
- Distances shown hereon are expressed in feet and decimal parts thereof.
- Bearings are to an assumed meridian and are used to express angles only.
- CERTIFICATION: I hereby certify that the foregoing survey was prepared from actual field measurements, in accordance with Chapter 4733-37, Ohio Administration Code.

By: *Roger L. Stevens*  
 Roger L. Stevens, P.S. #7052

Date

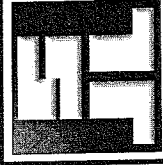

**SHAFFER, JOHNSTON, LICHTENWALTER & ASSOCIATES, INC.**  
 Consulting Engineers & Surveyors  
 909 South Main Street • P.O. Box 3598  
 Mansfield, Ohio 44907  
 TEL (419) 756-7302 FAX (419) 756-0867 EMAIL sjl@sjh-inc.com

**SURVEY MADE AT THE REQUEST OF:**  
**DAVID C. & RITA L. FALQUETTE**

**PART OUTLOT #3**  
**CITY OF MANSFIELD**  
**RICHLAND COUNTY, OHIO**

DRAWN NBR	CHECKED	SCALE 1" = 20'	DATE 9/2/08
DWG NO: SM-1926		JOB NO: SM-1926	SHEET 1 OF 1

AA-11

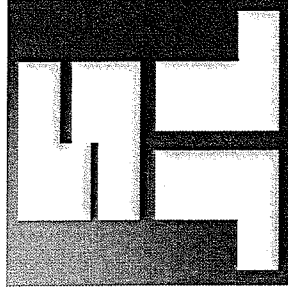

**SHAFFER, JOHNSTON, LICHTENWALTER  
& ASSOCIATES, INC.  
ENGINEERS & SURVEYORS**

September 2, 2008

**SURVEYOR'S DESCRIPTION FOR  
DAVID & RITA FALQUETTE**

**Part of Outlot 3**

Situated in the City of Mansfield, County of Richland, State of Ohio, being a part of the Southeast Quarter of Section 28, Township 21 North, Range 18 West, also being a part of Outlot 3 of said City and being more particularly described as follows:

**Commencing** at an iron pin found and accepted as being in the northeast corner of Lot 11193 of the consecutively numbered lots in said city;

Thence, **North 88 degrees 57 minutes 39 seconds West, 145.20 feet** with the north line of said lot and the westerly prolongation thereof to a point in the northwest corner of a parcel conveyed to Janet Lee Walker by deed record volume 807, page 568, said point being referenced by an iron pin found N 01°19'11" E, 0.35 feet, and being **the true place of beginning** of the parcel herein described;

Thence with the following **FOUR** courses:

- 1. South 01 degree 19 minutes 11 seconds West, 155.27 feet** along said west line of said Janet Lee Walker parcel to an iron pin found in the southwest corner thereof, said iron pin also being on the north right of way line of Winwood Drive-(60' Right of Way);
- 2. Westerly** with the north line of said Winwood Drive along a curve to the left with a **radius of 626.83 feet, an arc length of 51.87 feet, a delta angle of 04 degrees 44 minutes 28 seconds, a chord bearing of South 85 degrees 27 minutes 08 seconds West, and a chord distance of 51.85 feet** to a point in the southeast corner of a parcel conveyed to Glenn E. Moyer by official record volume 357, page 14, said point being referenced by an iron pin found S 01°48'06" E, 0.58 feet from said point;
- 3. North 01 degree 48 minutes 06 seconds East, 160.33 feet** with the east line of said Glenn E. Moyer parcel to an iron pin found in the northeast corner thereof, said iron pin also being in the southwest corner of a parcel of land conveyed to Haines & Hannewald Rental an Ohio Corporation by official records volume 453, page 964;
- 4. South 88 degrees 57 minutes 39 seconds East, 50.23 feet** along the south line of said land of Haines & Hannewald Rental an Ohio Corporation to **the true place of beginning** and containing **8,013 square feet**, more or less and subject to all legal highways and easements of record.

Bearings are to an assumed meridian and are to be used for angular determination only.

According to a survey made in September 2008 by Roger L. Stevens, Ohio Registered Surveyor No. 7052.

All iron pins set are 5/8" diameter rod with plastic cap stamped "SJL, INC".

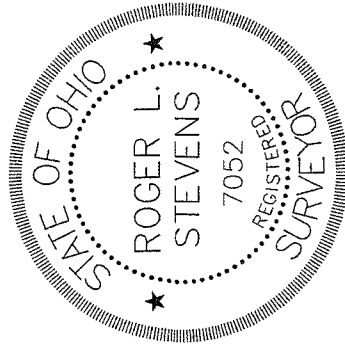

*Roger L. Stevens* 9-5-08  
 Roger L. Stevens Date  
 Registered Surveyor No. 7052 SM-1926

NEW SURVEY  
 OF EXISTING PARCEL  
 RICHLAND COUNTY  
 TAX MAP OFFICE  
 INITIAL MLD DATE 9-5-08

909 South Main Street Mansfield, Ohio 44907  
 Ph. (419) 756-7302 Fax (419) 756-0867 Email: rstevens@sjl-inc.com

AA-11