

11-536

SURVEY FOR GARY & COBBLE EARR

BEING A PART OF THE NORTHWEST QUARTER OF SECTION NUMBER 33
TOWNSHIP 20 RANGE 18, TOWNSHIP OF WASHINGTON
COUNTY OF RICHLAND, STATE OF OHIO

PARCEL NO. 8

C. & D. MOWERY
VOL. 769 - PG. 575

S-00°-36'-40"-W 276.84'
N-00°-36'-40"-E 224.70'

G. & C. BARNOL
ORDN 157 - PG. 810

4,5000 ACRES

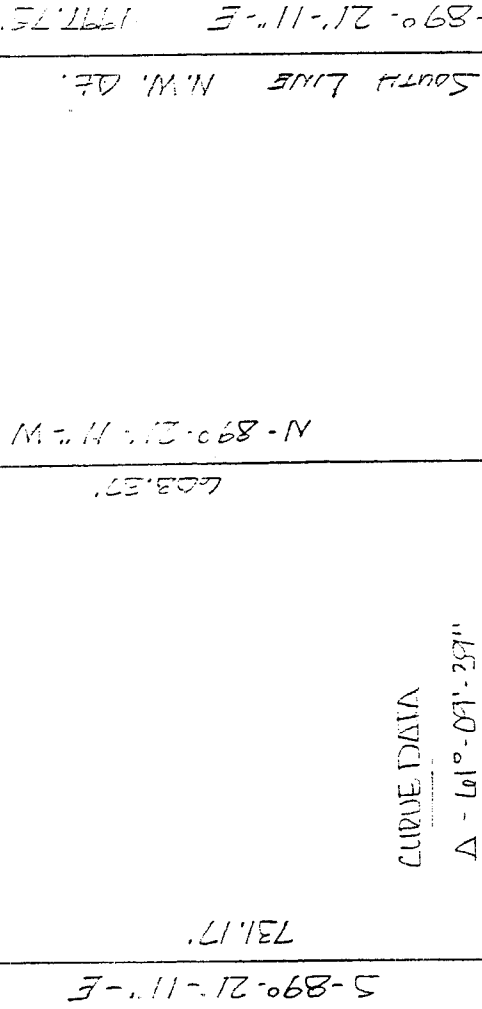

CURVE DATA

Δ - 61°-07'-37"
R - 270.00'
D - 26°-02'-37"
LT - 223.84'

NEW SPLIT
TAX MAP APPROVED
FRM 11-10-92
DATE

S.W. COR.
N.W. (C.T.)
SEC. 23

- LEGEND
- () TRIPICE POST FOUND
 - △ RAILROAD SPIKE SET
 - I.P. W/CLAP SET

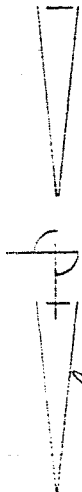

SCALE: 1 inch = 100 FEET



Approved
Edward G. Black
March, 11-9-92
Wash. Twp. 2-T.

CERTIFICATION

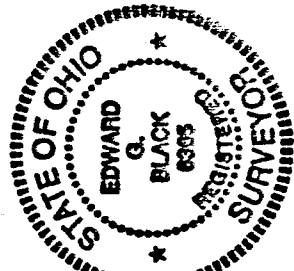

I EDWARD G. BLACK, P.S. REGISTERED SURVEYOR NUMBER 6365, DO
HEREBY CERTIFY THE ABOVE PLAT TO BE A TRUE REPRESENTATION OF
AN ACTUAL FIELD SURVEY PERFORMED BY ME IN NOVEMBER OF 1992,
AND IS CORRECT TO THE BEST OF MY KNOWLEDGE. ALL BEARINGS ARE
FROM AN ASSUMED MERIDIAN AND ARE FOR THE PURPOSE OF ANGULAR
MEASURE.

EDWARD G. BLACK, P.S.
Edward G. Black, P.S.

LEGAL DESCRIPTION OF 4.5000 ACRES
FOR

GARY & CONNIE BARR

PARCEL NO. 8

BEING A PARCEL OF LAND SITUATED IN PART OF THE NORTHWEST QUARTER OF SECTION NUMBER 33, TOWNSHIP 20 - RANGE 18, TOWNSHIP OF WASHINGTON, COUNTY OF RICHLAND, STATE OF OHIO AND BEING MORE PARTICULARLY DESCRIBED AS FOLLOWS:

COMMENCING AT A FENCE POST FOUND MARKING THE SOUTHWEST CORNER OF THE NORTHWEST QUARTER OF SECTION NUMBER 33; THENCE SOUTH - 89 DEG. - 21 MIN. - 11 SEC. - EAST AND ALONG THE SOUTH LINE OF SAID QUARTER A DISTANCE OF ONE THOUSAND NINE HUNDRED NINETY SEVEN AND SEVENTY FIVE HUNDREDTHS (1997.75) FEET TO AN IRON PIN WITH CAP SET; THENCE NORTH - 00 DEG. - 36 MIN. - 40 SEC. - EAST AND ALONG THE WEST LINE OF LANDS DEEDED TO C. & D. MOWRY IN DEED RECORD VOL. 269 - PAGE 575. A DISTANCE OF TWO HUNDRED TWENTY FOUR AND SEVENTY HUNDREDTHS (224.70) FEET TO AN IRON PIN WITH CAP SET AND THE PLACE OF BEGINNING.

THENCE NORTH - 89 DEG. - 21 MIN. - 11 SEC. - WEST AND PARALLEL TO THE SOUTH LINE OF THE NORTHWEST QUARTER A DISTANCE OF SIX HUNDRED EIGHT AND THIRTY SEVEN HUNDREDTHS (608.37) FEET TO A RAILROAD SPIKE SET IN THE CENTER OF ANDREWS ROAD;

THENCE NORTH - 50 DEG. - 28 MIN. - 05 SEC. - WEST AND ALONG THE CENTER OF SAID ROAD A DISTANCE OF SIXTY THREE AND THIRTY SIX HUNDREDTHS (63.36) FEET TO THE P.C. OF A CURVE TO THE RIGHT, SAID CURVE HAS A DELTA OF 61 DEG. - 09 MIN. - 39 SEC. AND A RADIUS OF 220.00 FEET;

THENCE ALONG SAID CURVE TO THE RIGHT AN ARC DISTANCE OF TWO HUNDRED THIRTY FOUR AND EIGHTY THREE HUNDREDTHS (234.83) FEET TO THE P.T. OF SAID CURVE;

THENCE NORTH - 10 DEG. - 41 MIN. - 36 SEC. - EAST AND ALONG THE CENTER OF SAID ROAD A DISTANCE OF TWENTY SEVEN AND EIGHTY SEVEN HUNDREDTHS (27.87) FEET TO A RAILROAD SPIKE SET;

THENCE SOUTH - 89 DEG. - 21 MIN. - 11 SEC. - EAST AND PARALLEL TO THE SOUTH LINE OF THE NORTHWEST QUARTER A DISTANCE OF SEVEN HUNDRED THIRTY ONE AND SEVENTEEN HUNDREDTHS (731.17) FEET TO AN IRON PIN WITH CAP SET IN THE WEST LINE OF SAID C. & D. MOWRY LANDS;

THENCE SOUTH - 00 DEG. - 36 MIN. - 40 SEC. - WEST AND ALONG SAID WEST LINE A DISTANCE OF TWO HUNDRED SEVENTY SIX AND EIGHTY FOUR HUNDREDTHS (276.84) FEET TO THE PLACE OF BEGINNING.

CONTAINING 4.5000 ACRES OF LAND MORE OR LESS BUT SUBJECT TO ALL LEGAL HIGHWAYS AND EASEMENTS OF RECORD.

THE ABOVE DESCRIPTION WAS MADE FROM AN ACTUAL FIELD SURVEY PERFORMED BY EDWARD G. BLACK, P.S., REGISTERED SURVEYOR NUMBER 6365, IN NOVEMBER OF 1992. ALL BEARINGS ARE FROM AN ASSUMED MERIDIAN AND ARE FOR THE PURPOSE OF ANGULAR MEASURE.

NEW SPLIT

TAX MAP APPROVED

EAJ
INITIAL EAJ DATE 11-10-92

6
51
36
A