

SHARON TWP.
 SPRINGFIELD TWP.

SEC 31
 SEC. 6

201.56' N 04° 18' 59" W
 182.83' P.O.B.
 1.01 AC. (N.W. 1/4)
 139.31' S 89° 12' 06" W
 5.89° 12' 06" W
 235.15' N 03° 14' 51" W
 9.68 AC. (N.E. 1/4)

G. & R.
 WESTLAKE
 4.21 AC.
 742 | 79

10.69 AC. TOTAL
 685 | 352

3.009 AC.
 632 | 701

864.71' S 00° 06' 00" W

N 89° 47' 00" W
 324.47' N 76° 31' 35" W
 3.72 AC. TOTAL
 913 | 19
 R. S. GENTILE
 N.E. 1/4
 N.W. 1/4
 EX. IRON PIPE
 N 17° 06' 30" E
 1.70' FROM CORNER

R. & C. ARTER
 2.032 AC.
 1.12 AC.
 P. KRESS
 0.92 AC.
 495 | 213
 108.20' N 73° 52' 02" W
 15.00' W 15° 49' 00" W
 20.00' S 15° 49' 00" W
 250.00' R. C.H. 52 (HOOK RD.)

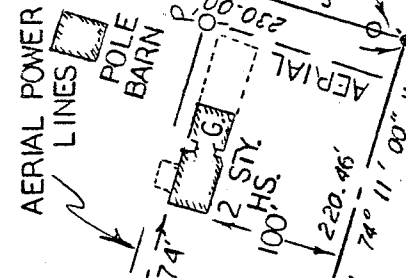

NEW SURVEY OF EXISTING PARCEL TAX MAP APPROVED
 EARN INITIAL DATE
 1-21-93

I hereby state that a survey of the above premises has been made, that there are no encroachments or easements visible of the ground other than those shown above.

SSR

Steven H. Riedel
 Ohio registered surveyor 7016
 January 27, 1993

ABOVE PARCEL DOES NOT LIE WITHIN A FLOOD HAZARD AREA.

MAP # 390476-0003A

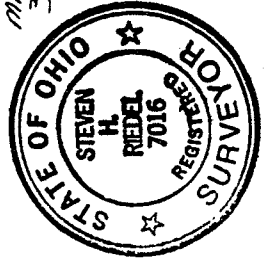

BASIS OF BEARINGS:
 DEED Vol. 913 P. 19

LEGEND:

- - 5/8" REBAR W/CAP STAMPED "PS 7016" SET
- ⊙ - EXISTING IRON PIPE
- ⋄ - SURVEY NAIL SET
- - EXISTING IRON BAR
- - EXISTING STONE

STEVEN H. RIEDEL
 OHIO SURVEYOR 7016
 JANUARY 27, 1993

NORTHEAST & NORTHWEST QUARTERS
 SEC. 6 T-21 R-19
 SPRINGFIELD TOWNSHIP
 RICHLAND COUNTY, OHIO

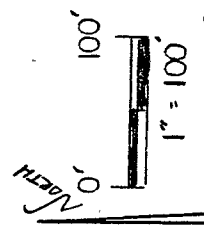

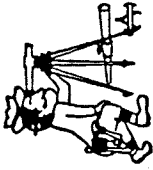

Phone (419) 683-1951

Riedel Land Surveying Company

211 1/4 Pearl St.
Crestline, Ohio 44827

January 28, 1993

Alexander Property (10.69 acres)

Situated in the Township of Springfield, County of Richland, State of Ohio, and being part of the Northeast and Northwest quarters of Section 6, Tp. 21, Rg. 19, and being more fully described as follows:

Beginning at an existing stone on the North line of Section 6 and being 201.56 feet West of the Northeast corner of the Northwest quarter of said Section;

thence running North 89 deg. 45 min. 02 sec. East along the North line of Section 6 (also being the Springfield-Sharon Township Line) for 776.28 feet to an existing iron bar;

thence turning and running South 00 deg. 06 min. 05 sec. West for 864.71 feet to an existing iron bar;

thence turning and running North 73 deg. 52 min. 02 sec. West for 108.20 feet to a 5/8 inch rebar set;

thence turning and running South 15 deg. 49 min. 00 sec. West (passing a 5/8 inch rebar set at 210.00 feet) for a total distance of 230.00 feet to a survey nail set on the centerline of County Highway 52 (Hook Road);

thence turning and running North 74 deg. 11 min. 00 sec. West along said centerline for 220.46 feet to a survey nail set;

thence turning and running North 13 deg. 00 min. 21 sec. East (passing an existing iron bar at 18.30 feet) for a total distance of 515.02 feet to an existing iron bar;

thence turning and running North 76 deg. 31 min. 35 sec. West for 324.47 feet to a 5/8 inch rebar set;

thence turning and running North 89 deg. 47 min. 00 sec. West for 30.00 feet (an existing iron pipe being North 17 deg. 06 min. 30 sec. East and 1.72 feet from this corner);

thence turning and running North 03 deg. 14 min. 51 sec. West for 235.15 feet to an existing pipe;

thence turning and running South 89 deg. 12 min. 06 sec. West for 139.31 feet to and existing stone;

thence turning and running North 04 deg. 18 min. 59 sec. West for 182.63 feet to the place of beginning.

All 5/8 inch rebars set have a plastic cap stamped "PS 7016".

The above described parcel has a calculated area of 10.69 acres (1.01 acres being in the Northwest quarter and 9.68 acres being in the Northeast quarter) according to a survey made on January 27, 1993 by Steven H. Riedel, Ohio registered surveyor 7016.

Prior deed: Volume 685 page 352

Basis of bearings: Deed Volume 913 page 19

NEW SURVEY
OF EXISTING PARCEL
TAX MAP APPROVED

EHAN 1-29-93
INITIAL DATE

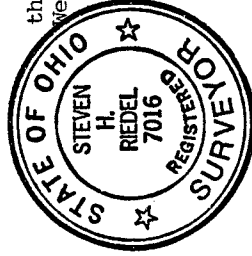

A-456

A-456