

A-260

PLAT OF LOCATION & PROPERTY SURVEY

RODNEY D. & JUDY K. MONTGOMERY  
PART OF THE NORTHWEST QUARTER, SECTION TWENTY-SEVEN (27)  
TOWNSHIP TWENTY-TWO (22), RANGE EIGHTEEN (18)  
FRANKLIN TOWNSHIP, RICHLAND COUNTY, OHIO

NEW SURVEY  
OF EXISTING PARCEL  
TAX MAP APPROVED

INITIAL EAN DATE 9-2-93

L. RONDY ETAL  
80.80 AC.  
D.V. 857/326

J. B. R. YUGOVICH SR.  
10.14 AC.  
D.V. 855/675

N 02° 30' 00" E  
200.00' M

S 87° 13' 00" E  
450.00'

2.064 ACRES  
R. B. J. MONTGOMERY  
O.R.V. 57/564

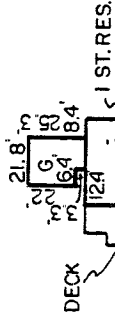

450.00'  
N 87° 13' 00" W

P. B. R. ASH  
O.R.V. 53/397  
3.0 AC.

R. B. J. MONTGOMERY  
5.0 AC.  
O.R.V. 57/564

1.0 AC.

360.0'

FRANK RD.  
(T.H. 450)

ELEC. LINE  
TEL. LINE U/G  
F. LINE NW/4 SEC. 27  
N 02° 30' 00" E  
200.00'  
200.00'  
190'

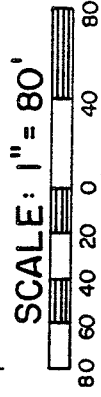

BEARINGS ARE BASED ON  
A SURVEY DONE MARCH 5, 1989  
BY JUSTIN A. SEILER.

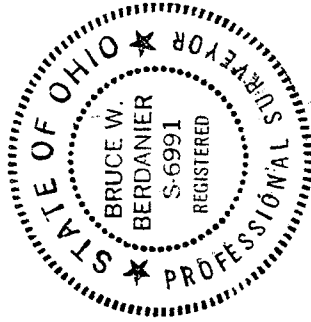

LEGEND

- IRON PIPE FOUND
- ⊗ RAILROAD SPIKE SET
- 5/8" IRON PIN SET WITH CAP STAMPED "6991"

SUBJECT PROPERTY IS OUTSIDE  
THE SPECIAL FLOOD HAZARD AREA SHOWN  
ON FEDERAL INSURANCE AGENCY, FLOOD  
HAZARD BOUNDARY MAP NO. 390 #76 01008

S. LINE NW/4 SEC 27

NW/4 SE COR.  
SEC. 27

VILLAGE ENGINEERING, LTD.

*B. W. Berdanier*

BRUCE W. BERDANIER  
OHIO REGISTERED SURVEYOR NO. 6991  
DATE: AUGUST 30, 1993

A-260

DESCRIPTION  
 RODNEY D. AND JUDY K. MONTGOMERY  
 PART OF THE NORTHWEST QUARTER OF SECTION TWENTY-SEVEN (27)  
 TOWNSHIP TWENTY-TWO (22), RANGE EIGHTEEN (18)  
 FRANKLIN TOWNSHIP, RICHLAND COUNTY, OHIO

Description: Being part of the Northwest Quarter of Section Twenty-seven (27), Township Twenty-two (22), Range Eighteen (18), Franklin Township, Richland County, Ohio, and being more particularly described as follows:

- Beginning for the same at an iron pin set at the Southeast Corner of said quarter; thence N 2°30'00"E a distance of 726.00 feet along the east line of said quarter section and the centerline of Frank Road (Township Highway No. 450) to a railroad spike set at the real point of beginning herein described;
1. Thence N 87°13'00" W a distance of 450.00 feet along the north line of property described in Official Record Volume 57, page 564 to an iron pipe found and passing iron pipes found at 19.00 feet and 360.00 feet for reference;
  2. thence N 2°30'00" E a distance of 200.00 feet along the east line of land described in Deed Volume 855, page 675 to an iron pipe found;
  3. thence S87°13'00" E a distance of 450.00 feet along the south line of land described in Deed Volume 857, page 326 to a railroad spike set and passing an iron pipe found at 428.23 feet for reference;
  4. thence S 2°30'00" W a distance of 200.00 feet along the east line of said quarter section and the centerline of said road to the point of beginning,

and containing 2.064 acres more-or-less but subject to all legal easements and public rights-of-way now on record. Bearings are based on a survey done March 5, 1989 by Justin A. Seiler. All iron pins set are 5/8" diameter with cap stamped "6991".

Certification: I hereby certify that a survey was made of the above property and markers set or found as indicated.

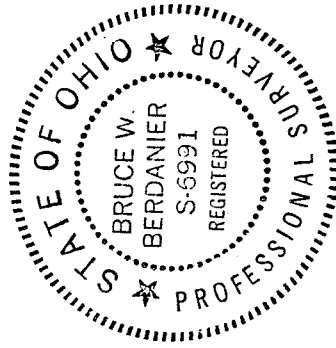

*B. W. Berdanier*  
 Bruce W. Berdanier  
 Ohio Registered Surveyor No. 6991  
 Date: August 30, 1993

A-260

NEW SURVEY  
 OF EXISTING PARCEL  
 TAX MAP, APPROVED  
 E.A.N. 9-2-93