

Survey of a parcel of Red Earth situated in the NW 1/4 of Sec. 5
 TWP 20 R-18 Washington Twp. Richland Co. State of Ohio
 Beginning for same at a point in the center line of SR. 42
 said point being 1026.5' in a North easterly direction in the center
 line of said Rd. from a point where the south line of the NW 1/4
 of Sec. 5 intersects said Road

Thence from said point S. 72° 5' E 330'

Thence North 148' To the N. line of Bogner land

Thence North 72° 37' West 250' to a point in the center line of
 SR. 42.

Thence south westerly in the center line of SR. 42 159.1' to
 to the place of beginning containing 1.00 Acres more or less

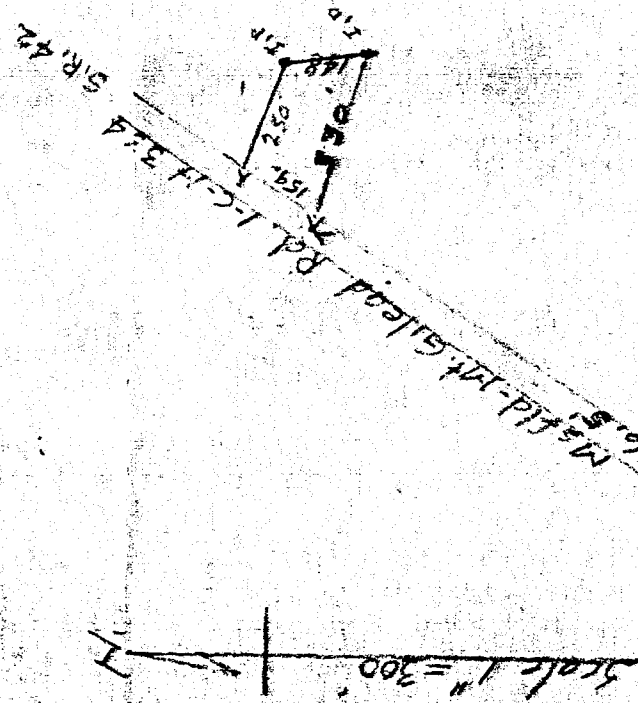

1/4 Sec. line

I Certify that the plat & Notes is correct.

A. G. Korman
 Reg. Surveyor # 925

A-191