

STUART  
VOL  
636  
PAGE  
129



IP WITH PLATE  
DUE WEST  
757.55  
IP WITH PLATE  
BURIED 18"

23.7974 ACRES  
MARVIN W AND LINDA S  
STUART

STUART  
VOL.  
865  
PAGE  
586

STUART  
VOL  
636  
PAGE  
129

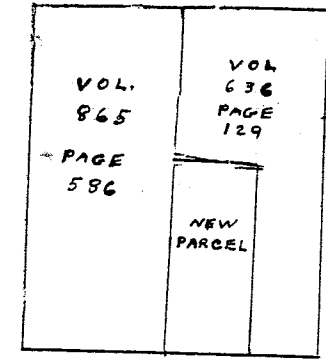

BUTLER TWP RICHLAND CO.  
SECTION 17 TOWNSHIP 25 RANGE 17

S 88-30-00 E  
1328.38

N 88-30-00 W  
1328.38

SYMBOLS

- IRON PIN SET
- RAILROAD SPIKE SET

NOTES:

1. ALL IRON PINS ARE 1/2" x 36" PIPE WITH PLATE MARKED GALLAWAY 5895
2. ALL BEARINGS ARE ASSUMED

I HEREBY CERTIFY THIS PLAT TO BE A TRUE  
DELINEATION OF A SURVEY BY DAVID E  
GALLAWAY IN JUNE 1988.

*David E. Gallaway*  
OHIO REGISTERED SURVEYOR 5895  
JUNE 4 1988

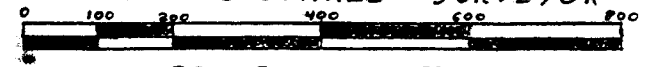

SCALE IN FEET

SCALE 1" = 200'

IP WITH PLATE  
E 25'  
RR SPIKE

757.55  
DUE EAST

25'  
IP WITH PLATE  
RR SPIKE

553.17

N.W. COR.  
S.E. 1/4 SECTION 17  
1/2" REBAR

CRUM ROAD