

GENERAL HIGHWAY MAP RICHLAND COUNTY OHIO

PREPARED BY THE
OHIO STATE HIGHWAY DEPARTMENT
IN COOPERATION WITH THE
DEPARTMENT OF COMMERCE
BUREAU OF PUBLIC ROADS
DATA OBTAINED FROM
STATE-WIDE HIGHWAY PLANNING SURVEY

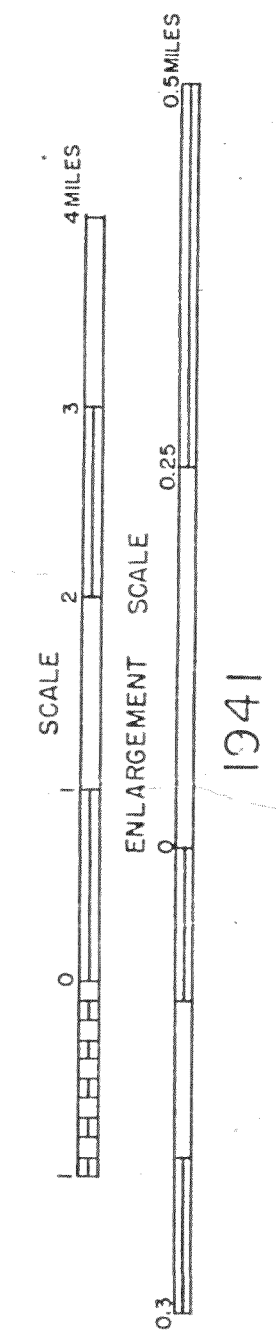

REVISED 1951
State Routes (Surf Type) 1-51
Populations 1-1,500
Population Centers 1-10,000

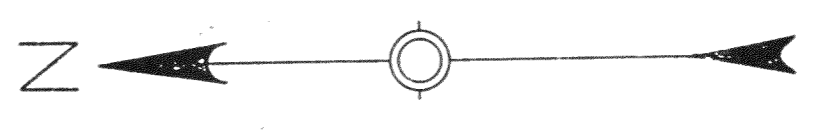

- LEGEND**
- BOUNDARIES**
- COUNTY
 - CIVIL TOWNSHIP
 - SECTION
 - CORPORATION
- CITIES, VILLAGES, HAMLETS**
- COUNTY SEAT
 - OTHER CITY, VILLAGE OR HAMLET
 - UNINCORPORATED PLACE - ENLARGED SHOWN
 - UNINCORPORATED URBAN CONTACT
- ROAD SYSTEM DESIGNATION**
- UNITED STATES HIGHWAY
 - STATE HIGHWAY SYSTEM
 - COUNTY OR TOWNSHIP ROAD
 - FEDERAL AID PRIMARY SYSTEM
 - MILEAGE
- RAILWAYS**
- RAILROAD
 - RAILROAD STATION
 - RAILROAD GRADE CROSSING
 - RAILROAD ABOVE ROAD
 - RAILROAD BELOW ROAD
- STRUCTURES AND STREAM CROSSINGS**
- GENERAL HIGHWAY BRIDGE
 - HIGHWAY CULVERT
- AIRWAYS**
- COMMERCIAL OR MUNICIPAL FIELD
- DRAINAGE**
- INTERMITTENT STREAM
 - NARROW STREAM
- ROAD TYPES**
- UNIMPROVED ROAD
 - GRADED AND DRAINED EARTH
 - SOIL SURFACED ROAD
 - METAL SURFACED ROAD
 - BITUMINOUS SURFACED ROAD (LOW)
 - PAVED ROAD
- GENERAL CULTURAL FEATURES**
- FARM
 - WELL
 - MINING
 - STONE OR SMALL BUSINESS
 - TOWNSHIP OR COMMUNITY HALL
 - CHURCH
 - SCHOOL
 - INDUSTRIAL PLANT
 - POST OFFICE
 - ROADSIDE PARK
 - RIDING ACADEMY
 - ORCHARD
 - GAME PRESERVE
 - SEASONAL DWELLING
 - SEASONAL DWELLINGS CLOSELY SPACED
 - SEASONAL DWELLINGS WIDELY SPACED
 - GREEN HOUSE
 - SEASONAL INDUSTRY
 - GOLF COURSE CC, COUNTRY CLUB CC
 - KILN (TILE, BRICK, ECT.)
 - PLAYGROUND, BALLFIELD, ECT.
 - TOURIST CAMP
 - AMUSEMENT PARK
 - GAUGING OR PUMPING STATION
 - GRAVEL PIT
 - CORRECTIONAL INSTITUTION
 - POWER PLANT
 - SAW MILL
 - WATER POND, OR LAKE
 - SWAMP
 - FAIRGROUND
 - HIGHWAY GARAGE
 - JUNK YARD
 - OIL WELL
 - STATE HIGHWAY PATROL

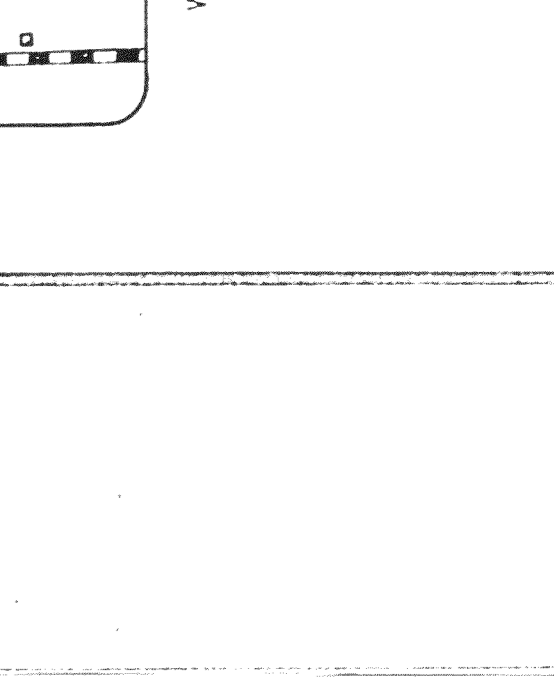
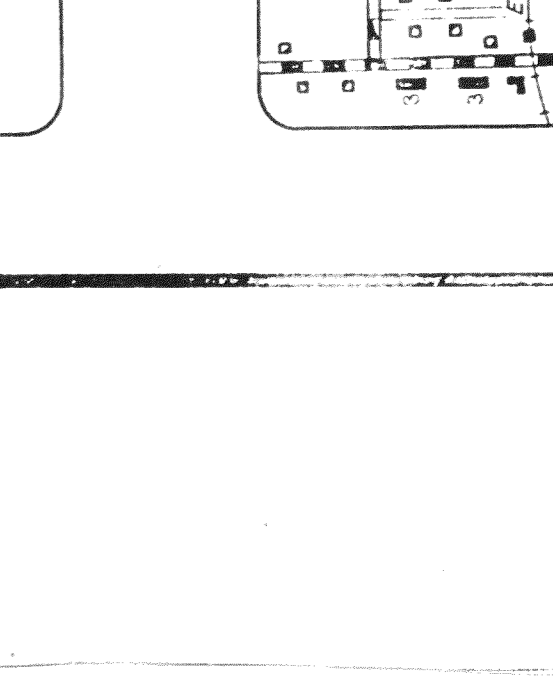
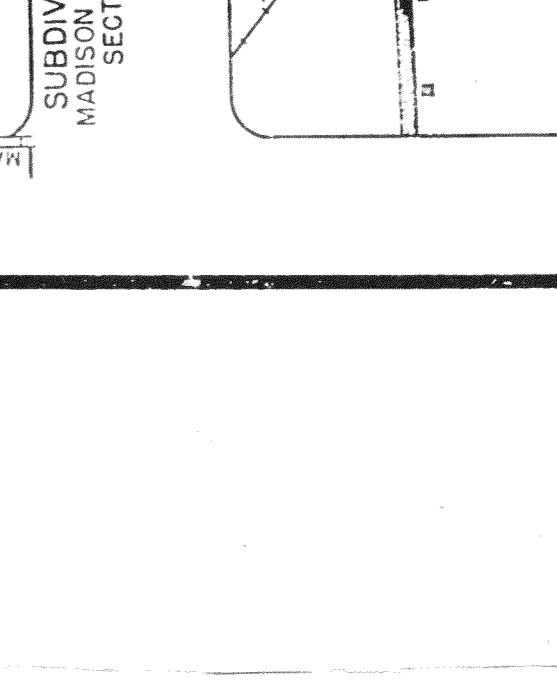
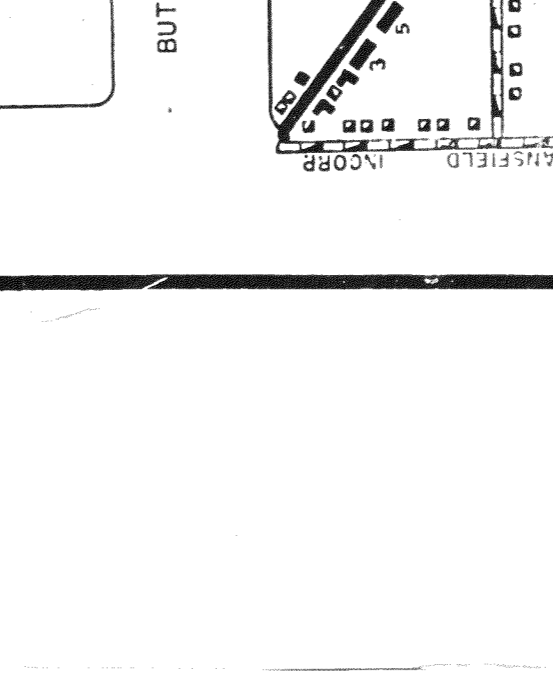
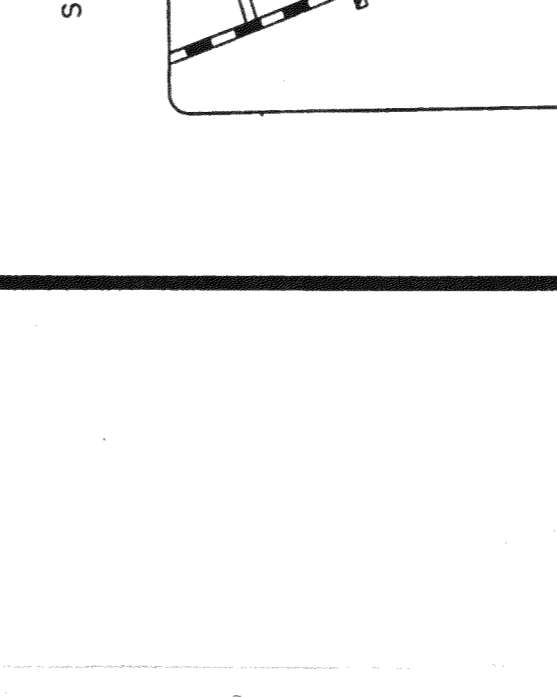
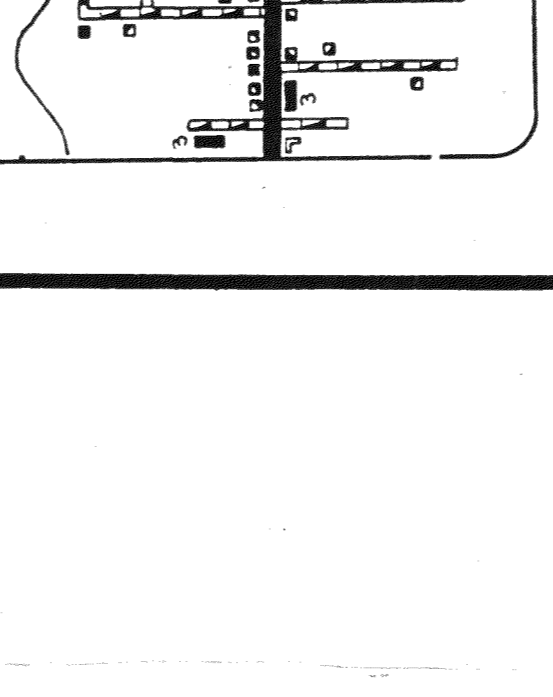
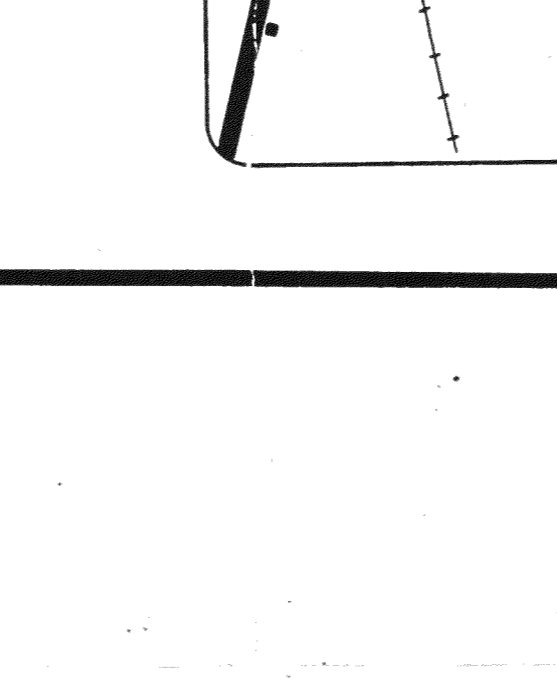
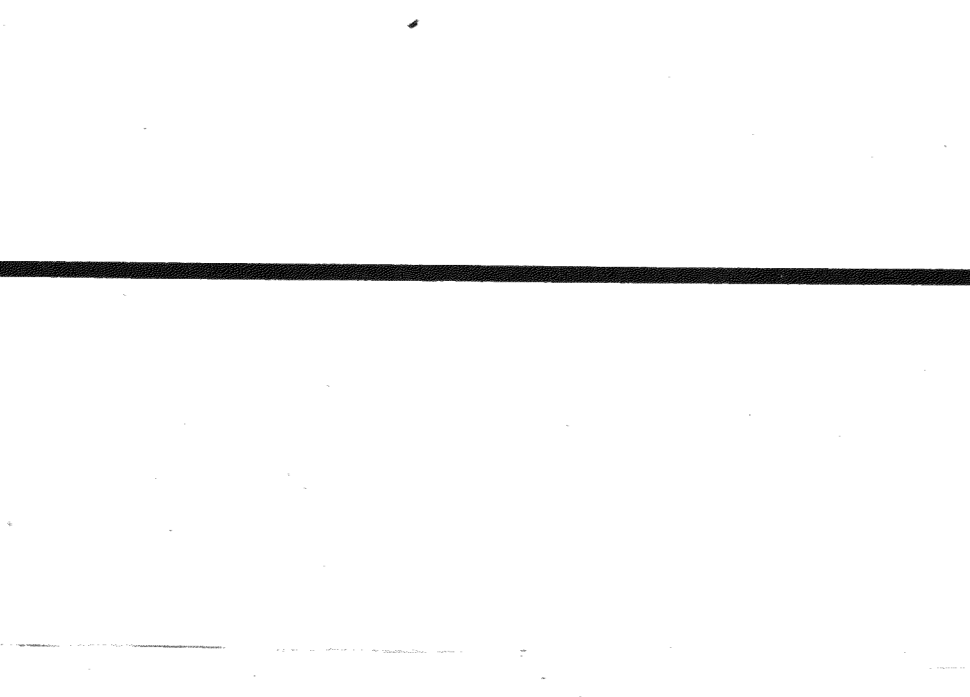
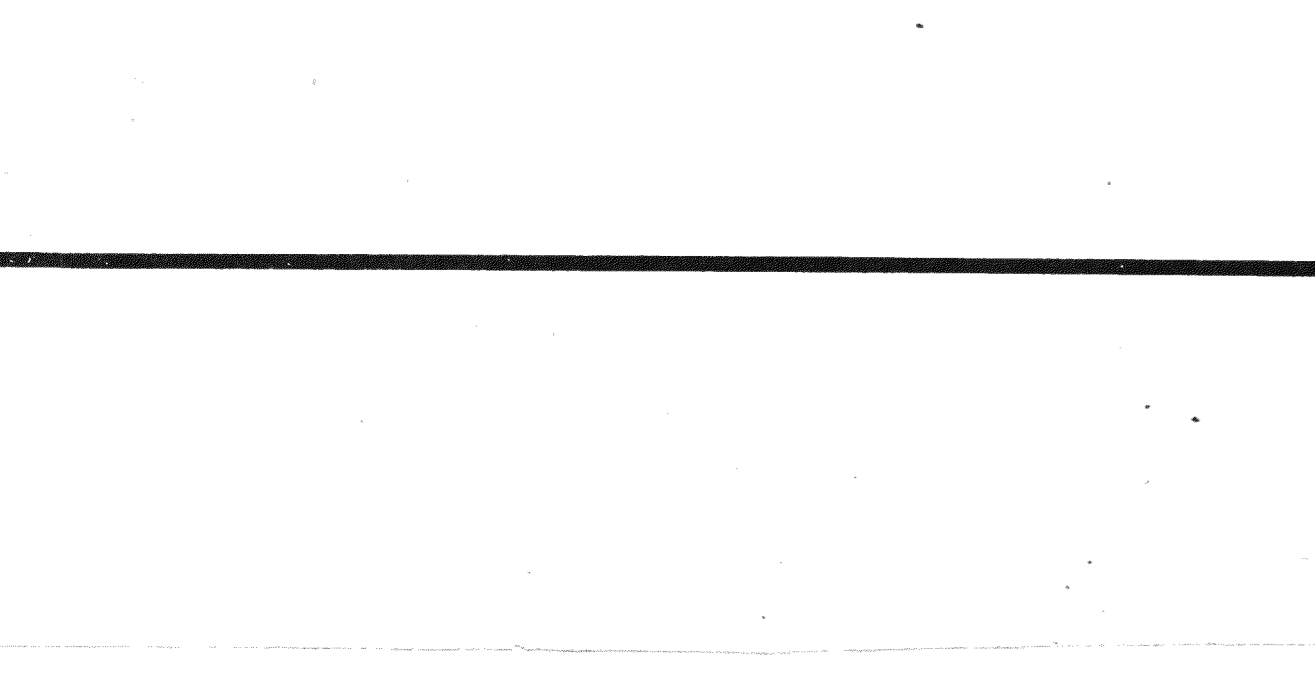
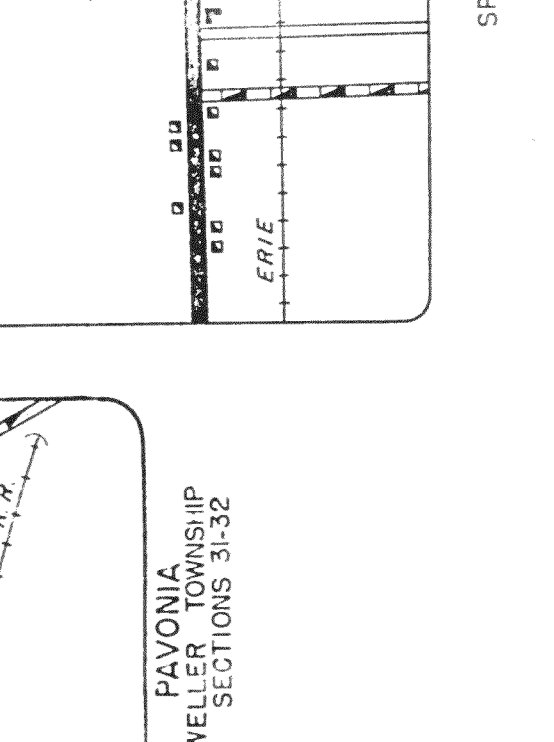
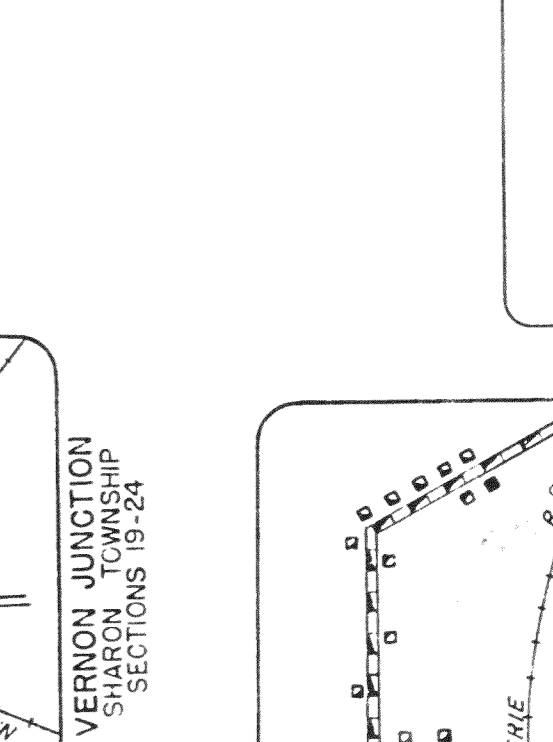
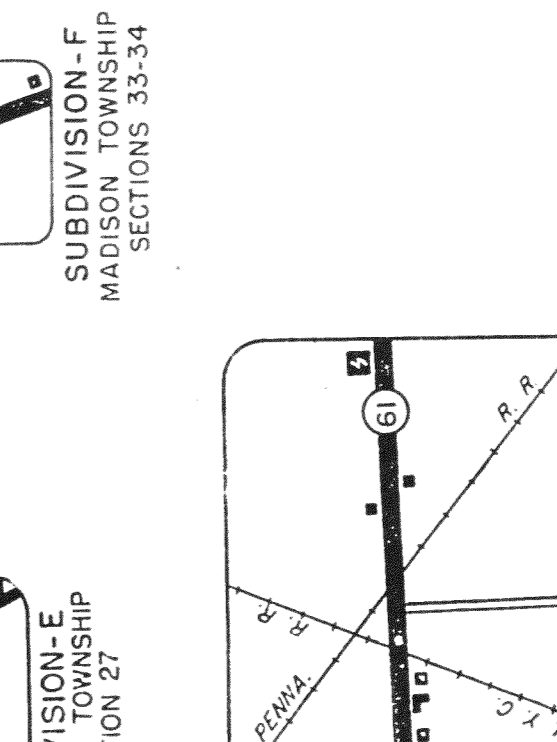
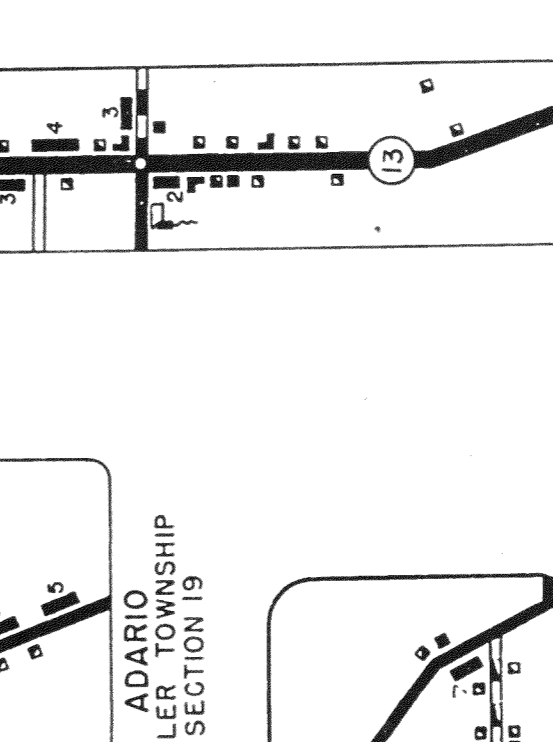
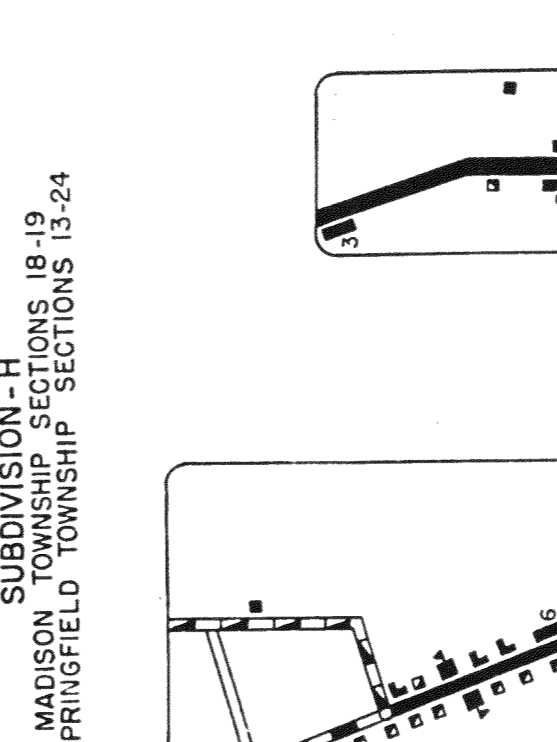
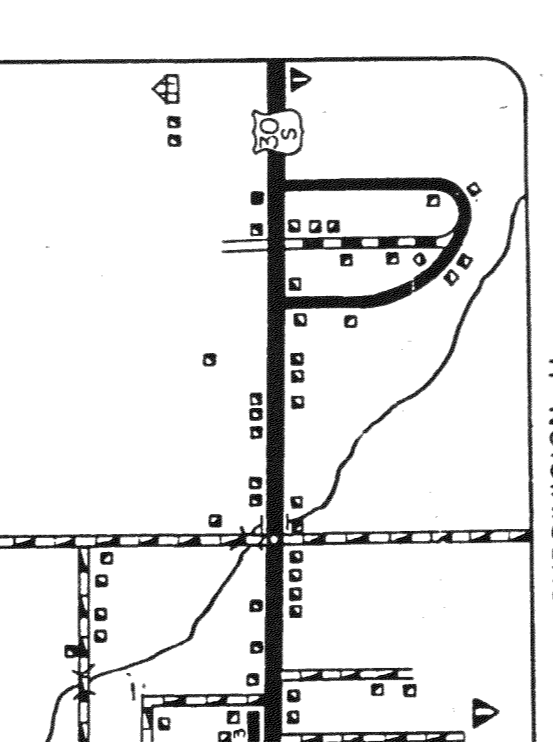
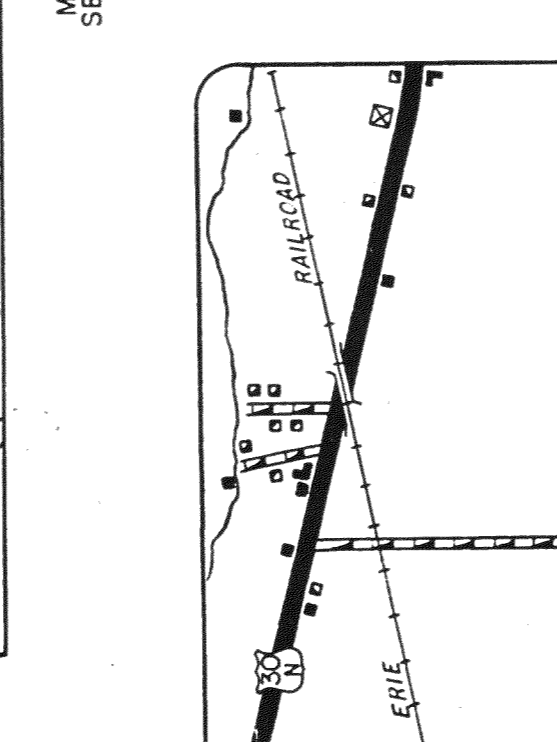
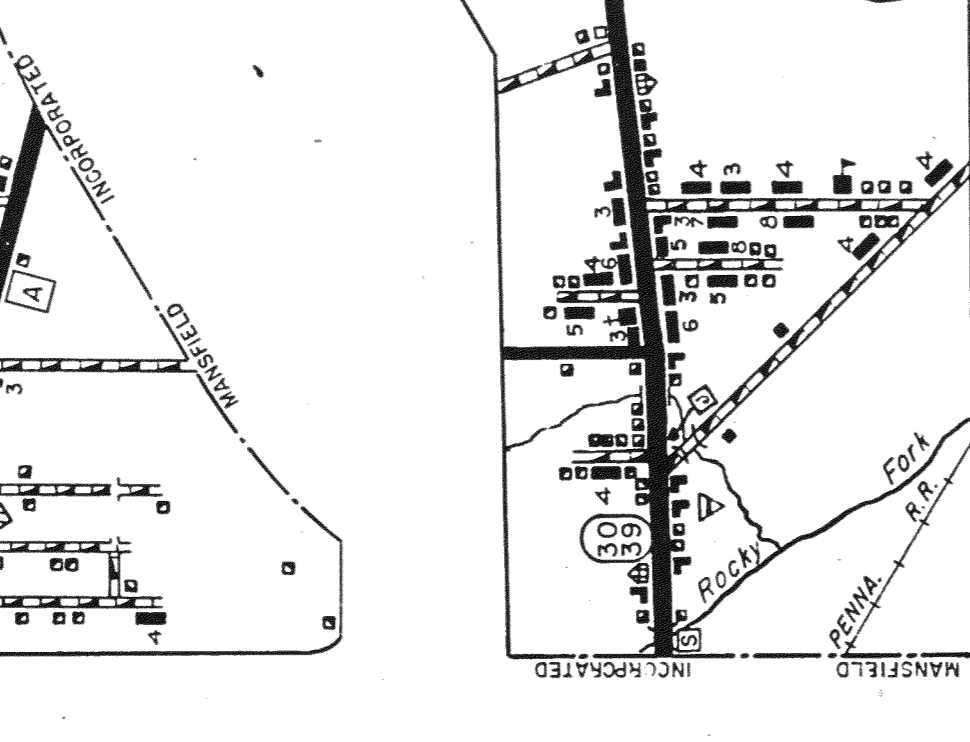
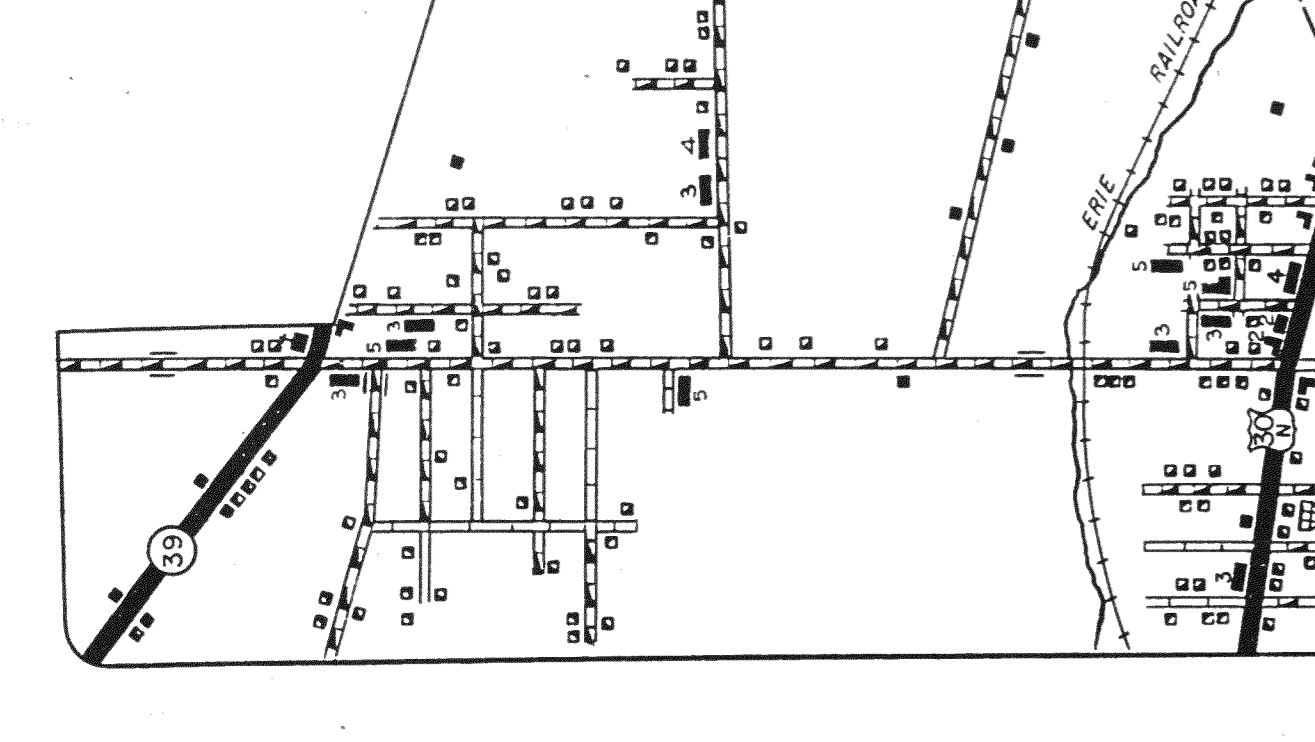
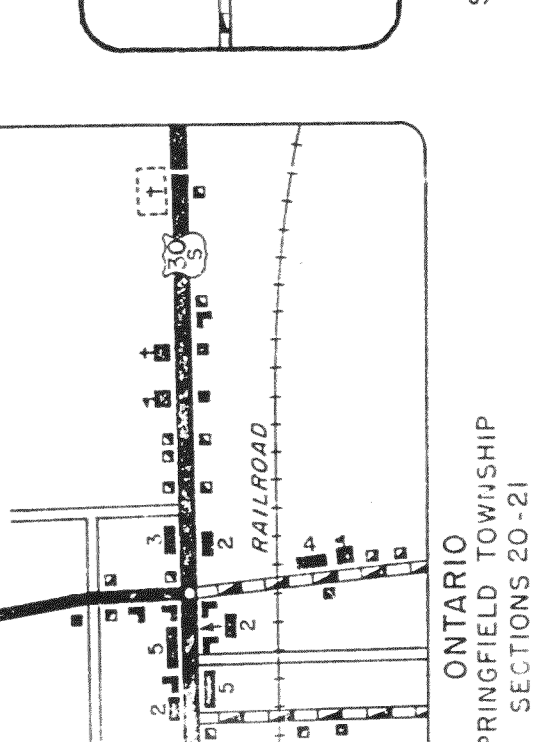
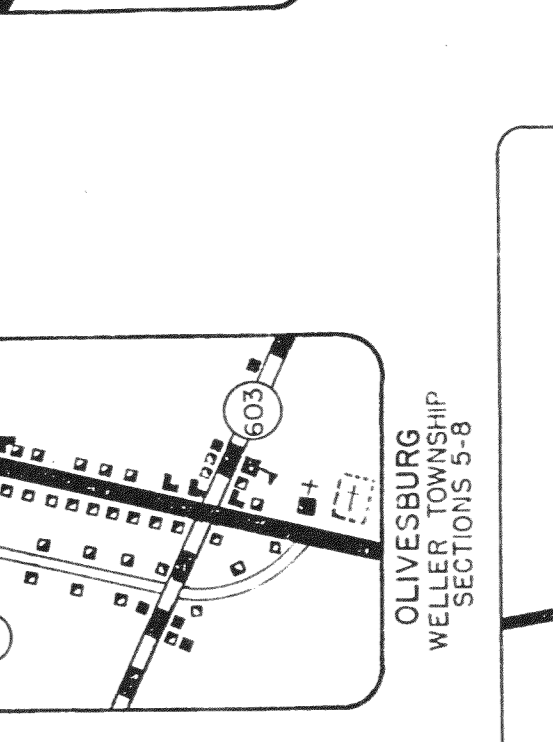
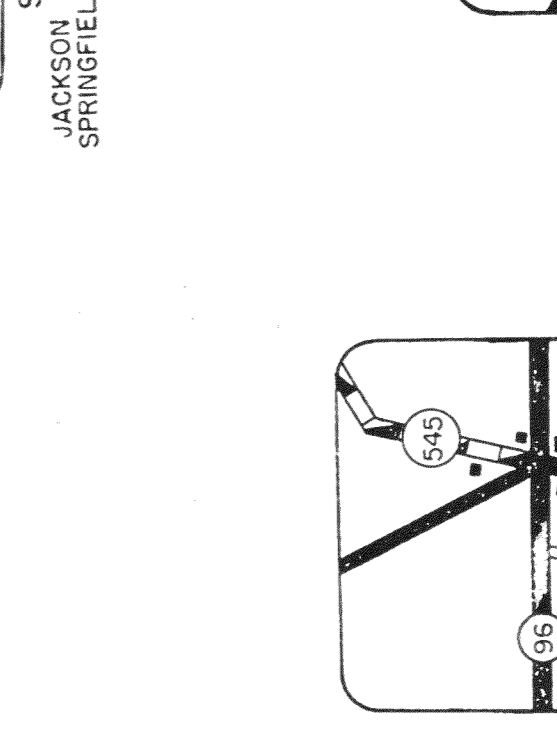
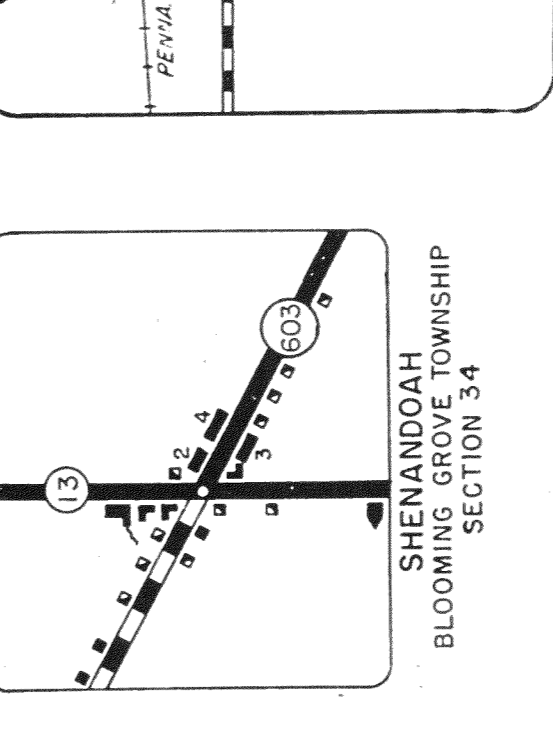
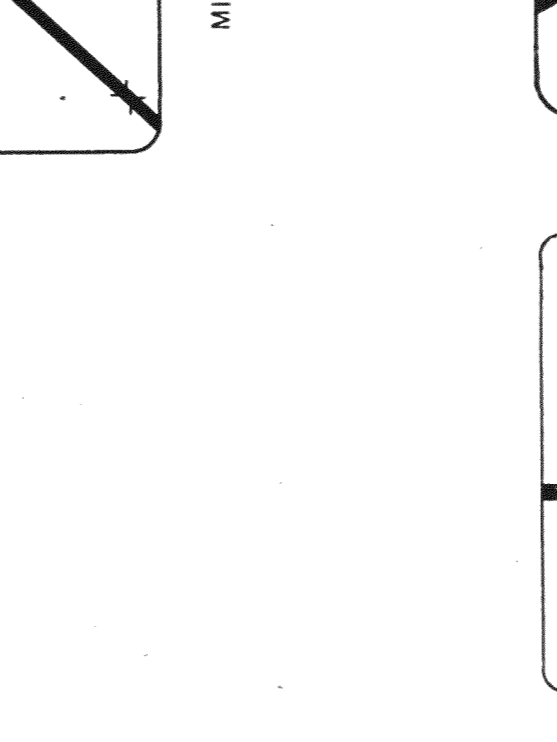
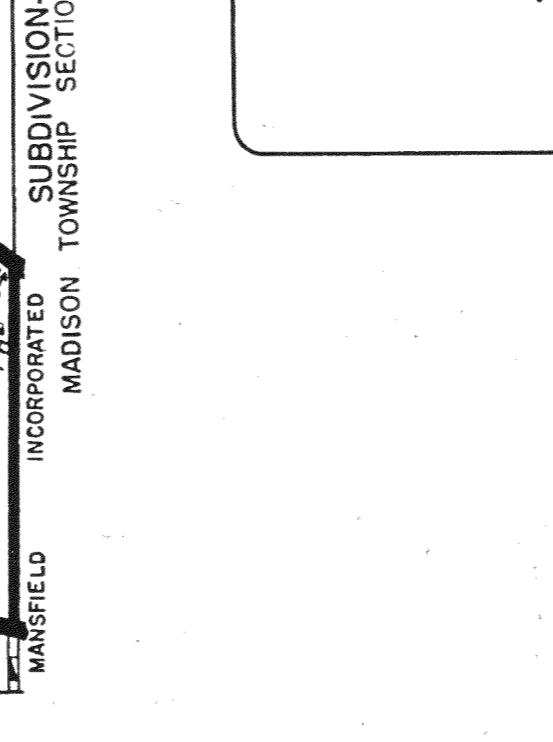
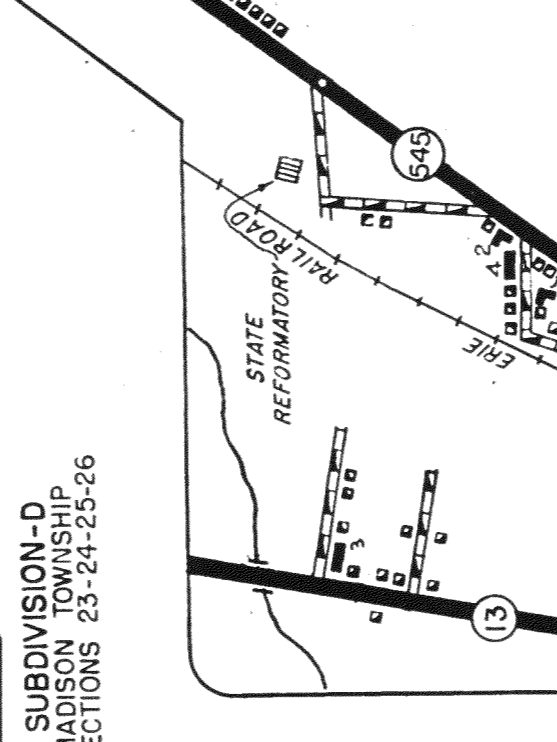
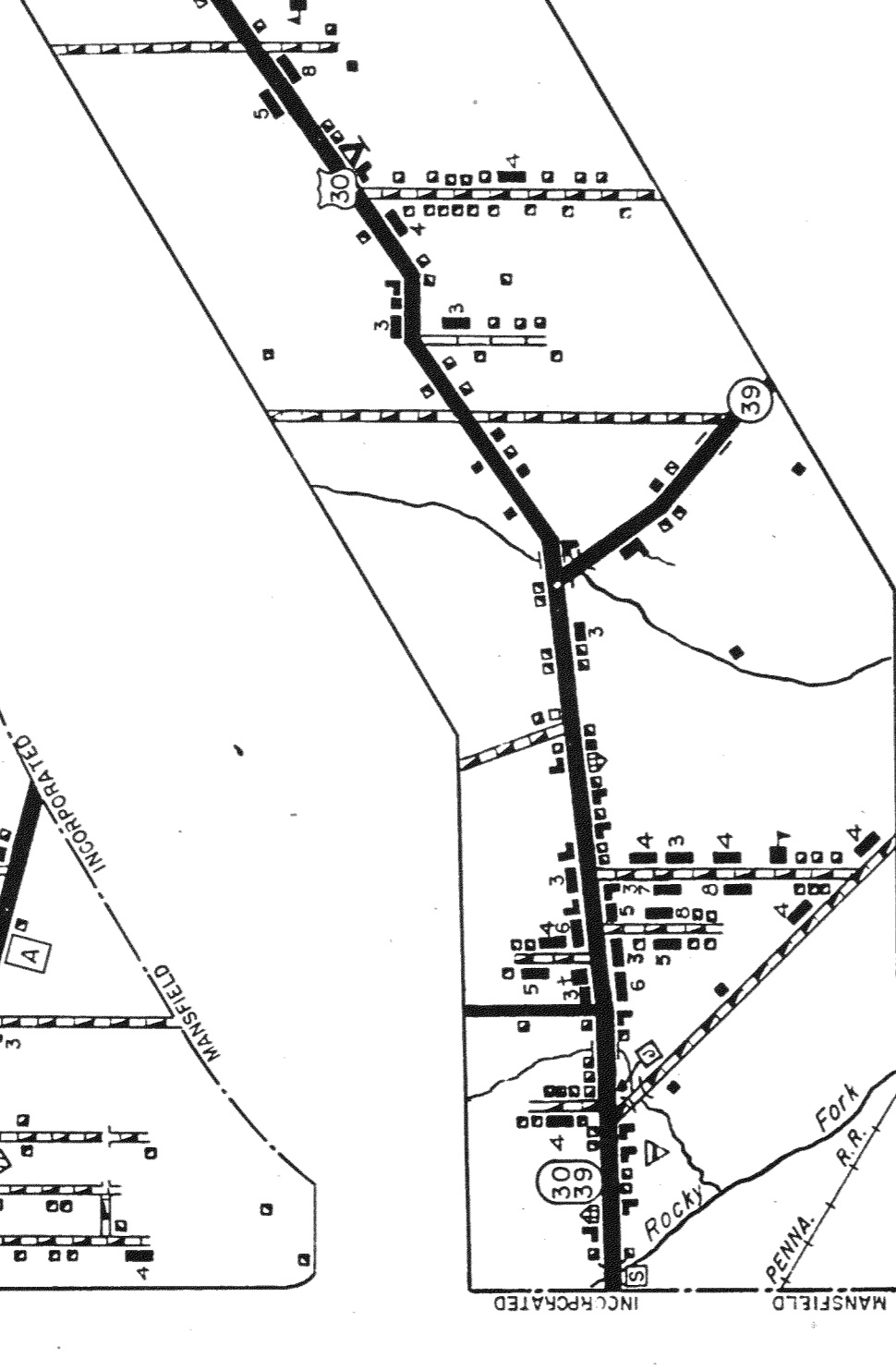
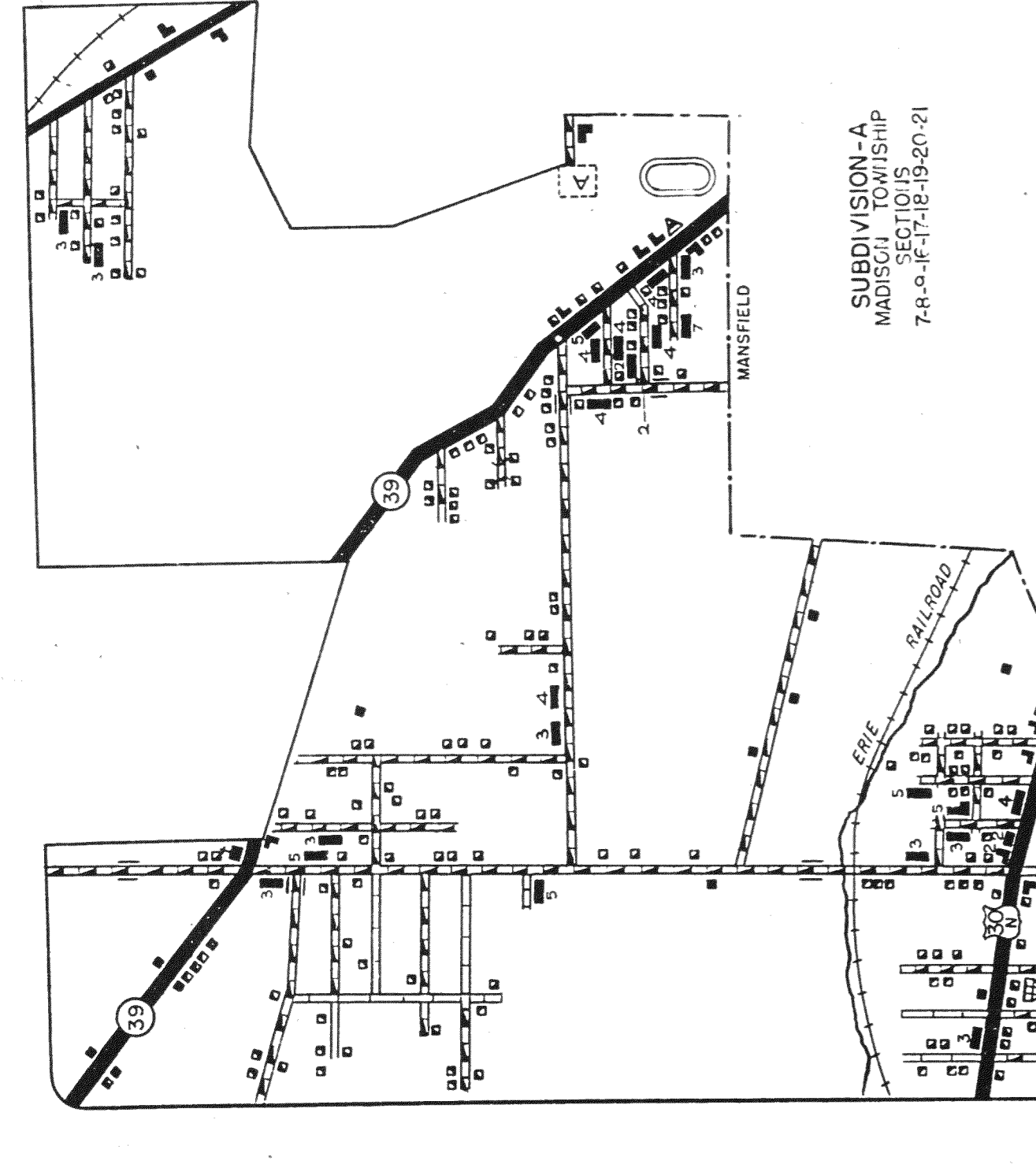
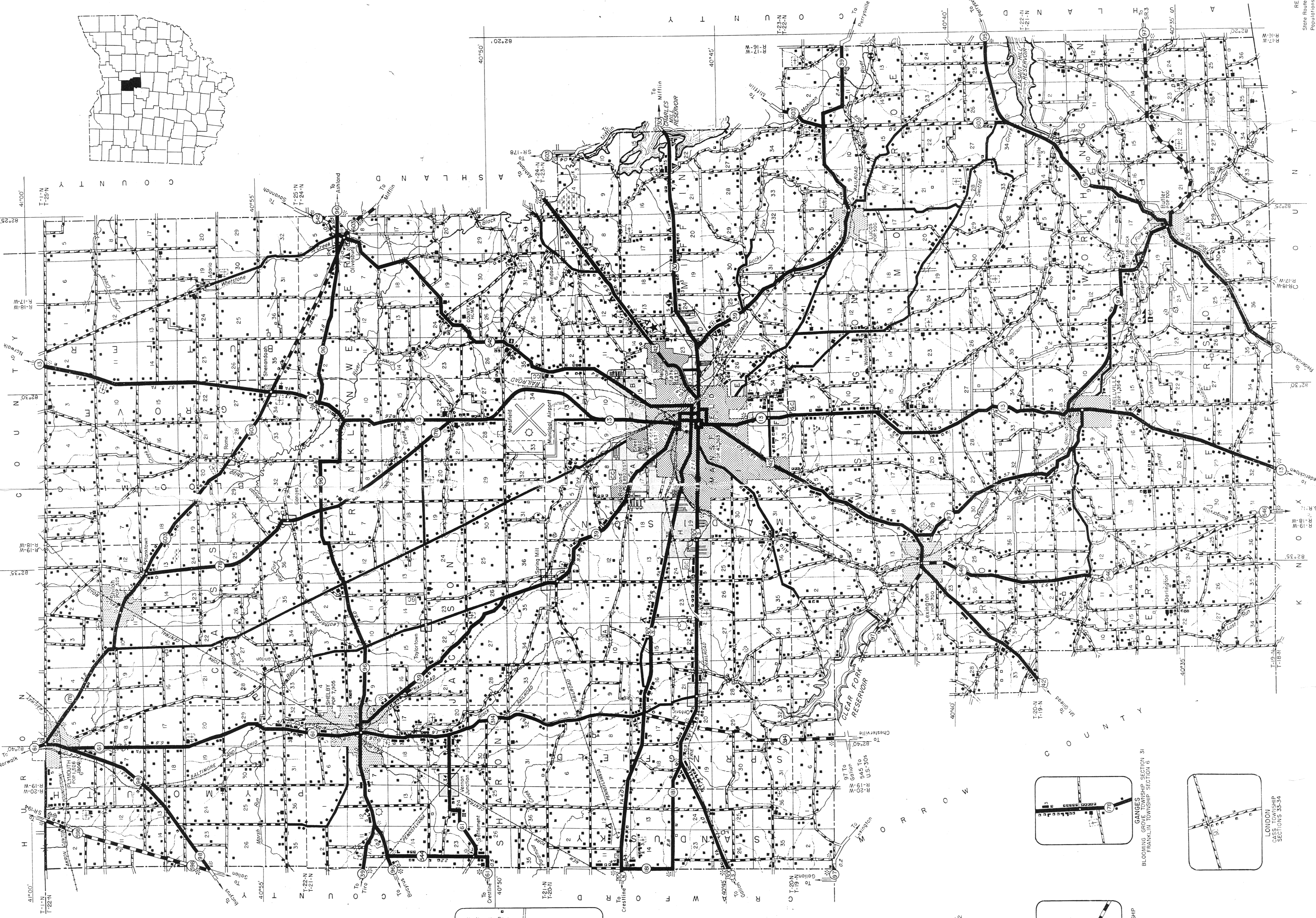

REVISED 1951
State Routes (Surf Type) 1-51
Populations 1-1,500
Population Centers 1-10,000