

PLAT BOOK

OF

RICHLAND COUNTY

OHIO

Published by

W.W.HIXSON & CO.

Rockford, Illinois

1940

- LEGEND
- Improved Township Roads
 - Improved County Roads
 - Improved State Roads
 - Unimproved Roads
 - Railroads
 - County Line
 - Township Line
 - Section Line
 - State Houses
 - Cometaries

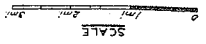

1940
H.C. SWORD - COUNTY ENGINEER

ROAD MAP
OF
RICHLAND COUNTY

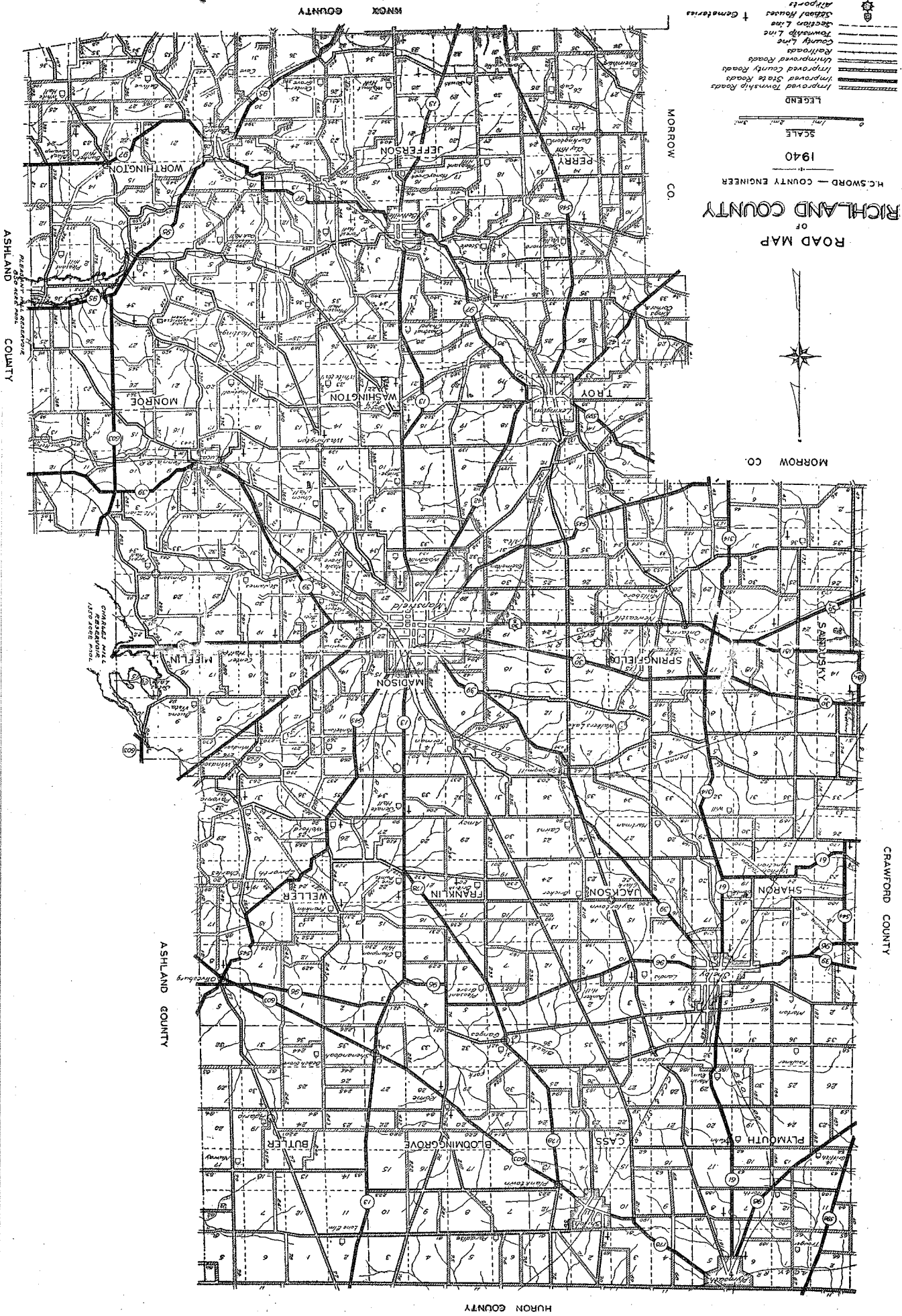

ASHLAND COUNTY

ASHLAND COUNTY

HURON COUNTY

CRAWFORD COUNTY

MORROW CO.

MORROW CO.

MORROW COUNTY



WARD Boundaries
PRECINCT
SCALE

THE CITY OF
MANSFIELD, O.

N

BLOOMING GROVE

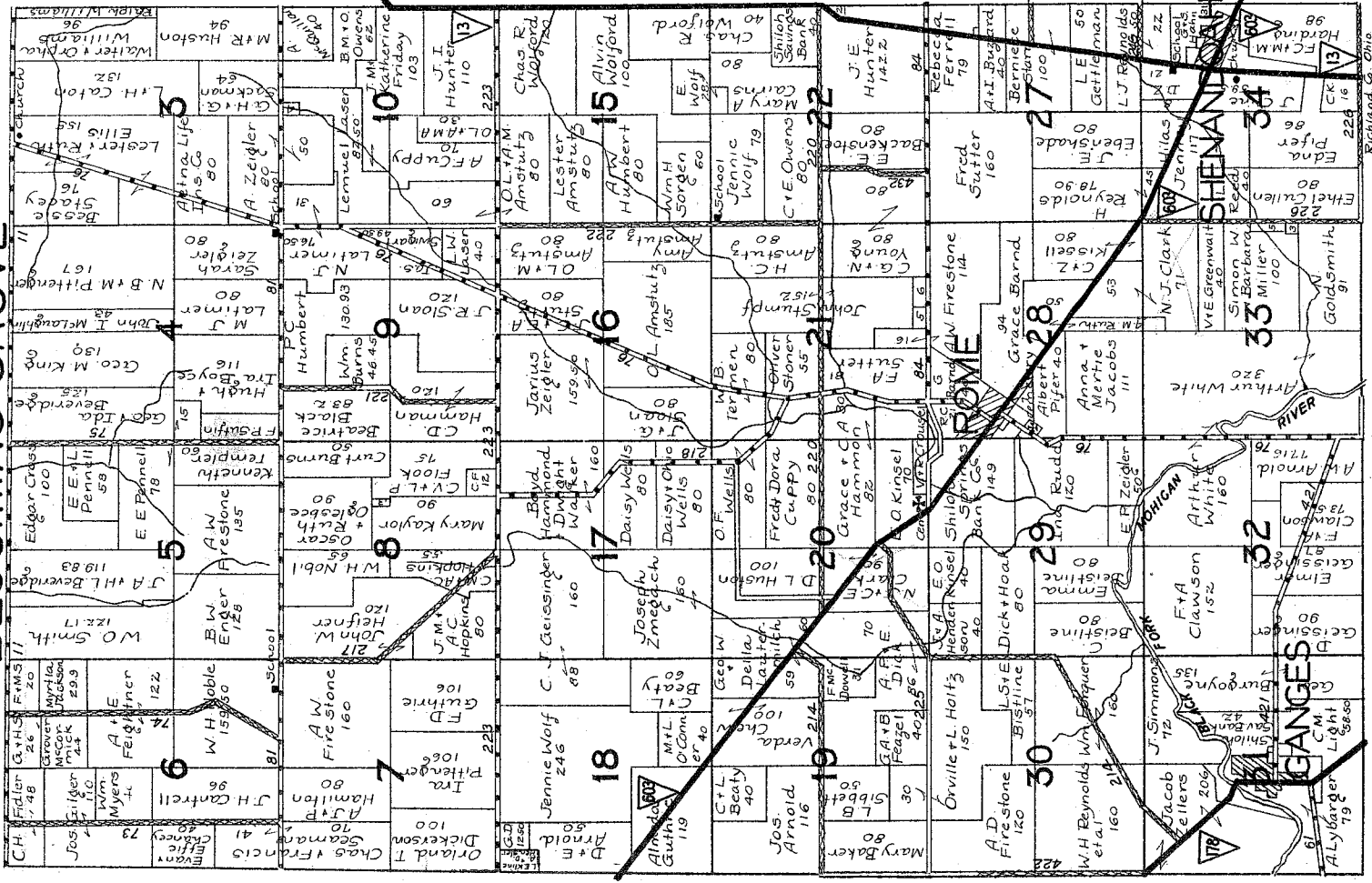

Richard G. Ohio

BUTLER

<p>13 C.M. Gilman 1150 A.V. Wright 57 M.V. & S.A. Vanscoy 151 M. Kaynick 34 Mary E. Hans 108 Lecker Niman 86 E. Stimpfle 80 G. L. Boyd 24</p>	<p>14 M. & S.A. Vanscoy 151 F.M. Schubert 38 C.H. Stewart 80 C.R. Wittig 74 W.J.C. Stewart 160 G.A. Hugh 160 H.J. Patterson 160 C.H. Fowler 160 E.C. Bloom 80 M.R. Barnes 80 Wm. Yoha 80 W.H. Paramore 240 R.M. Huston 132 S.H. Friday 211</p>	<p>15 Ralph Williams 89 P.N. Jenney 125 G. G. Franzen 1975 W.H. Paramore 240 C.H. Fowler 160 E.C. Bloom 80 M.R. Barnes 80 Wm. Yoha 80 Geo. E. & C. Huston 100 Leda Taylor et al 100 L. Dickson et al 100 O.G. Huston 100 G. Cates 160 A.L. Wolford 160 C. Wolford 40 Shiah Sav. Bank 80 W. Seaton 80 Rebecca Ferrell 45 Otto Long 245 W.A. Kearns 160</p>	<p>16 M.V. & S.A. Vanscoy 151 F.M. Schubert 38 C.H. Stewart 80 C.R. Wittig 74 W.J.C. Stewart 160 G.A. Hugh 160 H.J. Patterson 160 C.H. Fowler 160 E.C. Bloom 80 M.R. Barnes 80 Wm. Yoha 80 W.H. Paramore 240 R.M. Huston 132 S.H. Friday 211 A.F. Cuppy 78.66 Chas. Crum 77.64</p>	<p>17 R.B. DeWitt 120 Geo. Crum 40 A.L. Wolford 160 C. Wolford 40 Shiah Sav. Bank 80 W. Seaton 80 Rebecca Ferrell 45 Otto Long 245 W.A. Kearns 160</p>	<p>18 Wm. Yoha 80 W.H. Paramore 240 R.M. Huston 132 S.H. Friday 211 A.F. Cuppy 78.66 Chas. Crum 77.64 A.L. Wolford 160 C. Wolford 40 Shiah Sav. Bank 80 W. Seaton 80 Rebecca Ferrell 45 Otto Long 245 W.A. Kearns 160</p>	<p>19 Wm. Yoha 80 W.H. Paramore 240 R.M. Huston 132 S.H. Friday 211 A.F. Cuppy 78.66 Chas. Crum 77.64 A.L. Wolford 160 C. Wolford 40 Shiah Sav. Bank 80 W. Seaton 80 Rebecca Ferrell 45 Otto Long 245 W.A. Kearns 160</p>	<p>20 Wm. Yoha 80 W.H. Paramore 240 R.M. Huston 132 S.H. Friday 211 A.F. Cuppy 78.66 Chas. Crum 77.64 A.L. Wolford 160 C. Wolford 40 Shiah Sav. Bank 80 W. Seaton 80 Rebecca Ferrell 45 Otto Long 245 W.A. Kearns 160</p>	<p>21 Wm. Yoha 80 W.H. Paramore 240 R.M. Huston 132 S.H. Friday 211 A.F. Cuppy 78.66 Chas. Crum 77.64 A.L. Wolford 160 C. Wolford 40 Shiah Sav. Bank 80 W. Seaton 80 Rebecca Ferrell 45 Otto Long 245 W.A. Kearns 160</p>	<p>22 Wm. Yoha 80 W.H. Paramore 240 R.M. Huston 132 S.H. Friday 211 A.F. Cuppy 78.66 Chas. Crum 77.64 A.L. Wolford 160 C. Wolford 40 Shiah Sav. Bank 80 W. Seaton 80 Rebecca Ferrell 45 Otto Long 245 W.A. Kearns 160</p>	<p>23 Wm. Yoha 80 W.H. Paramore 240 R.M. Huston 132 S.H. Friday 211 A.F. Cuppy 78.66 Chas. Crum 77.64 A.L. Wolford 160 C. Wolford 40 Shiah Sav. Bank 80 W. Seaton 80 Rebecca Ferrell 45 Otto Long 245 W.A. Kearns 160</p>	<p>24 Wm. Yoha 80 W.H. Paramore 240 R.M. Huston 132 S.H. Friday 211 A.F. Cuppy 78.66 Chas. Crum 77.64 A.L. Wolford 160 C. Wolford 40 Shiah Sav. Bank 80 W. Seaton 80 Rebecca Ferrell 45 Otto Long 245 W.A. Kearns 160</p>	<p>25 Wm. Yoha 80 W.H. Paramore 240 R.M. Huston 132 S.H. Friday 211 A.F. Cuppy 78.66 Chas. Crum 77.64 A.L. Wolford 160 C. Wolford 40 Shiah Sav. Bank 80 W. Seaton 80 Rebecca Ferrell 45 Otto Long 245 W.A. Kearns 160</p>	<p>26 Wm. Yoha 80 W.H. Paramore 240 R.M. Huston 132 S.H. Friday 211 A.F. Cuppy 78.66 Chas. Crum 77.64 A.L. Wolford 160 C. Wolford 40 Shiah Sav. Bank 80 W. Seaton 80 Rebecca Ferrell 45 Otto Long 245 W.A. Kearns 160</p>	<p>27 Wm. Yoha 80 W.H. Paramore 240 R.M. Huston 132 S.H. Friday 211 A.F. Cuppy 78.66 Chas. Crum 77.64 A.L. Wolford 160 C. Wolford 40 Shiah Sav. Bank 80 W. Seaton 80 Rebecca Ferrell 45 Otto Long 245 W.A. Kearns 160</p>	<p>28 Wm. Yoha 80 W.H. Paramore 240 R.M. Huston 132 S.H. Friday 211 A.F. Cuppy 78.66 Chas. Crum 77.64 A.L. Wolford 160 C. Wolford 40 Shiah Sav. Bank 80 W. Seaton 80 Rebecca Ferrell 45 Otto Long 245 W.A. Kearns 160</p>	<p>29 Wm. Yoha 80 W.H. Paramore 240 R.M. Huston 132 S.H. Friday 211 A.F. Cuppy 78.66 Chas. Crum 77.64 A.L. Wolford 160 C. Wolford 40 Shiah Sav. Bank 80 W. Seaton 80 Rebecca Ferrell 45 Otto Long 245 W.A. Kearns 160</p>	<p>30 Wm. Yoha 80 W.H. Paramore 240 R.M. Huston 132 S.H. Friday 211 A.F. Cuppy 78.66 Chas. Crum 77.64 A.L. Wolford 160 C. Wolford 40 Shiah Sav. Bank 80 W. Seaton 80 Rebecca Ferrell 45 Otto Long 245 W.A. Kearns 160</p>	<p>31 Wm. Yoha 80 W.H. Paramore 240 R.M. Huston 132 S.H. Friday 211 A.F. Cuppy 78.66 Chas. Crum 77.64 A.L. Wolford 160 C. Wolford 40 Shiah Sav. Bank 80 W. Seaton 80 Rebecca Ferrell 45 Otto Long 245 W.A. Kearns 160</p>	<p>32 Wm. Yoha 80 W.H. Paramore 240 R.M. Huston 132 S.H. Friday 211 A.F. Cuppy 78.66 Chas. Crum 77.64 A.L. Wolford 160 C. Wolford 40 Shiah Sav. Bank 80 W. Seaton 80 Rebecca Ferrell 45 Otto Long 245 W.A. Kearns 160</p>	<p>33 Wm. Yoha 80 W.H. Paramore 240 R.M. Huston 132 S.H. Friday 211 A.F. Cuppy 78.66 Chas. Crum 77.64 A.L. Wolford 160 C. Wolford 40 Shiah Sav. Bank 80 W. Seaton 80 Rebecca Ferrell 45 Otto Long 245 W.A. Kearns 160</p>
---	--	---	--	--	---	---	---	---	---	---	---	---	---	---	---	---	---	---	---	---

185 - 800

14555
14573

FRANKLIN

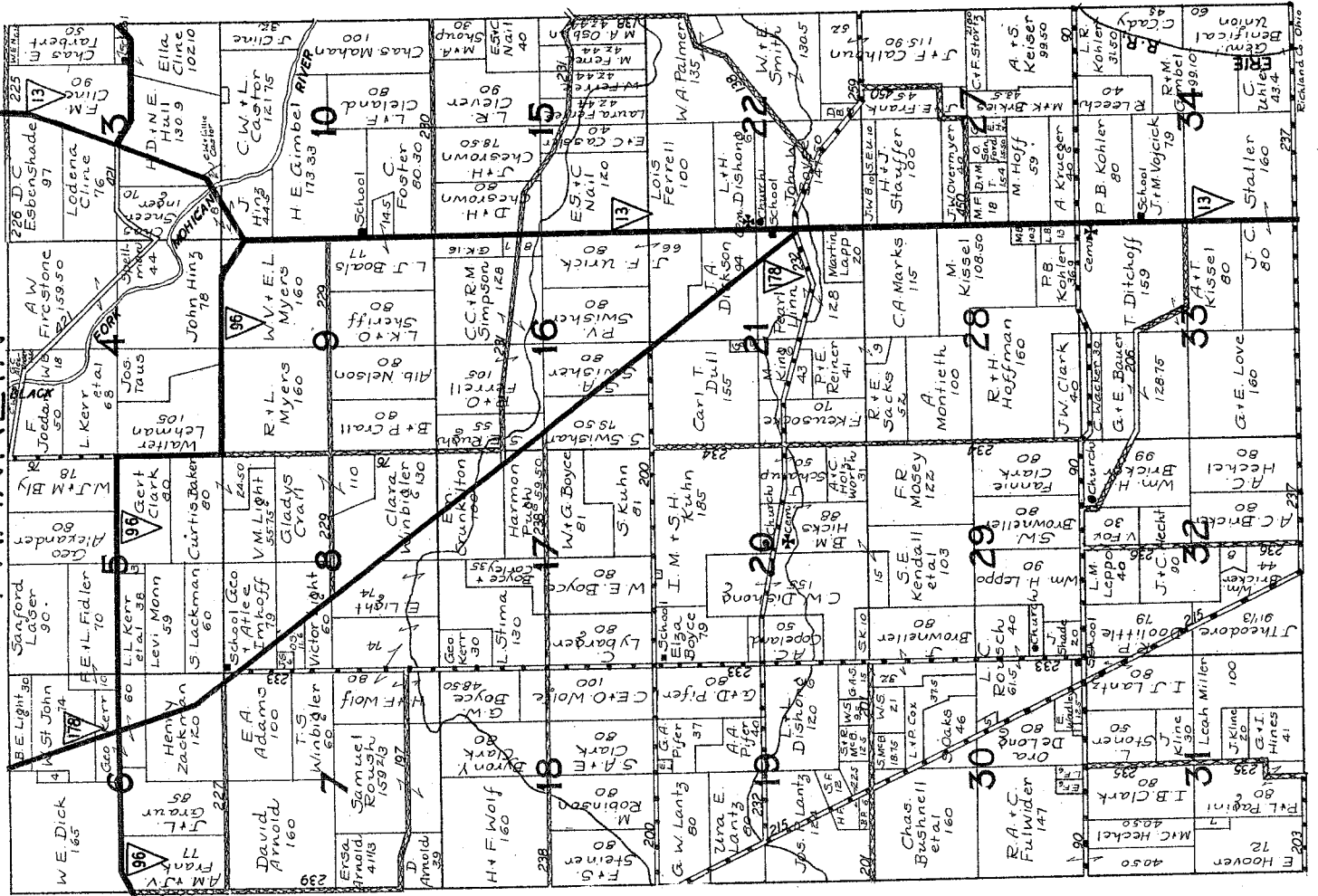

JACKSON

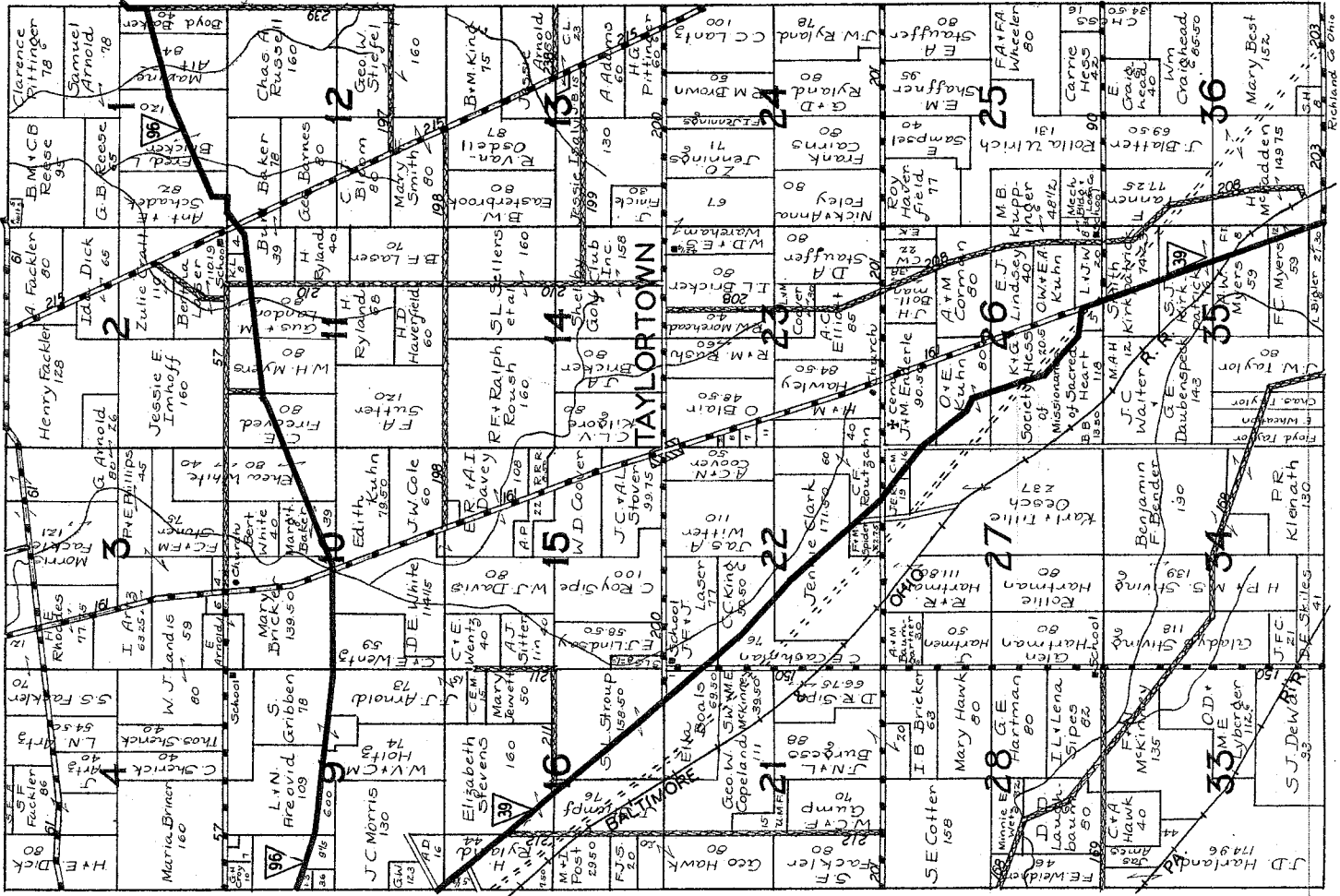

Richland Co Ohio

JACKSON

JACKSON

JACKSON

JEFFERSON

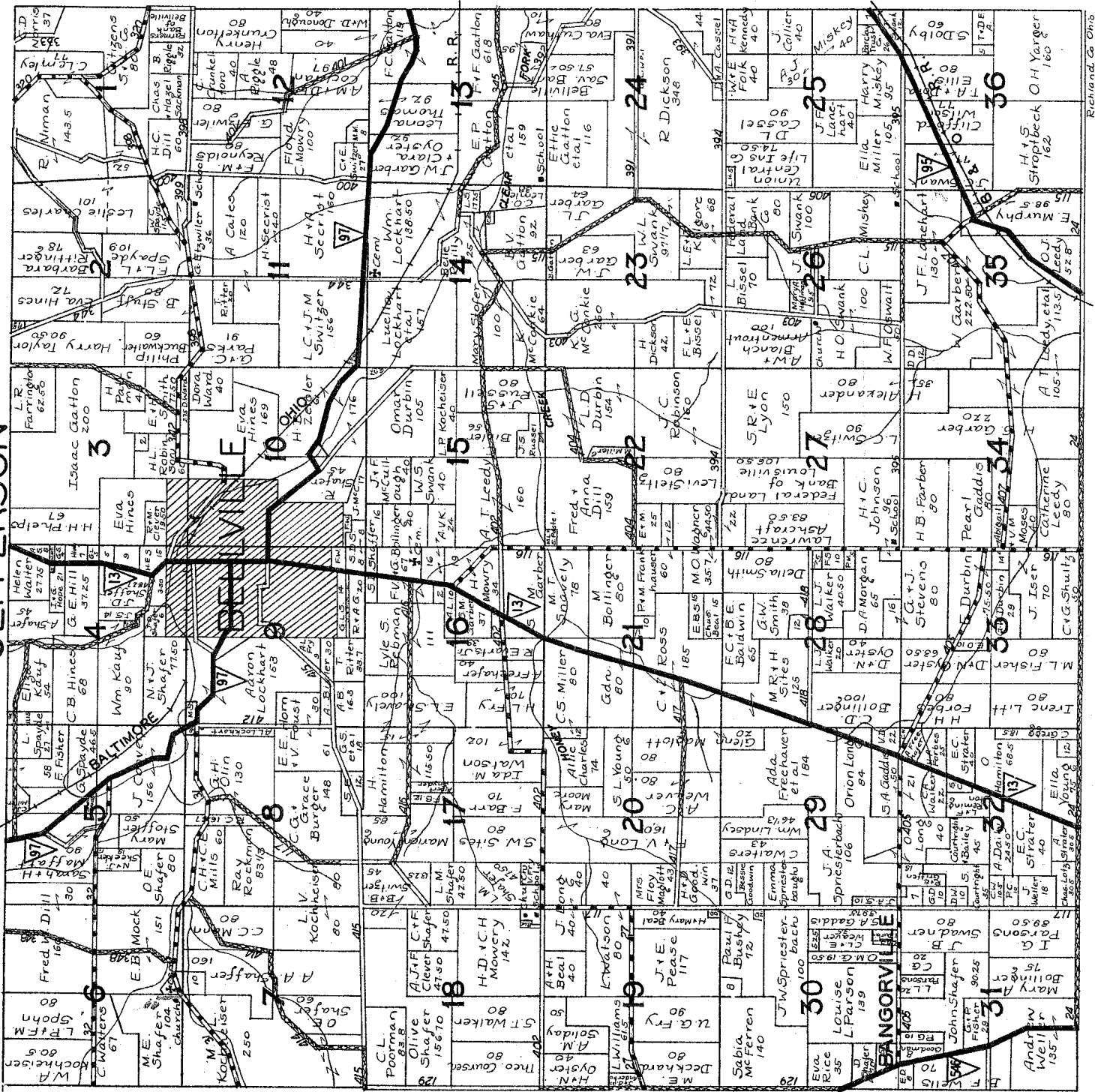

Richard Co. Ohio

MAD SON

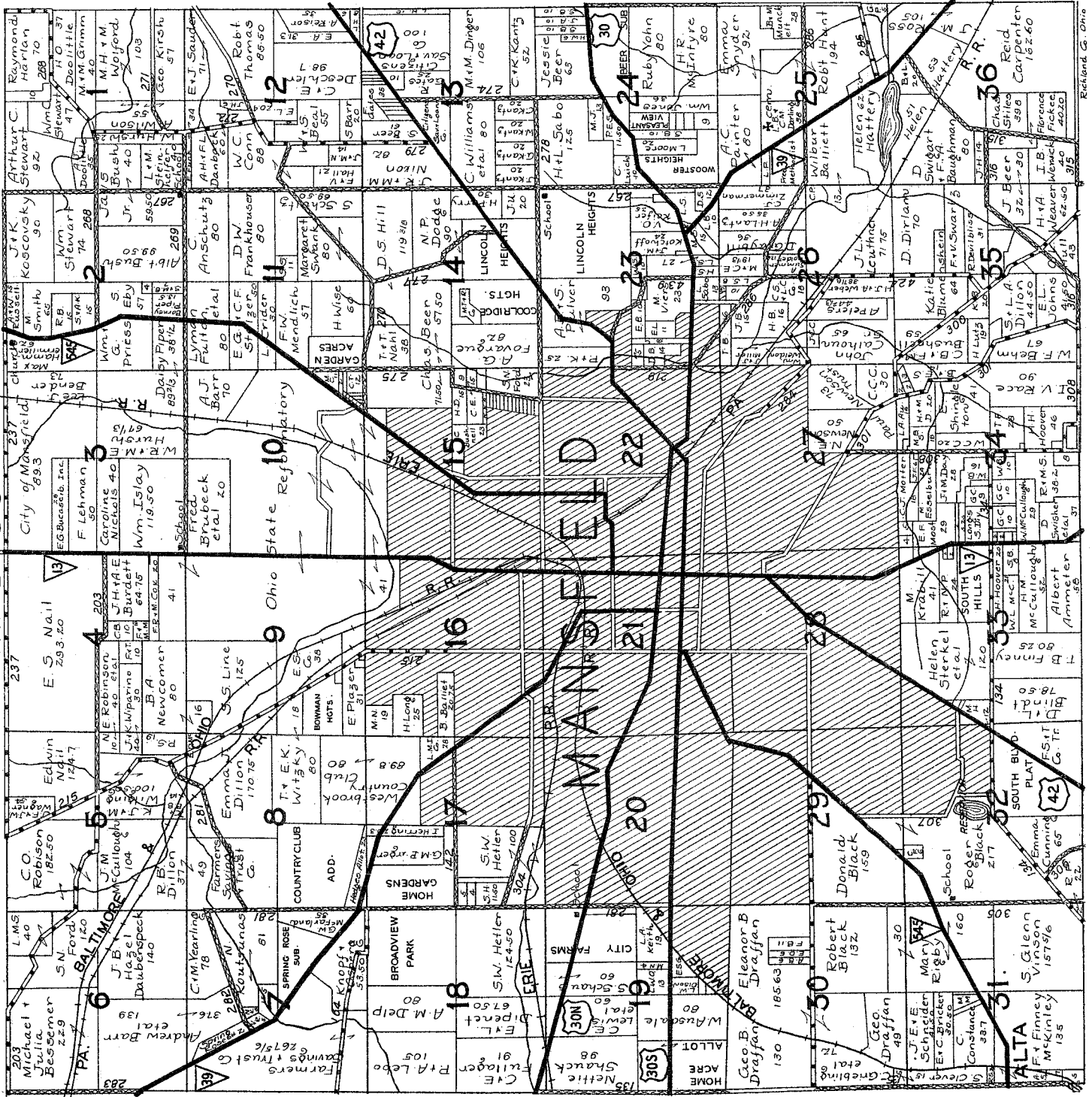

MIFFLIN

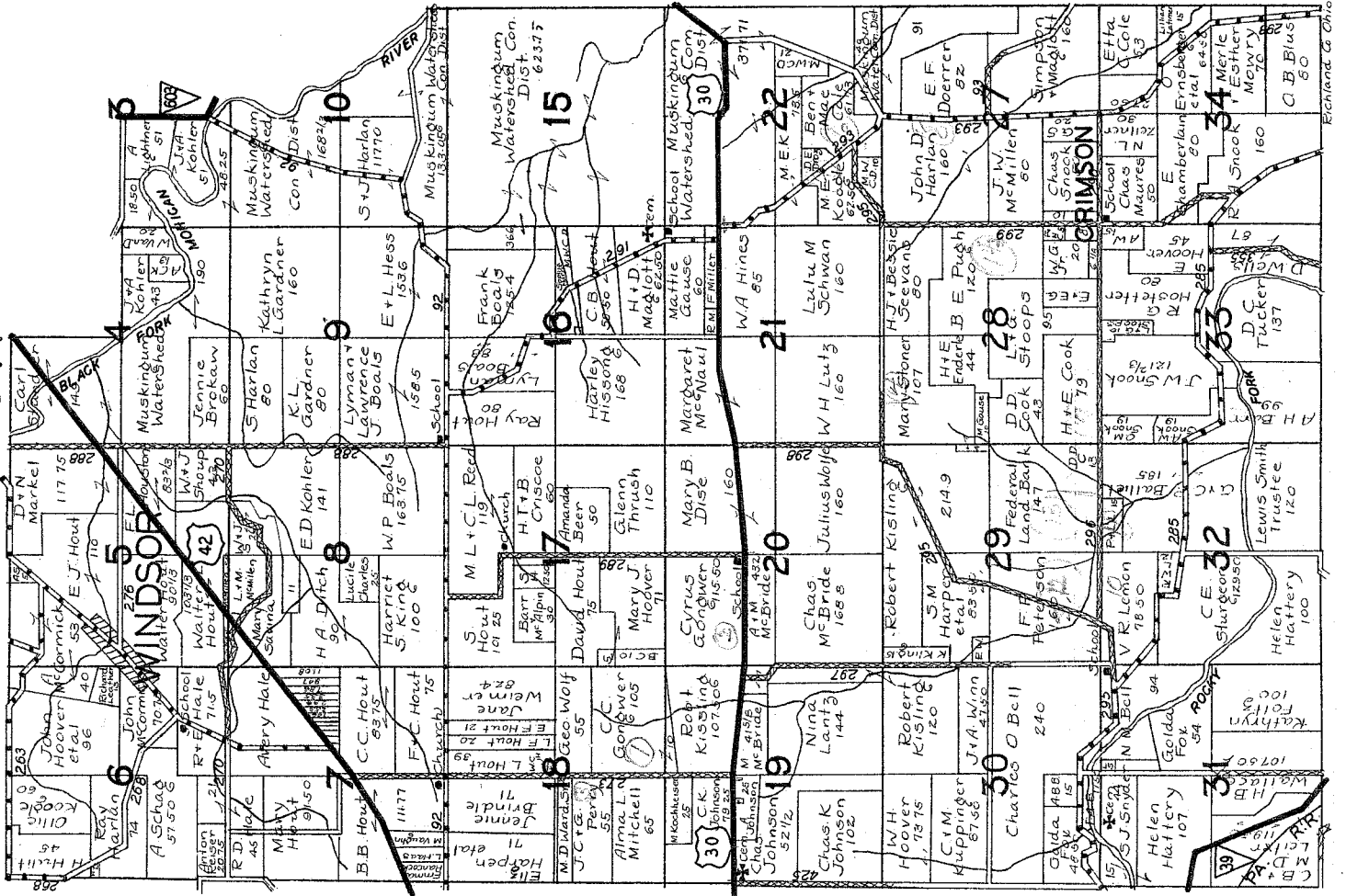

Richland Co Ohio

MONROE

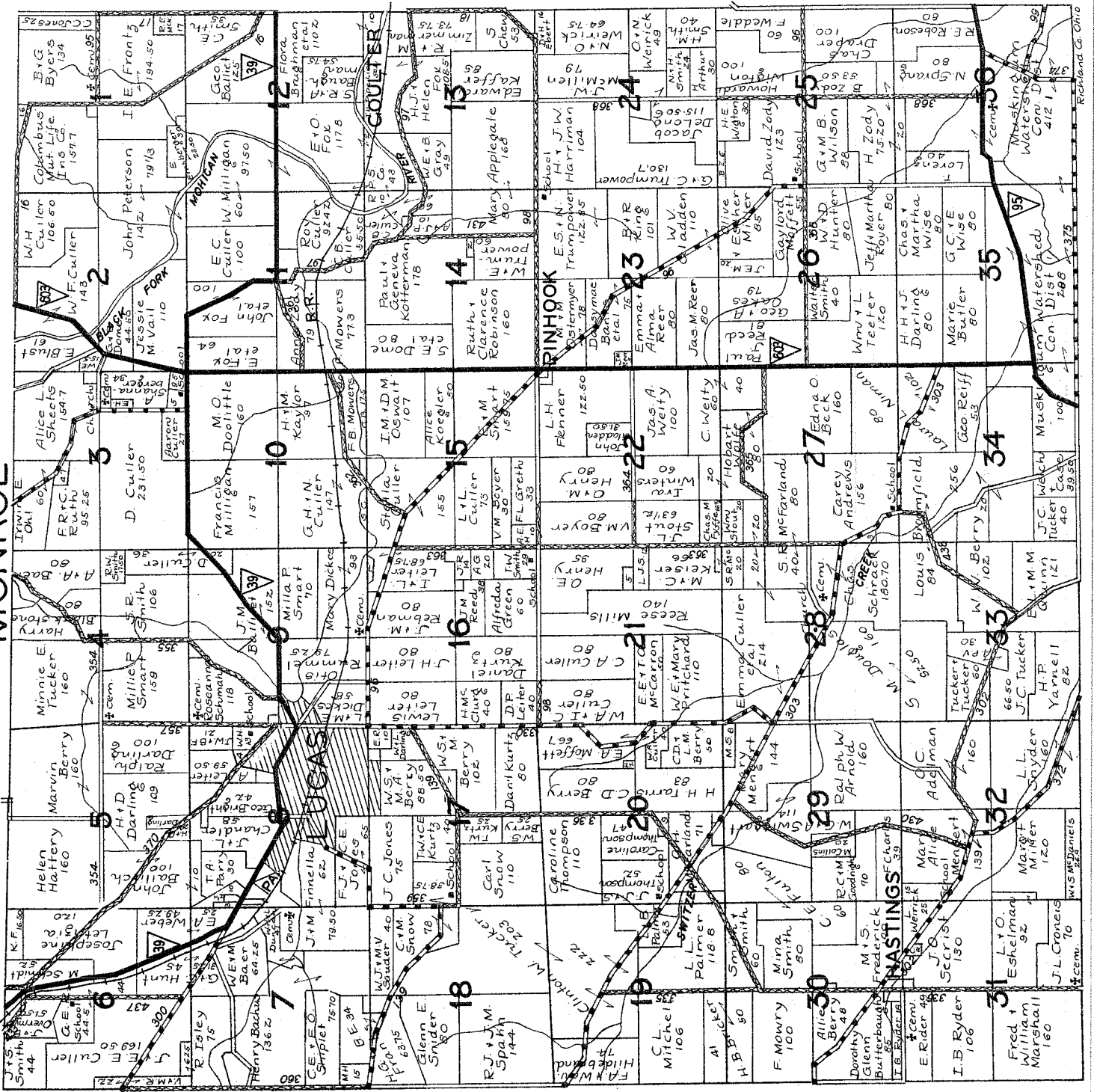

PERRY

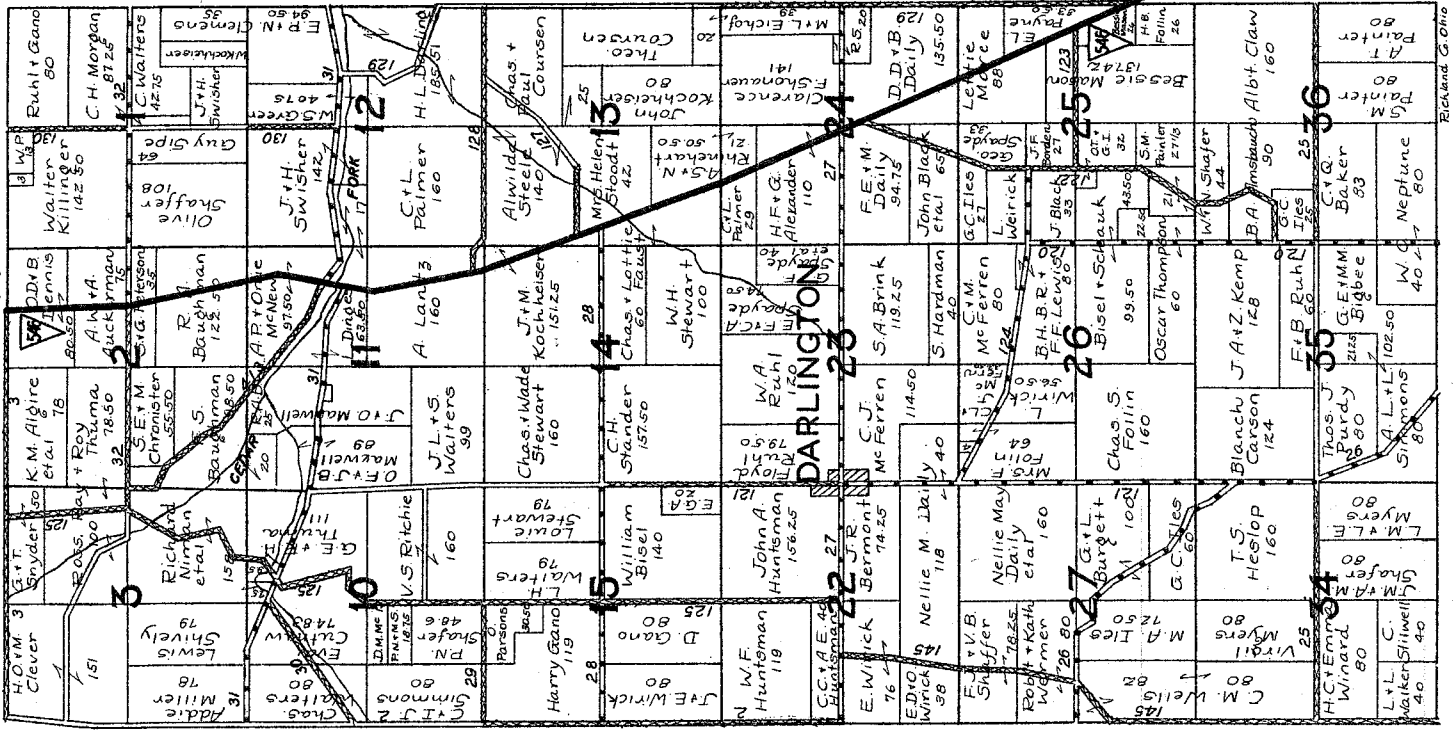

Pickland Co. Ohio

PLYMOUTH

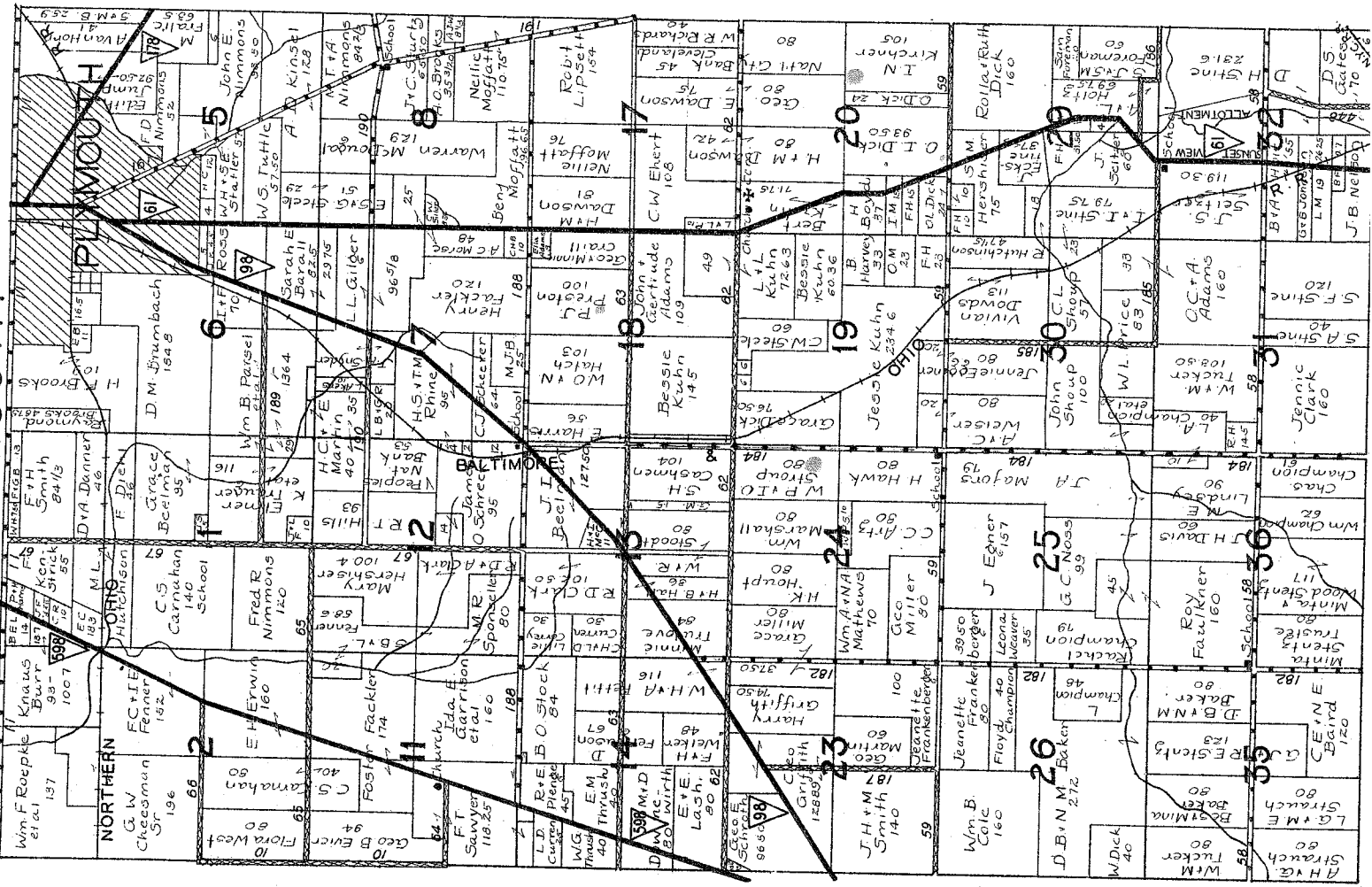

SANDUSKY

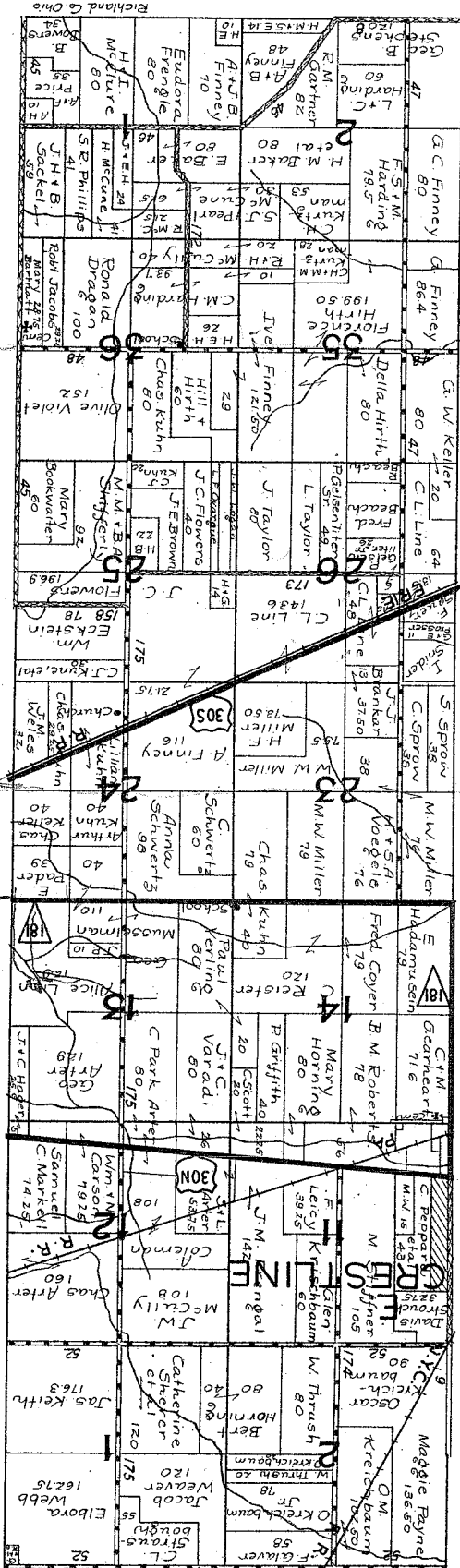

Richard C. Ohio

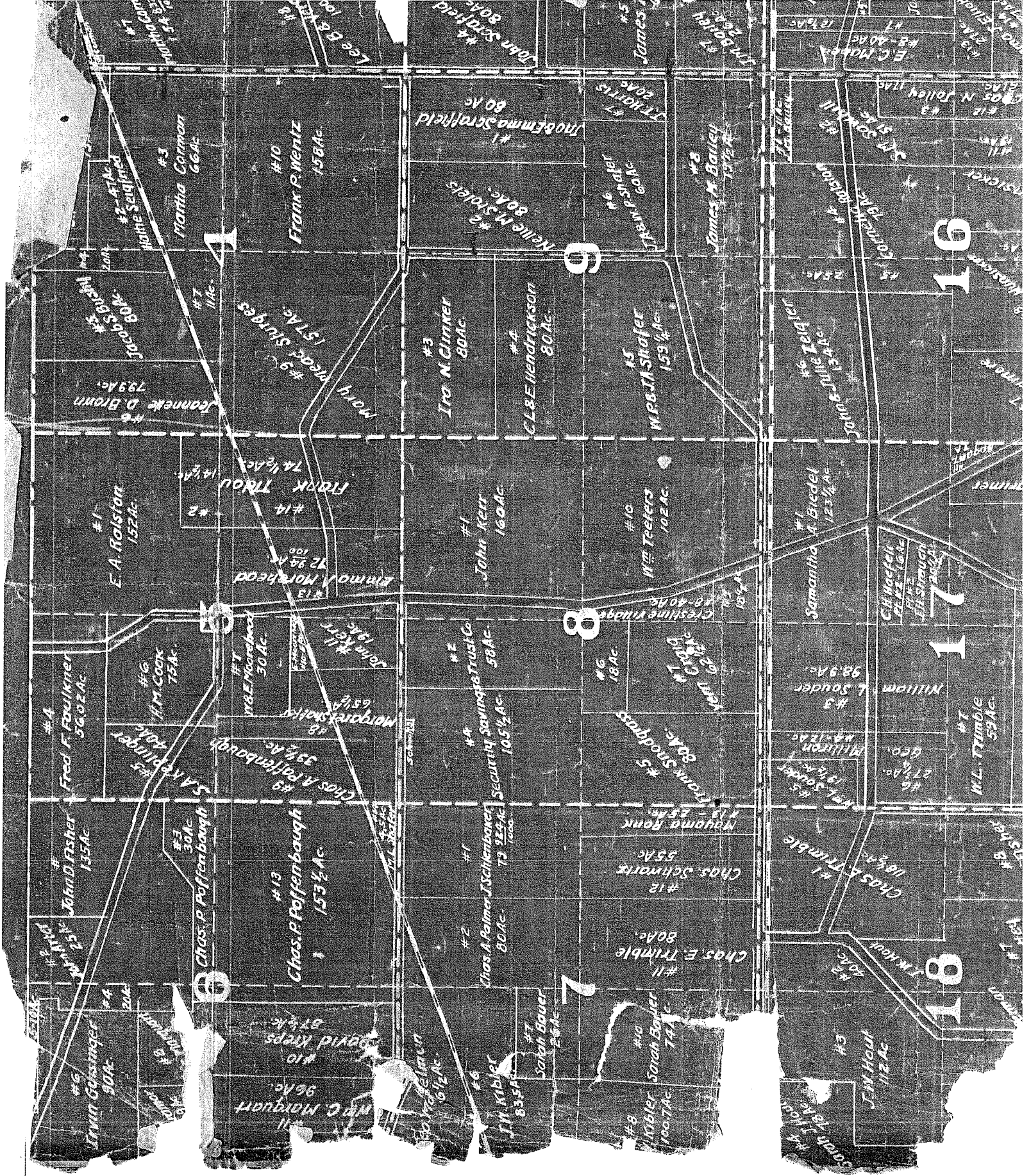

16

17

18

#10 Frank P. Wentz 156Ac.
#3 Martha Cowman 66Ac.
#7 11Ac.
#9 Mary Reed Surges 57Ac.
#6 Jeannette D. Brown 79.9Ac.
#4 100.6 Ac. S. Burchell
#2 79.9Ac.

#14 FRANK THOU 74 1/2 Ac.
#13 E.A. Rolston 152Ac.
#12 72.94 Ac.
#11 74 1/2 Ac.

#10 John Keer 160Ac.
#9 W.P. Peters 102Ac.
#8 18 Ac.
#7 18 Ac.
#6 18 Ac.

#13 Chas. P. Poffenbaugh 153 1/2 Ac.
#12 Chas. P. Poffenbaugh 30Ac.
#11 30Ac.
#10 30Ac.
#9 30Ac.
#8 30Ac.
#7 30Ac.
#6 30Ac.
#5 30Ac.
#4 30Ac.
#3 30Ac.
#2 30Ac.

#11 Chas. E. Trimble 80Ac.
#10 Chas. Schmitt 55Ac.
#9 55Ac.
#8 55Ac.
#7 55Ac.
#6 55Ac.
#5 55Ac.
#4 55Ac.
#3 55Ac.
#2 55Ac.
#1 55Ac.

#10 M.C. Morgant 96Ac.
#9 96Ac.
#8 96Ac.
#7 96Ac.
#6 96Ac.
#5 96Ac.
#4 96Ac.
#3 96Ac.
#2 96Ac.
#1 96Ac.

#10 Nellie M. Stoltz 80Ac.
#9 80Ac.
#8 80Ac.
#7 80Ac.
#6 80Ac.
#5 80Ac.

#10 John Keer 160Ac.
#9 W.P. Peters 102Ac.
#8 18 Ac.
#7 18 Ac.
#6 18 Ac.

#11 Chas. E. Trimble 80Ac.
#10 Chas. Schmitt 55Ac.
#9 55Ac.
#8 55Ac.
#7 55Ac.
#6 55Ac.
#5 55Ac.
#4 55Ac.
#3 55Ac.
#2 55Ac.
#1 55Ac.

#11 Chas. E. Trimble 80Ac.
#10 Chas. Schmitt 55Ac.
#9 55Ac.
#8 55Ac.
#7 55Ac.
#6 55Ac.
#5 55Ac.
#4 55Ac.
#3 55Ac.
#2 55Ac.
#1 55Ac.

#11 Chas. E. Trimble 80Ac.
#10 Chas. Schmitt 55Ac.
#9 55Ac.
#8 55Ac.
#7 55Ac.
#6 55Ac.
#5 55Ac.
#4 55Ac.
#3 55Ac.
#2 55Ac.
#1 55Ac.

#11 Chas. E. Trimble 80Ac.
#10 Chas. Schmitt 55Ac.
#9 55Ac.
#8 55Ac.
#7 55Ac.
#6 55Ac.
#5 55Ac.
#4 55Ac.
#3 55Ac.
#2 55Ac.
#1 55Ac.

#10 Nellie M. Stoltz 80Ac.
#9 80Ac.
#8 80Ac.
#7 80Ac.
#6 80Ac.
#5 80Ac.

#10 John Keer 160Ac.
#9 W.P. Peters 102Ac.
#8 18 Ac.
#7 18 Ac.
#6 18 Ac.

#11 Chas. E. Trimble 80Ac.
#10 Chas. Schmitt 55Ac.
#9 55Ac.
#8 55Ac.
#7 55Ac.
#6 55Ac.
#5 55Ac.
#4 55Ac.
#3 55Ac.
#2 55Ac.
#1 55Ac.

#11 Chas. E. Trimble 80Ac.
#10 Chas. Schmitt 55Ac.
#9 55Ac.
#8 55Ac.
#7 55Ac.
#6 55Ac.
#5 55Ac.
#4 55Ac.
#3 55Ac.
#2 55Ac.
#1 55Ac.

#11 Chas. E. Trimble 80Ac.
#10 Chas. Schmitt 55Ac.
#9 55Ac.
#8 55Ac.
#7 55Ac.
#6 55Ac.
#5 55Ac.
#4 55Ac.
#3 55Ac.
#2 55Ac.
#1 55Ac.

#11 Chas. E. Trimble 80Ac.
#10 Chas. Schmitt 55Ac.
#9 55Ac.
#8 55Ac.
#7 55Ac.
#6 55Ac.
#5 55Ac.
#4 55Ac.
#3 55Ac.
#2 55Ac.
#1 55Ac.

#10 Nellie M. Stoltz 80Ac.
#9 80Ac.
#8 80Ac.
#7 80Ac.
#6 80Ac.
#5 80Ac.

#10 John Keer 160Ac.
#9 W.P. Peters 102Ac.
#8 18 Ac.
#7 18 Ac.
#6 18 Ac.

#11 Chas. E. Trimble 80Ac.
#10 Chas. Schmitt 55Ac.
#9 55Ac.
#8 55Ac.
#7 55Ac.
#6 55Ac.
#5 55Ac.
#4 55Ac.
#3 55Ac.
#2 55Ac.
#1 55Ac.

#11 Chas. E. Trimble 80Ac.
#10 Chas. Schmitt 55Ac.
#9 55Ac.
#8 55Ac.
#7 55Ac.
#6 55Ac.
#5 55Ac.
#4 55Ac.
#3 55Ac.
#2 55Ac.
#1 55Ac.

#11 Chas. E. Trimble 80Ac.
#10 Chas. Schmitt 55Ac.
#9 55Ac.
#8 55Ac.
#7 55Ac.
#6 55Ac.
#5 55Ac.
#4 55Ac.
#3 55Ac.
#2 55Ac.
#1 55Ac.

#11 Chas. E. Trimble 80Ac.
#10 Chas. Schmitt 55Ac.
#9 55Ac.
#8 55Ac.
#7 55Ac.
#6 55Ac.
#5 55Ac.
#4 55Ac.
#3 55Ac.
#2 55Ac.
#1 55Ac.

SHARON

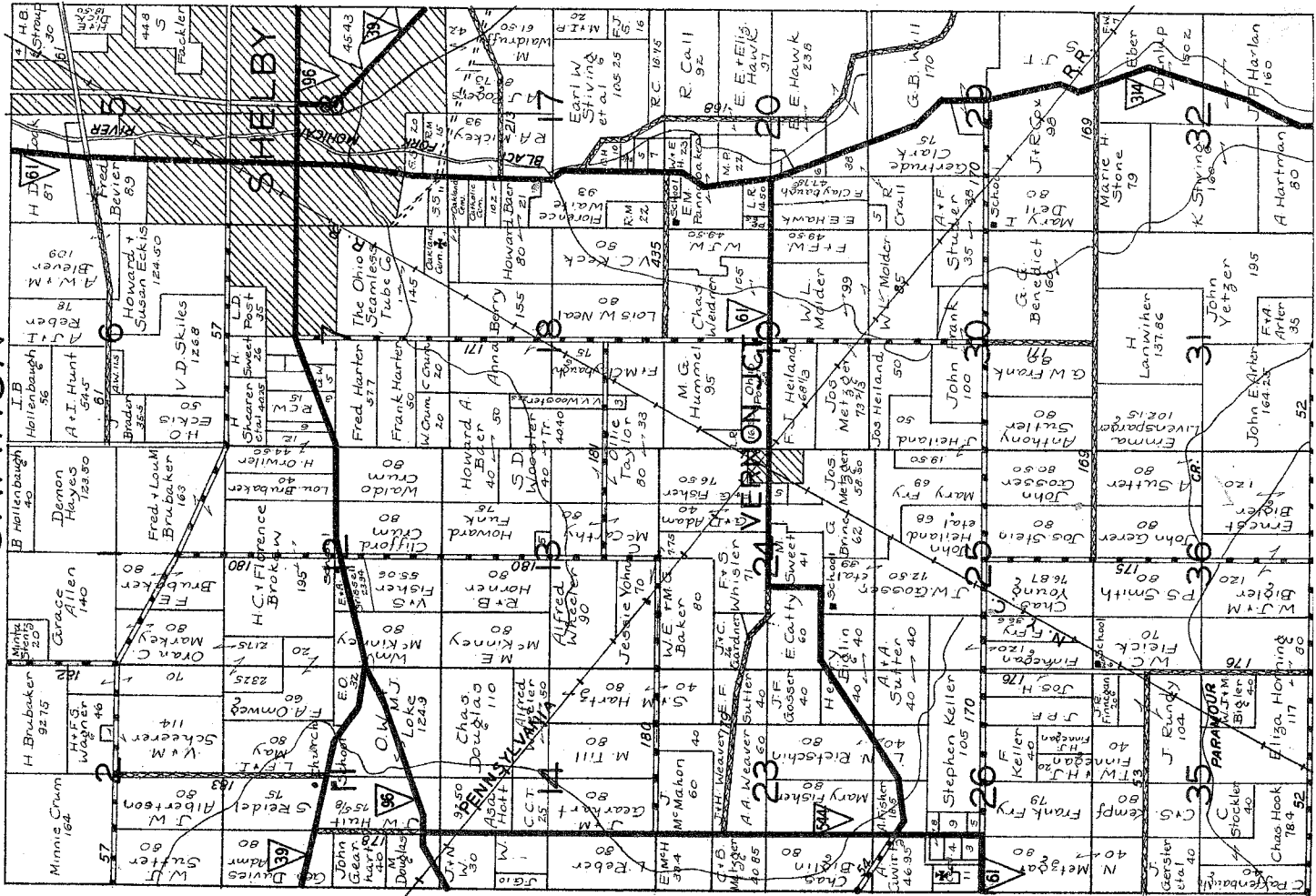

TROY

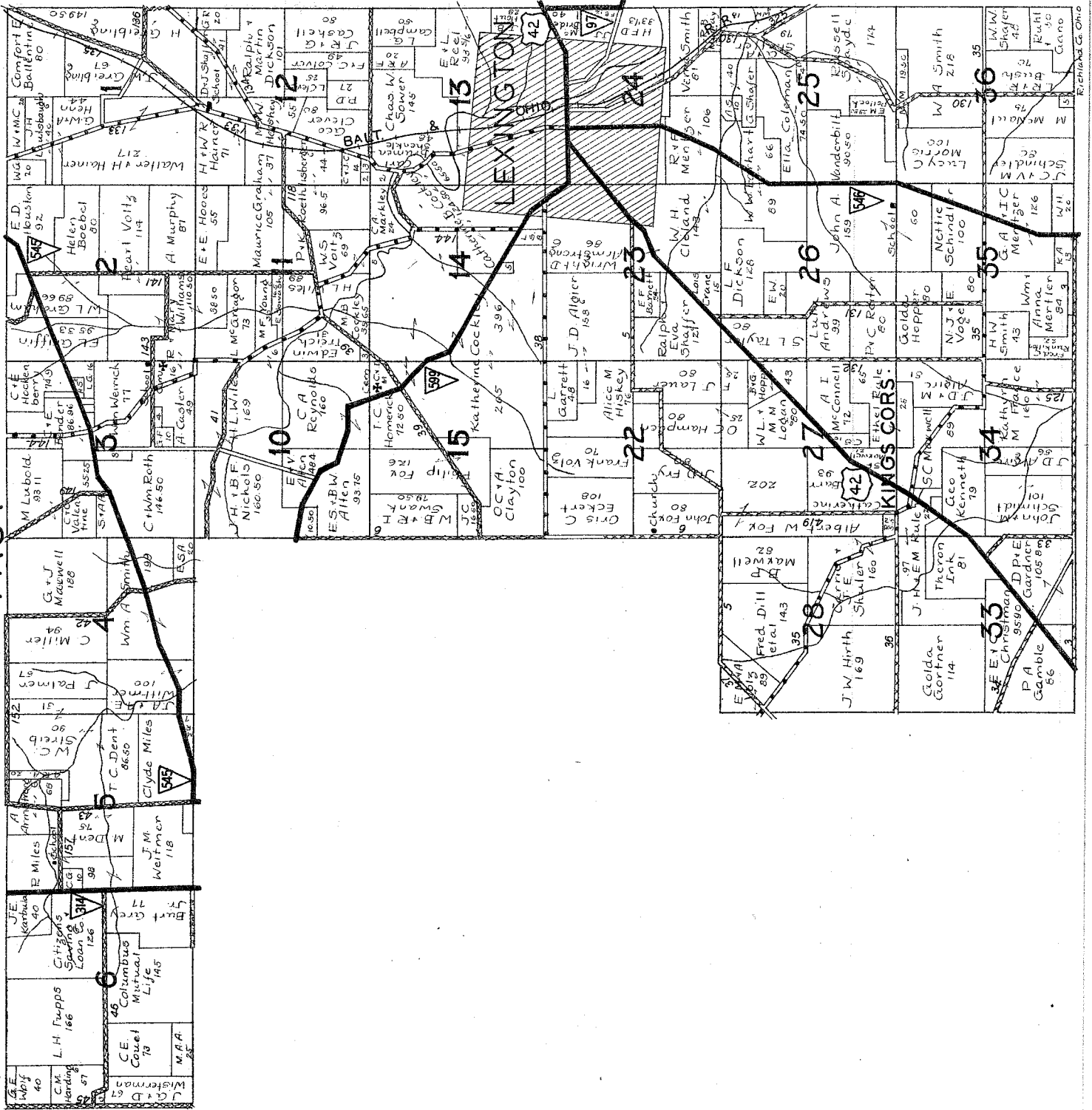

WORTHINGTON

