

PLAT OF BOUNDARY SURVEY
WALKER BROTHERS LEXINGTON, LLC.
 PART OF THE SOUTHWEST QUARTER, SECTION THIRTY-THREE (33)
 TOWNSHIP TWENTY (20), RANGE NINETEEN (19)
 TROY TOWNSHIP, RICHLAND COUNTY, OHIO

POINT OF COMMENCEMENT

POINT OF BEGINNING PARCEL 1

POINT OF BEGINNING PARCEL 2

CROFT ROAD (T.R. 54)
 (MORROW COUNTY)

GRUBB ROAD (T.H. 34)
 (RICHLAND COUNTY)

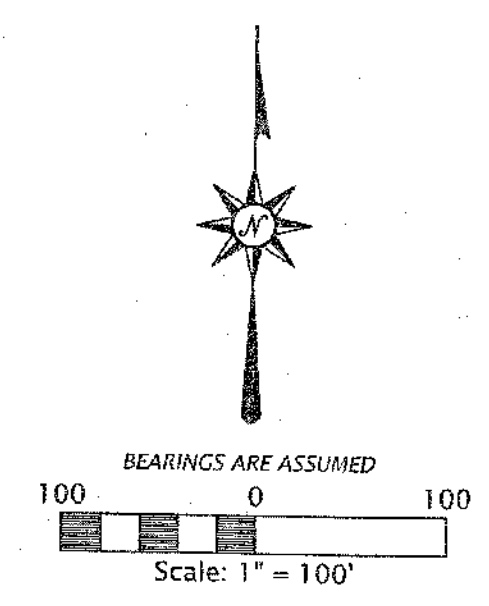

LEGEND

- ✕ RAILROAD SPIKE FOUND
- △ IRON PIN FOUND
- IRON PIPE FOUND
- STONE FOUND
- ✖ RAILROAD SPIKE SET
- 5/8" DIAMETER, 30" LONG IRON PIN SET WITH CAP STAMPED "KROCKA & ASSOC."

TROY TOWNSHIP ZONING APPROVAL DATE: 5/13/16

NEW SPLIT RICHLAND COUNTY TAX MAP OFFICE EAK 5-25-16 INITIAL DATE	NEW SURVEY OF EXISTING PARCEL RICHLAND COUNTY TAX MAP OFFICE EAK 5-25-16 INITIAL DATE
F4-223	

PREPARED BY
F.E. KROCKA & ASSOCIATES, INC.
 44 EAST MAIN STREET
 SHELBY, OHIO 44875
 (419) 342-4556

I CERTIFY THIS SURVEY WAS PREPARED FROM ACTUAL FIELD MEASUREMENTS IN ACCORDANCE WITH CHAPTER 4733-37 OF THE OHIO ADMINISTRATIVE CODE AND THAT ALL MONUMENTS WERE FOUND OR SET AS INDICATED.

Nathan W. Sautter
 NATHAN W. SAUTTER
 OHIO REGISTERED SURVEYOR NO. 8252
 DATE: MAY 2, 2016



WALKER BROTHERS LEXINGTON, LLC.
 ORV 2445/089
PARCEL 1
 9.660 ACRES

WALKER BROTHERS LEXINGTON, LLC.
 ORV 2445/089
PARCEL 2
 10.451 ACRES

L.G. MELLOTT TRUST
 ORV 979/412
 60.85 ACRES

RICHLAND COUNTY REFERENCE MATERIALS

- DEEDS AS SHOWN
- TAX MAPS
- THE FOLLOWING RICHLAND COUNTY SURVEYS FOUND AT THE RICHLAND COUNTY TAX MAP OFFICE:
 - F-2-9
 - F-3-139
 - 1978 - 20 ACRE SURVEY BY W. POULSON
 - W.E. ROGERS SURVEY DATED DECEMBER 8, 1915
 - C.E. ROLLINS SURVEY DATED MARCH 15, 1971
 - TROY TOWNSHIP - SOUTHWEST QUARTER, SECTION 31 SURVEY DATED NOVEMBER 28, 1840

MORROW COUNTY REFERENCE MATERIALS

- DEEDS AS SHOWN
- TAX MAPS
- THE FOLLOWING MORROW COUNTY SURVEYS FOUND AT THE MORROW COUNTY ENGINEER'S OFFICE:

VOLUME	PAGE
4	246
4	449
5	434
11	509
20	28A
27	33A
27	382