

**GIBSON AVENUE**  
60' Right Of Way

**BOUNDARY SURVEY**  
for  
**118 WOLFE AVENUE**

Known as being part of Lot Number 6530, as recorded in Volume 9, Page 3 of the Richland County Plat Records, now situated in the

**CITY OF MANSFIELD**  
**COUNTY OF RICHLAND - STATE OF OHIO**

by  
**McSTEEN & ASSOCIATES, INC.**  
ENGINEERS & SURVEYORS  
1415 East 286th Street  
Wickliffe, Ohio 44092  
(440) 585-9800

This survey is a boundary survey prepared in accordance with Chapter 4733-37, Ohio Administrative Code. The basis of bearings for this survey is N 90°-00'-00" W as the northerly line of Wolfe Avenue, as evidenced by monuments found, and is an assumed bearing. Distances are given in feet and decimal parts thereof. All iron pins shown as set are 30" long, 5/8" rebar with an identification cap stamped "McSTEEN-7104".

**SURVEY MONUMENTATION**

- denotes iron pin found as noted
- denotes iron pipe found as noted
- ⊙ denotes 5/8" diameter x 30" long iron pin with "McSTEEN 7104" ID cap set
- ✕ denotes "X" cut cross in stone set

5/8" REBAR W/  
ILLEGIBLE ID CAP  
FOUND & USED

132.50' REC.  
132.56' CALC. & USED

15.01' CALC.

15' ALLEY

S90°00'00"E

44.00' DEED & USED  
ADJOINER'S  
WOOD FENCE  
ENCROACHES 1.3'±

1 STORY  
FRAME  
GARAGE

LOT 6530  
WELLS FARGO FINANCIAL OHIO 1, INC.  
O.R. 1978, Pg. 259  
0.134 AC

2 STORY  
BRICK DWELLING

1.00' Rec.

LOT 6529  
ROBERT L. AND THELMA  
STOCKWELL  
D.V. 905, Pg. 435

N 01°55'11" W 132.50' REC  
132.56' CALC. & USED

S 01°55'11" E 132.50' REC  
132.56' CALC. & USED

**GILBERT AVENUE**  
60' Right Of Way

**HARTER AVENUE**  
50' Right Of Way

Volume 9, Pg. 3 of  
the Richland County  
Plat Records

315.00' REC. - 314.85' OBS.

1 1/2" PIPE  
FOUND & USED

1" PIPE FOUND ON  
LINE (N. EDGE)

586.00' REC. & USED

1" PIPE FOUND & USED  
FOR LINE - 0.29' W

630.00' REC. & USED

N90°00'00"W (USED AS BASIS OF BEARINGS)

**WOLFE AVENUE**  
60' Right Of Way

*Robert A. Dörner* 8/16/2010  
ROBERT A. DORNER REG. PROF. SURV. No. 6943  
Job No.: 10-121  
Site No.: 2808

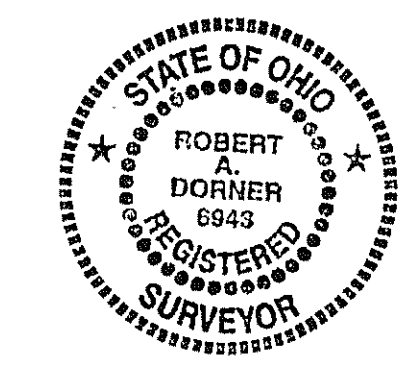

Field Date: July 7, 2010  
Survey Date: July 28, 2010

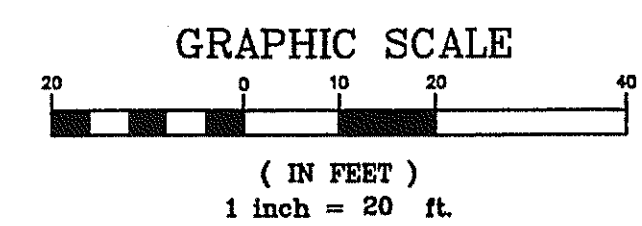

NEW SURVEY  
OF EXISTING PARCEL  
RICHLAND COUNTY  
TAX MAP OFFICE  
EAK 8-16-10  
INITIAL DATE  
F-4-119