

PART OF THE SW. 1/4 SEC. 17
 PART OF THE NE. 1/4 SEC. 19,
 PART OF THE NW. 1/4 OF SEC. 20,
 TOWNSHIP-21, RANGE-17,
 VILLAGE OF BUTLER
 RICHLAND COUNTY, OHIO

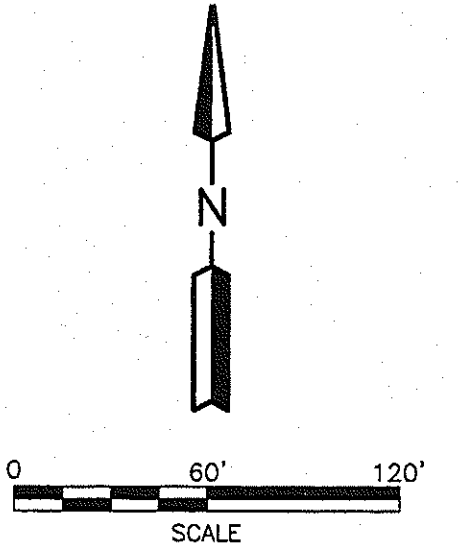

DESCRIPTION

SITUATED IN THE VILLAGE OF BUTLER, COUNTY OF RICHLAND, STATE OF OHIO AND BEING A PART OF THE SOUTHWEST QUARTER OF SECTION 17, A PART OF THE NORTHEAST QUARTER OF SECTION 19, AND A PART OF THE NORTHWEST QUARTER OF SECTION 20, OF TOWNSHIP 21 NORTH, RANGE 17 WEST AND BEING MORE PARTICULARLY DESCRIBED AS FOLLOWS:

BEGINNING FOR THE SAME AT AN IRON PIN FOUND AND ACCEPTED AS MARKING THE SOUTHWEST CORNER OF LOT NUMBER 672 OF THE CONSECUTIVELY NUMBERED LOTS IN SAID VILLAGE;

THENCE, S 89° 22' 18" E, 60.35 FEET ALONG THE SOUTH LINE OF SAID LOT TO AN IRON PIN FOUND;

THENCE, S 00° 37' 42" W, 190.00 FEET TO AN IRON PIN FOUND ON THE NORTH LINE OF A PARCEL CURRENTLY OWNED BY THE CLEARFORK VALLEY LOCAL SCHOOL DISTRICT (DEED REFERENCE: VOLUME: 768, PAGE: 344);

THENCE, N 89° 24' 15" W, 407.82 FEET ALONG SAID NORTH LINE OF SAID LAND OF CLEARFORK VALLEY LOCAL SCHOOL DISTRICT AND ALONG THE NORTHERLY LINE OF A PARCEL OF LAND CONVEYED TO THE VILLAGE OF BUTLER BY OFFICIAL RECORD VOLUME 131, PAGE 84 TO AN IRON PIN FOUND ON THE WEST LINE OF SAID NORTHWEST QUARTER OF SECTION 20, THE SAME ALSO BEING ON THE EAST LINE OF SAID NORTHEAST QUARTER OF SECTION 19;

THENCE, N 89° 25' 51" W, 466.69 FEET ALONG THE NORTH LINE OF SAID VILLAGE OF BUTLER PARCEL AND THE NORTH LINE OF LANDS CONVEYED TO AMY JO WEEKLEY, TRUSTEE BY OFFICIAL RECORD VOLUME 1107, PAGE 760 TO AN IRON PIN SET;

THENCE, N 00° 24' 27" E, 151.87 FEET TO AN IRON PIN SET;

THENCE, N 89° 35' 33" W, 28.57 FEET TO AN IRON PIN SET;

THENCE, N 00° 24' 27" E, 210.00 FEET TO AN IRON PIN SET;

THENCE, S 89° 35' 33" E, 380.00 FEET TO AN IRON PIN SET;

THENCE, N 00° 24' 27" E, 142.85 FEET TO AN IRON PIN SET ON A CURVE;

THENCE, ALONG A CURVE TO THE LEFT WITH A RADIUS OF 260.00 FEET, A DELTA ANGLE OF 13° 27' 53", AN ARC LENGTH OF 61.10 FEET, A CHORD BEARING OF N 82° 51' 37" W, AND A CHORD DISTANCE OF 60.96 FEET, TO AN IRON PIN SET MARKING THE POINT OF TANGENCY;

THENCE, N 89° 35' 33" W, 34.46 FEET TO AN IRON PIN SET;

THENCE, N 00° 24' 27" E, 60.00 FEET TO AN IRON PIN SET;

THENCE, S 89° 35' 33" E, 34.46 FEET TO AN IRON PIN SET MARKING A POINT OF CURVE;

THENCE, ALONG A CURVE TO THE RIGHT WITH A RADIUS OF 320.00 FEET, A DELTA ANGLE OF 01° 40' 37", AN ARC LENGTH OF 9.37 FEET, A CHORD BEARING OF S 88° 45' 15" E, AND A CHORD DISTANCE OF 9.37 FEET TO AN IRON PIN SET;

THENCE, N 03° 52' 31" E, 150.66 FEET TO AN IRON PIN SET ON THE NORTH LINE OF SAID NORTHEAST QUARTER;

THENCE, S 89° 30' 10" E, 157.75 FEET TO AN IRON PIN FOUND IN THE SOUTHWEST CORNER OF SAID NORTHEAST QUARTER, SAID IRON PIN ALSO BEING IN THE SOUTHWEST CORNER OF SAID SOUTHWEST QUARTER OF SECTION 17;

THENCE N 00° 32' 26" E, 250.58 FEET ALONG THE WEST LINE OF SAID SOUTHWEST QUARTER TO AN IRON PIN FOUND IN THE SOUTHWEST CORNER OF A PARCEL OF LAND CONVEYED TO SANDRA L. COCHRAN BY OFFICIAL RECORDS VOLUME 1904, PAGE 765

S 86° 41' 18" E, 72.57 FEET ALONG THE SOUTH LINE OF SAID LAND OF SANDRA L. COCHRAN TO AN IRON PIN FOUND IN THE SOUTHEASTERLY CORNER OF SAID LAND, SAID IRON PIN ALSO BEING IN WESTERLY LINE OF REEDER SUBDIVISION NUMBER 3 (PLAT REFERENCE: VOLUME: 23, PAGE: 38);

THENCE S 30° 04' 42" W, 13.66 FEET ALONG SAID WESTERLY LINE OF SAID REEDER SUBDIVISION NUMBER 3 TO AN IRON PIN FOUND;

THENCE S 19° 41' 18" E, 253.69 FEET AND CONTINUING ALONG SAID WESTERLY LINE OF SAID REEDER SUBDIVISION TO AN IRON PIN SET IN THE SOUTHWEST CORNER OF SAID SOUTHWEST QUARTER;

THENCE, S 19° 41' 18" E, 565.51 FEET ALONG SAID WESTERLY LINE OF SAID REEDER SUBDIVISION NUMBER 3 TO THE PLACE OF BEGINNING, CONTAINING 10.728 ACRES, MORE OR LESS, OF WHICH 0.616 ACRE IS LOCATED WITHIN THE SOUTHWEST QUARTER OF SECTION 17, 5.273 ACRES ARE LOCATED WITHIN THE NORTHEAST QUARTER OF SECTION 19 AND 4.839 ACRES ARE LOCATED WITHIN THE NORTHWEST QUARTER OF SECTION 20 AND SUBJECT TO ALL LEGAL HIGHWAYS AND EASEMENTS OF RECORD.

BEARINGS ARE TO AN ASSUMED MERIDIAN AND ARE USED TO EXPRESS ANGLES ONLY.

ALL IRON PINS SET ARE 5/8" DIAMETER REINFORCING ROD WITH PLASTIC CAP STAMPED "CLANCY 7178".

ACCORDING TO A SURVEY MADE IN APRIL 2006, BY ROGER L. STEVENS, OHIO REGISTERED SURVEYOR NO. 7052 FOR SHAFFER, JOHNSTON, LICHTENWALTER & ASSOCIATE, INC.

Distances shown hereon are expressed in feet and decimal parts thereof.
 Basis of Bearings: Bearings are to an assumed meridian and are used to express angles only.

PLAT-CERTIFICATION OF SURVEYOR

I DO HEREBY CERTIFY THAT I HAVE SURVEYED THE BOUNDARY OF THE PREMISES AND PREPARED THE WITHIN PLAT AND THAT SAID PLAT IS CORRECT; ALL OF MY WORK CONTAINED HEREIN WAS CONDUCTED IN ACCORDANCE WITH OHIO ADMINISTRATIVE CODE 4733-37 COMMONLY KNOWN AS "A MINIMUM STANDARDS FOR BOUNDARY SURVEYS IN THE STATE OF OHIO. THE WORDS I AND MY AS USED HEREIN ARE TO MEAN THAT EITHER MYSELF OR SOMEONE WORKING UNDER MY DIRECT SUPERVISION.

Roger L. Stevens DATE 4/28/08
 ROGER L. STEVENS
 SURVEYOR NO. 7052

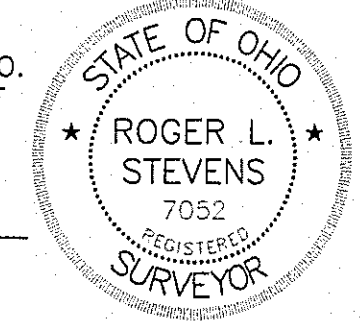

Deby Dingo Village of Butler 4-28-08
 Zoning Inspector

MONUMENTATION-CERTIFICATION OF SURVEYOR

I DO HEREBY CERTIFY THAT I HAVE SURVEYED THE PREMISES AND THAT ALL REQUIRED SURVEY MONUMENTS SHOWN HEREIN HAVE BEEN PROPERLY PLACED. ALL OF MY WORK CONTAINED HEREIN WAS CONDUCTED IN ACCORDANCE WITH OHIO ADMINISTRATIVE CODE 4733-37 COMMONLY KNOWN AS "A MINIMUM STANDARDS FOR BOUNDARY SURVEYS IN THE STATE OF OHIO. THE WORDS I AND MY AS USED HEREIN ARE TO MEAN THAT EITHER MYSELF OR SOMEONE WORKING UNDER MY DIRECT SUPERVISION.

Warne R. Clancy DATE 4/28/08
 WARNE R. CLANCY
 SURVEYOR NO. 7178

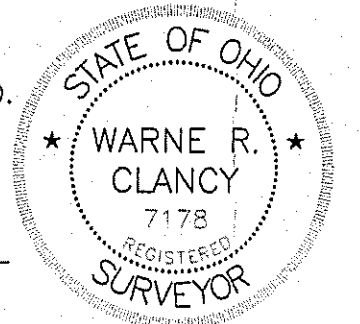

REVISION NO.	DATE	<p>SHAFFER, JOHNSTON, LICHTENWALTER & ASSOCIATES, INC. Consulting Engineers & Surveyors 909 South Main Street, P.O. Box 3598 Mansfield, Ohio 44907 TEL: 419-756-7302 FAX: 419-756-0867 EMAIL: sj@sj-inc.com</p>
<p>SURVEY FOR</p> <p>BRAD RANSHAW DONALD RANSHAW & PATRICIAL RANSHAW</p>		<p>DRAWN S. LEE</p> <p>CHECKED R.S.</p> <p>SCALE 1" = 60'</p> <p>DATE 4/28/2008</p> <p>DWG NO: EM-1531S_3 JOB NO: EM-1531 SHEET 1 OF 1</p>

- LEGEND
- IRON PIN FOUND
 - IRON PIN SET, 5/8" DIA. ROD WITH PLASTIC CAP STAMPED "CLANCY 7178"

