

**SURVEY PLAT**  
 PT. SE & SW QTRS. OF SECTION 2  
 WASHINGTON TWP. (T. 20, R-18)  
 RICHLAND COUNTY, OHIO  
 FOR: J. A. HAMMETT  
 DEED REF.: VOL. 857 PG. 694

NOTE: POINTS LOCATED IN  
 R/W LINE NOT  
 ACCESSIBLE.

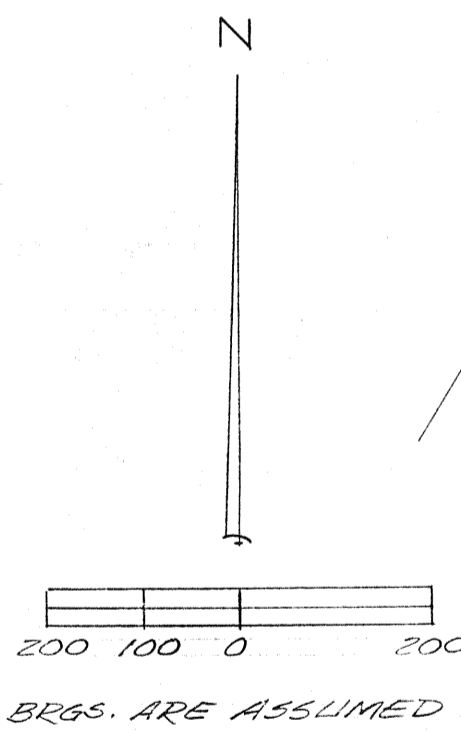

- 3/8" IRON PIN SET WITH CAP NO. 6252
- I.P. FOUND
- △ P.K. NAIL SET
- △ P.K. NAIL FOUND
- R.R. SPIKE FOUND

NEW SPLIT  
 RICHLAND COUNTY  
 TAX MAP OFFICE  
 INITIAL DATE  
 JH 8/9/01

NEW SURVEY  
 OF EXISTING PARCEL  
 RICHLAND COUNTY  
 TAX MAP OFFICE  
 INITIAL DATE  
 JH 8/9/01

*John W. Napier, Jr.*  
 JOHN W. NAPIER, JR.  
 REG. SURVEYOR NO. 6252

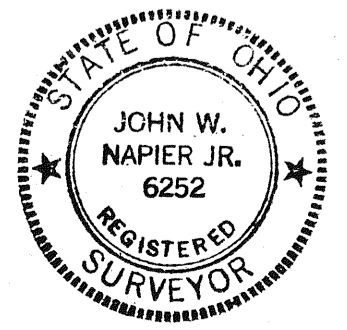

**APPROVED**  
 This is to certify that the attached survey  
 meets the 25' Road Frontage Requirement.  
*John W. Napier, Jr.* 8/6/2001  
 Zoning Inspector Washington Township DATE



① CAESAREA CHURCH OF  
 WASHINGTON TWP.  
 VOL. 492 PG. 103

SE CORNER  
 OF SECTION 2